



Installation & Operational Manual

Model D6518

Hydraulic European Cart Lifter



Perkins Manufacturing Company
Creators of the TuckAway® Cart Lifter
www.perkinsmfg.com

800-882-5292 Revised:2/22/2021

D6518 Specifications

Cart Compatibility	ANSI Type C Carts (European-type). Using an upper lip for lifting. Combo feature compatible only with 240 and 360 Litters capacity bins.
Typical Mounting Application	Sideloader
Tipper-Bar Compatible?	Yes.
Flow Rate Requirement	3.5 gpm
Cycle Time	6-8 seconds (up and down)
Recommended Pressure Setting*	1,650 psi at the pressure relief valve
Maximum System Pressure	3,000 PSI
Weight Capacity**	400 lbs
Dump Angle	60 degrees from the horizon
Mounting Height (ground level to top of mounting plate)	46 ½" up to 52"
Approximate Unit Weight (not counting packaging)	200 lbs
Hydraulic Package	Tap-In kits are sold separately
Warranty	1-year ***

Perkins regularly makes product improvements. Specifications are subject to change without notice.

* Actual pressure required to lift a load can vary.

** Do not lift more than the recommended amount printed on the cart by the cart manufacturer or damage or injury may result.

*** See Warranty page enclosed in this manual for full details of coverage



Perkins Manufacturing Company
 Creators of the TuckAway® Cart Lifter
www.perkinsmfg.com

800-882-5292 Revised: 2/22/2021

Page 1

Envelope Dimensions

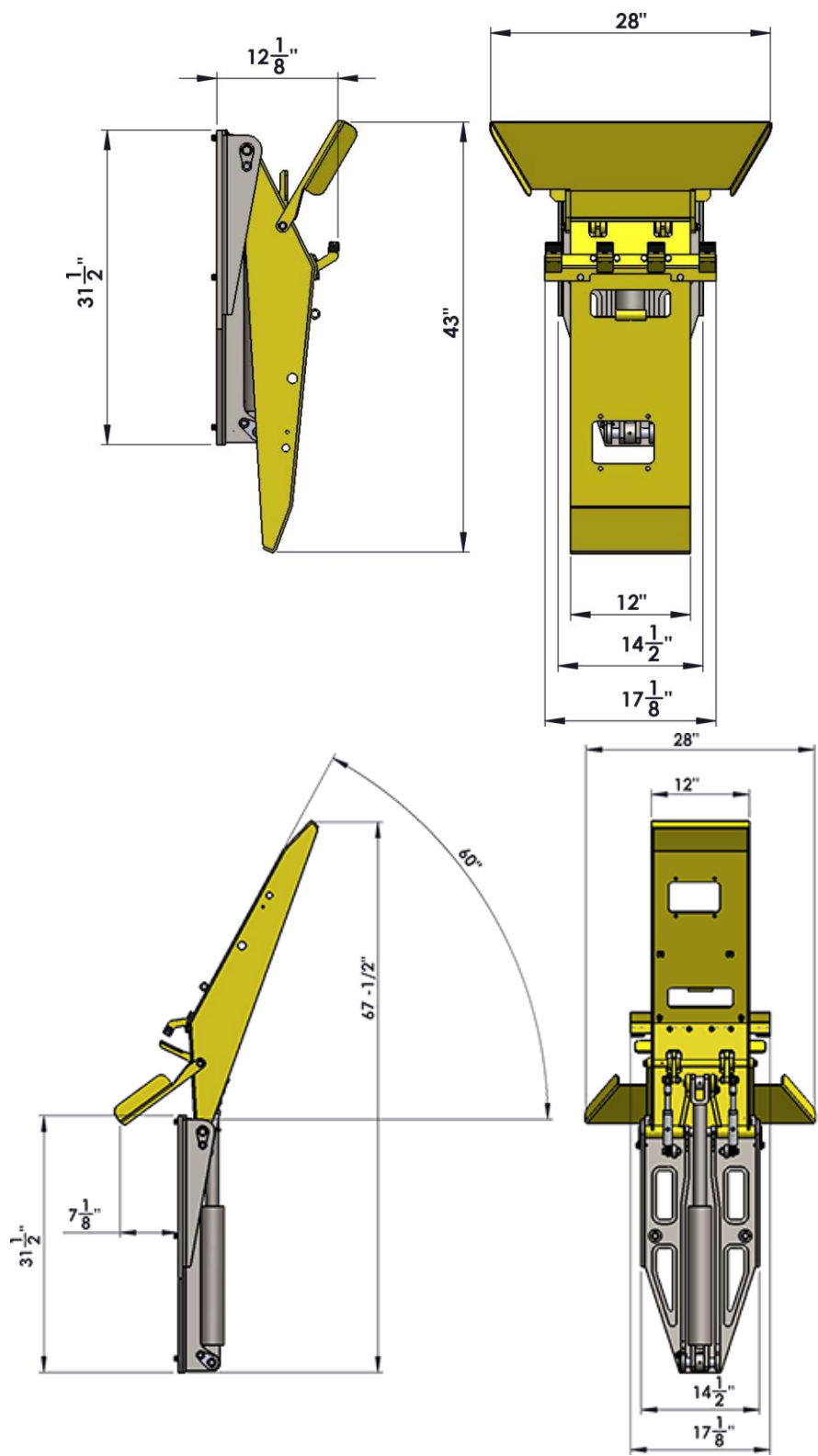

Perkins regularly makes product improvements. Dimensions are subject to change without notice.



Perkins Manufacturing Company
Creators of the TuckAway® Cart Lifter
www.perkinsmfg.com

800-882-5292 Revised:2/22/2021
Page 2

Mounting and Overall Dimensions

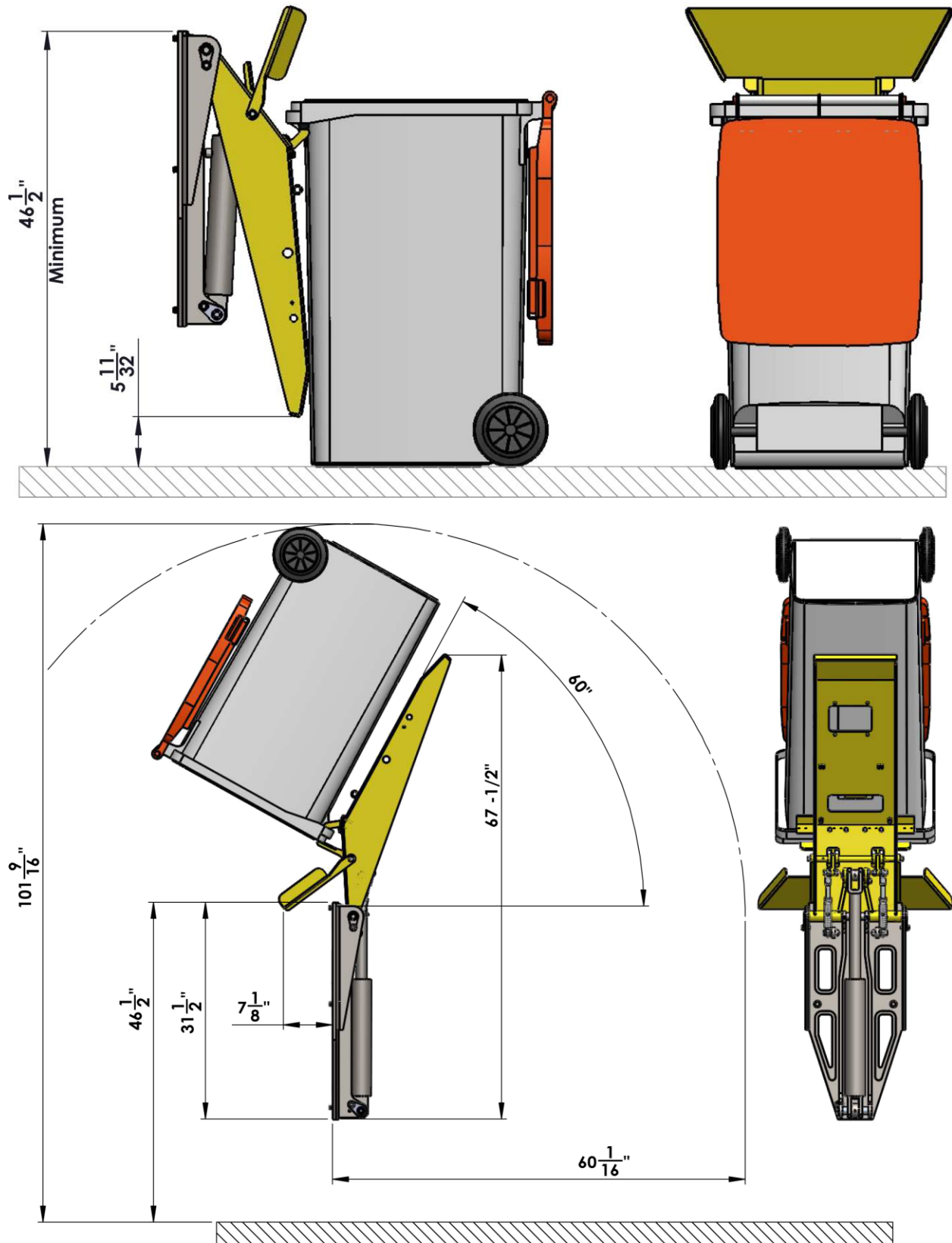

Perkins Manufacturing Company
 Creators of the TuckAway® Cart Lifter
www.perkinsmfg.com

800-882-5292

Revised: 2/22/2021

Page 3

Glossary of Terms

Cart Types



ANSI Type B carts (US-Style two-bar carts) with a dimension of 14 $\frac{3}{4}$ - 15 $\frac{1}{4}$ " bar to bar spacing.



ANSI Type C Carts (European-type) Using an upper lip for lifting. Height to ground varies with size of cart.



ANSI Type D Carts (Diamond-Type)



ANSI Type G Carts (Automated Collection) Having a rounded body ideal for gripper arms to clasp around.

Note: Some ANSI Type B carts are also Type G compatible, but some carts, particularly older designs, are not. This affects gripper-arm type of lifters that rely on grasping the cart around it's body. If using a gripper arm type of lifter, check your carts and see if they have rounded corners (look for approximately 6" radius). If so, they are likely ANSI Type G compatible.

Key Hydraulic Components



Diverter Valve



Hand Valve



PO Check Valve



50/50 Splitter



Double Diverter Valve



Adjustable Flow Control



Hydraulic Cylinder

Valves are sold separately or as part of a tap-in kit. The valves are shown for reference / identification purposes only. Your specific installation may require other equipment not shown.



Perkins Manufacturing Company
Creators of the TuckAway® Cart Lifter
www.perkinsmfg.com

800-882-5292

Revised:2/22/2021

Page 4

Installation Safety

Please read this manual prior to installing, repairing or using this cart lifter.

- ✧ Installation of this equipment requires welding, painting, grinding, torching and working with high- pressure hydraulic systems. The appropriate safety equipment should be used at all times.
- ✧ Always follow OSHA specified lock-out procedures while working with a truck.
- ✧ Cart lifters weigh, on average, between 185 to 300 lbs. Do not lift the lifter onto the mounting plate by hand. Always use proper lifting equipment.
- ✧ Always use a chain or strap to secure the lifter in the upright position during the installation process. Unsecured lifters may fall suddenly causing injury.
- ✧ The truck to which the lifter is to be installed should be empty of waste. Torching and welding can ignite the contents of the truck and cause a fire.
- ✧ Do not weld on the truck unless a ground is in place and the battery is disconnected.
- ✧ Do not open/loosen any hydraulic lines unless the system is off and depressurized.
- ✧ Always double-check hydraulic fittings and hoses for tightness prior to reactivating the pump.
- ✧ Always relocate lights that need to be moved due to the position of the cart lifter to a clear and unobstructed area clearly visible to drivers.
- ✧ All painting of the truck/lifter after installation is complete should be done with proper ventilation and per local regulations. Do not paint over caution and warning labels.
- ✧ If there are any questions about the proper installation or use of the cart lifter not covered in the manual, it is recommended to call Perkins at 800-882-5292.



Please be aware of the risks of working with welding equipment and consumables. Always use safety protection equipment. The sparks may ignite fire, always clean the area from flammable material or flammable chemicals, do not weld close to gas lines or on top of electrical cords or installations. Disconnect battery cables from the battery and make sure the vehicle is perfectly grounded prior to attempt to do any weld. Always weld in a ventilated area.



WHEN WELDING, WEAR APPROPRIATE EYE AND SKIN PROTECTION. WELDING LIGHT CAN BLIND. WELDING LIGHT CAN SUNBURN THE SKIN. LONG TERM EXPOSURE TO WELDING LIGHT CAN CAUSE CANCERS. ALWAYS WEAR PPE WHEN WELDING. PROPER PPE SHOULD ALSO BE WORN BY ANYONE IN THE THE WORK ZONE WHO MIGHT ALSO BE EXPOSED.



Correct and safe electric welding station

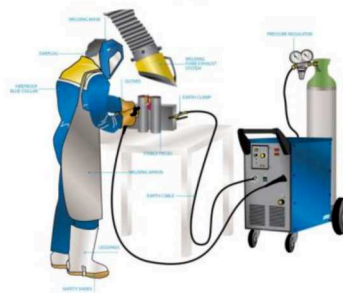

HYDRAULIC SYSTEMS CAN LEAK OUT HIGH PRESSURE WHICH CAN CAUSE SERIOUS INJURY, GANGRENE OR DEATH. DO NOT CHECK FOR LEAKS WITH YOUR BARE HANDS AND AVOID CONTACT WITH LEAKING OIL STREAMS.

HYDRAULIC OIL CAN ENTER THE BLOODSTREAM. SEEK MEDICAL ATTENTION IMMEDIATELY IF YOUR SKIN IS PUNCTURED BY HYDRAULIC OIL.

HYDRAULIC SYSTEMS CAN BECOME HOT (GENERALLY UP TO 170-180 DEG. F.) TO AVOID BURNS, DO NOT TOUCH VALVES, ACTUATORS, CYLINDERS, AND OTHER HOT COMPONENTS, EVEN AFTER THE SYSTEM IS SHUT OFF IT WILL REMAIN HOT AND TAKE TIME TO COOL DOWN.

ALWAYS TURN OFF A SYSTEM BEFORE SERVICING IT. DEPRESSURIZE THE CIRCUIT BY ACTIVATING THE CONTROLS WITH THE SYSTEM OFF TO RELIEVE ANY BUILT UP PRESSURE.

NEVER WORK UNDER A RAISED LOAD. RAISED EQUIPMENT CAN SUDDENLY FALL WHEN A VALVE OR LINE IS OPENED (LIKE A MOUSETRAP). IF THE EQUIPMENT MUST BE SERVICED IN THE RAISED POSITION, SECURE THE EQUIPMENT WITH CHAIN OR STRAP TO HOLD IT UP SAFETY.



Perkins Manufacturing Company
Creators of the TuckAway® Cart Lifter
www.perkinsmfg.com

800-882-5292 Revised: 8/10/2023

Page 11

Installation Tips

Do not mount the lifter to a refuse body which is not already mounted to a chassis. Chassis heights can vary, and this will affect the final installed height of the cart lifter.

Tack weld only until all positions and clearances are verified to work well for your application.

Always work on a smooth level surface with an empty truck.

The use of tools, power and mechanical, will be necessary. Please make sure you have all the necessary safety equipment to protect eyes and body from any harm, the mechanical tools to assembly the unit and the tools to service it.



Perkins Manufacturing Company
Creators of the TuckAway® Cart Lifter
www.perkinsmfg.com

800-882-5292

Revised:2/22/2021

Page 7

Determine the Mounting Height

The mounting height is critical to the proper function of any cart lifter. The ideal location for the European teeth is 35 ¼" off the ground. The mounting plate minimum mounting height is 46 ½" and a maximum of 52" for proper usage.

A cart lifter which has been positioned too low may kick carts away before successfully engaging them.

A cart lifter which is mounted too high will make it difficult for the operator to latch the cart at all, causing the operator to have to lift the cart onto the latch.

A good mounting height will make latching carts effortless with no lifting or holding the cart in place.

Following the mounting spec sheet in the previous pages, locate the mounting. The mounting plate may be positioned as low as 46 ½" and as high as 52", to obtain the distances to the hook or teeth as previously mentioned, as needed. The mounting plate itself should be vertical and level. Mounting should be fully back supported and welded.

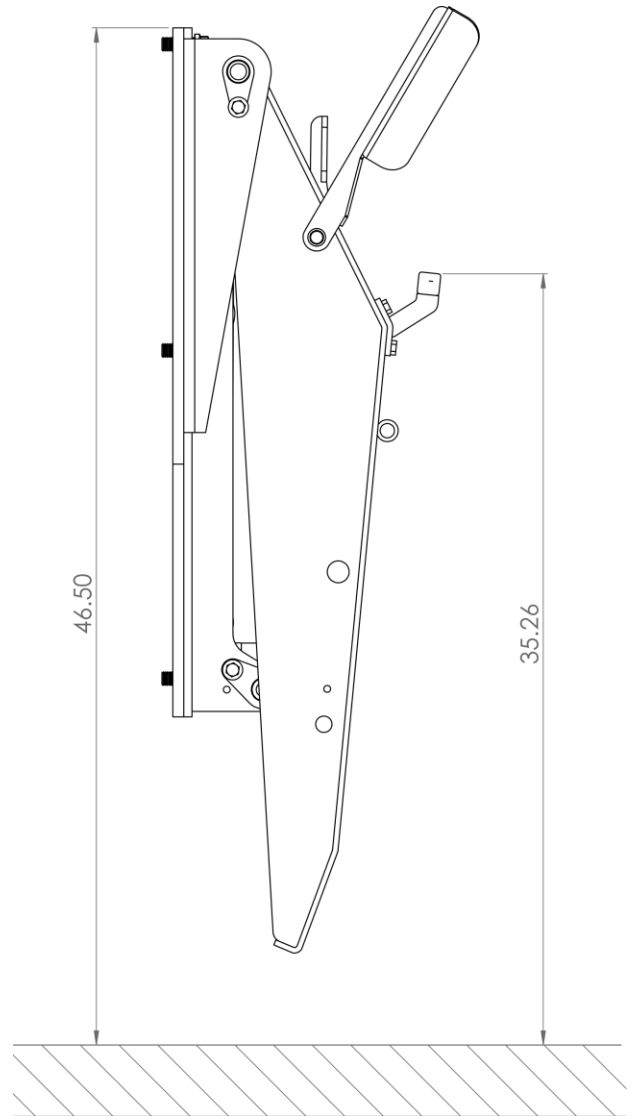

Maintaining the PO Check Valve

PO Check Valve: D63580

The valve locks the oil from escaping unless the hand control is activated. This locks equipment in position and prevents drifting when equipment is idle. It also acts as a safety, in the event of a broken hose, the valve stops the movement of the equipment.

This valve is not adjustable.

This valve requires no periodic maintenance.

If a problem is traced back to the PO check, turn off the system and remove the cartridge. Clean and inspect for damage. Replace cartridge if needed, flush the valve, rebuild and install.



Maintaining the Adjustable Flow Control

Adjustable Flow Control Valve: D63575

The valve is located on the lower port of the hydraulic cylinder. Its purpose is to restrict oil coming out of the cylinder when the lifter is moving back down. By restricting the oil, the lifter is prevented from “getting ahead” of the oil, creating a chattering and/or slamming into the ground.

This valve only works in one direction, so adjusting it does not affect the speed of the upwards direction.

The valve has a small arrow stamped into its body. The arrow should point away from the cylinder.

If the lifter comes down too quickly, try turning this valve in clockwise ¼ turn at a time until the down direction is smooth and under control.



Perkins Manufacturing Company
Creators of the TuckAway® Cart Lifter
www.perkinsmfg.com

800-882-5292 Revised: 2/22/2021

Page 9

Operating the Lifter

Operating Instructions

The recommended cycle speed is 3-4 seconds to travel up and 3-4 seconds to travel down. This cycle time is based on the safe and smooth movement that the plastic cart can be swung about at without risking damage to the cart or injury to the operator. Therefore, operating the lifter faster than this time will void the warranty.

It is recommended that the lifter be visually inspected on a daily basis to ensure that there is nothing obviously in need of repair. Broken or missing parts/hardware should be attended to immediately to avoid risk of further damage to the lifter, damage to the cart, or injury to the operator. Operating a cart lifter that is not properly maintained is hazardous.

Step 1: Roll a loaded cart to the lifter and position the upper bar of the cart on the upper saddle of the lifter or in a position where the lifter will engage the bar once starts its motion. (It is not necessary to lift the cart onto the upper saddle)

Step 2: Look and make sure no one is in the area of the lifter or cart, then operate the hand valve by pulling up on the handle. The lifter will rotate and engage the cart and raise it to 45 degrees above the horizon.

Safety Note: The hand valve operates like a deadman switch. Releasing the handle at any time will stop motion of the lifter. Normal operation may be resumed by operating the handle again.

Step 3: Check again that no persons are in the work area before lowering the cart to the ground by reversing the handle (pushing down) until the cart is safely back on the ground and the lifter has disengaged the cart.

Step 4: Remove the empty cart and repeat the process as needed.



Safe Operating Tips

Always follow your company's safety policy during the use of this lifter, including use of proper clothing/ personal protective gear, reflective clothing, etc. Remember, you are operating the lifter on a public road/alley among moving traffic. Always be aware of your surroundings and watch for cars and pedestrians.

Do not lift anything with the lifter other than ANSI approved carts which are in good condition. Non-approved carts may not lock properly, causing them to fall from the lifter, which can cause damage or injury and will void the warranty.

Do not use the lifter for any purpose other than lifting a cart. Lifters are not meant as steps, they are not to be used to help lift a commercial container, or used to crush/breakdown an item. Doing so can cause serious damage or injury and will void the warranty.

Speeding up the lifter beyond the recommended cycle time of 6-8 seconds and/or adjusting the relief valve to pick up weights heavier than 400 lbs can lead to damage or injury and will void the warranty.

Do not operate the lifter unless the area around it is clear of personnel. This means do not touch the lifter while it is in operation and do not stand or sit under/near the lifter while it is moving. Lifters have pinch points which can cause serious injury. Stay clear at all times.

Lifters can hang very low to the ground at certain points of their lift cycle. It is the operator's responsibility to move the lifter to a safe position while going down the road, such as putting the lifter all the way up or fully into the storage position. Lifters left hanging low risk bottoming out on the street, which will cause serious lifter damage. Damage caused by bottoming out is not covered by warranty.

Lifters of all kinds can be struck by utility poles, walls, other vehicles, backed into earthen hills, etc. It is the operator's responsibility to position the cart lifter in a safe position prior to coming close to any other foreign object. If the lifter is damaged by collision, the damage will not be covered by warranty.

If the lifter is installed in such a way that the lifter or cart can make contact with the packer blade, then it is critical to pay attention and make sure the lifter is not operated when the packer blade is down or coming down.

If the truck is equipped to dump commercial containers, the lifter must be stored all the way down prior to engaging the commercial container or the cart lifter may be crushed by the container. This damage is not covered by warranty.



Lifter operation is erratic, lifter does not move smoothly

When the lifter does not move smoothly, there is typically air in the system. This is usually an issue after the initial installation or a recent repair where the hydraulic lines may have been opened. Bleed air out of the system by loosening a fitting very slightly and running the hand valve to create flow. Excess air should bleed out of the opening in the fitting. Retighten when complete done.

In rare instances, the flow may be too low. This would also be noticeable if the lifter was also very slow. Try adjusting the diverter valve to increase the flow.

Another possibility is the adjustable flow control, D63575 not functioning properly. Check the arrow printed on the valve body. The valve should be installed so the arrow points away from the actuator. Adjust, clean, or replace the adjustable flow control valve as needed.

Cart lifter will not pick up the weight

The cart may be overweight. If the cart is obviously very heavy and hard to move, try removing a few items from the top to lighten the load.

The hand valve relief pressure setting may be set too low. Check and adjust the pressure using a pressure gage. Note the pressure being delivered and adjust accordingly.

If adjusting the hand valve's relief does not bring the pressure up to where it should be, then the truck's relief pressure setting may be set too low. Try adjusting the truck's relief valve (see manufacturer's instructions on how to do this for your vehicle)

In cases of older equipment, the hand valve may be in need of replacement or repair.

If all pressures are set properly and the hand valve works, then the actuator may have internal leakage. Test for internal leakage by running the lifter all the way up and dead-head the lifter up. Note the pressure gage and see that the pressure stays constant as the hand valve is held depressed. If the pressure falls, you may have internal leakage and the actuator should be repaired/rebuilt with new seals.

Lifter operates slowly

Check the flow adjustment on the diverter valve. Use a flow meter to make sure each lifter receives approximately 3.5 gpm. Adjust diverter as needed following instructions in the manual.

Engine idle may be too low to provide adequate flow. Following the manufacturer's instructions, adjust the engine idle. Remember increasing engine idle will increase fuel consumption.

The hand valve may be faulty. Check, clean and/or replace as needed.

The truck's pump may be faulty, unable to deliver the desired flow. Contact your truck manufacturer.



In rare instances, debris within the oil may be clogging the diverter valve. Check and clean the valve as needed.

Lifter operates too fast

Check diverter valve adjustment screw. Adjust in to lower the flow delivered to the lifters.

Engine idle speed may be too high. Adjust per the manufacturer instructions.

Diverter valve is leaking oil

Worn or Damaged seals within the diverter will cause external leaking. Rebuild the valve using D63477 divert valve spring kit.

Hand valve lever sticks, does not return to center

A worn or broken spring on the spool will cause the handle to fail to return to center. This is dangerous, since this means the deadman stop feature is not working. Check and replace the spring with part number D63192.

If the spring is not the problem, check and clean the hand valve of any rust/corrosion and debris in or around the spool or the external parts.

On new installations, this is the result of having the pressure and tank lines reversed. Check and make sure that the pressure line goes to the "IN" port and the tank line goes to the "OUT" port.

Hand valve is leaking oil

This is typically caused by worn or damaged seals. Install new seals with part number D63217

In some cases, the spool itself is worn. If so, replace the hand valve.

Unable to achieve 1950 psi at the hand valve

The truck's pressure setting may be too low. Adjust the truck pressure according to the manufacturer's instructions.

If pressure cannot be increased further, it may be necessary to install a speed up switch which will rev the engine higher during peak need to deliver the desired pressure. Note that speed up switches will increase fuel consumption.



Unable to achieve over 1400 psi

The truck pressure is too low. If adjustments do not help, the pump may be bad or underpowered. Contact your truck manufacturer.

Lifter breaks the lower bars of carts

First, make sure there is no damage to the lifter. Replace damaged components as needed.

Check adjustment of plunger assembly and threaded rod assembly. Check function of plunger. Adjust as needed.

On new installations, check the mounting height. It is common for brand new lifters to break lower bars if the lifter is installed too low. Remove the lifter and remount at the correct height.

Lifter breaks upper bar of carts

The upper bar of the cart is typically broken when the cart is lifted while it is excessively loaded, or while the lifter is operated too quickly. Adjust the speed of the lifter to bring the cycle time to 6-8 seconds. Make sure the pressure is set no higher than 1950 psi.

Make sure the lifter is not damaged. Bent or broken lifter parts can contribute to cart damage.

Lifter drops carts

A common problem is the lower latch to be damaged or unable to move freely. Check, clean and grease the parts as necessary to achieve free motion of the latch and appropriate latch timing.

Make sure the upper hook is not damaged.

Carts which are damaged or have missing lower bars will obviously not latch properly and should be repaired or replaced.

Some carts do not meet ANSI standards. Measure the problem cart and see that the bar to bar spacing is within 14 ½ - 15 ¼.



Lifter slams down to the ground or comes down too quickly

On the way down, the lifter can get ahead of the oil and free fall. Check that the adjustable flow control is mounted to the left side of the actuator, with the arrow pointed away from the actuator, and that the valve is adjusted properly. Try ¼ turn adjustments until the lifter returns to ground level smoothly.

Lifter drifts out of position when not in use

Make sure the PO Check valve is installed. If it is and the lifter still drifts, remove the PO check and remove and clean the cartridge. If the valve is damaged, replace it.

If the problem does not seem to be the PO check, the hand valve may have internal leakage. Replace the hand valve seals and/or spool as needed.

If the problem persists, then the actuator may be leaking internally. Check for internal leakage by running the lifter up and holding the hand valve while reading a pressure gage. If the pressure falls, then the actuator is leaking internally and should be rebuilt with a new seal kit.

Lifter is in good condition, latch is in good condition, but lifter still breaks carts

In this case, the lifter is most likely being operated too fast, or the carts are overweight. Excessively hard shaking of the carts by the operators can also lead to cart damage. Train your operators to operate the lifters properly.



Faceplate Exploded View

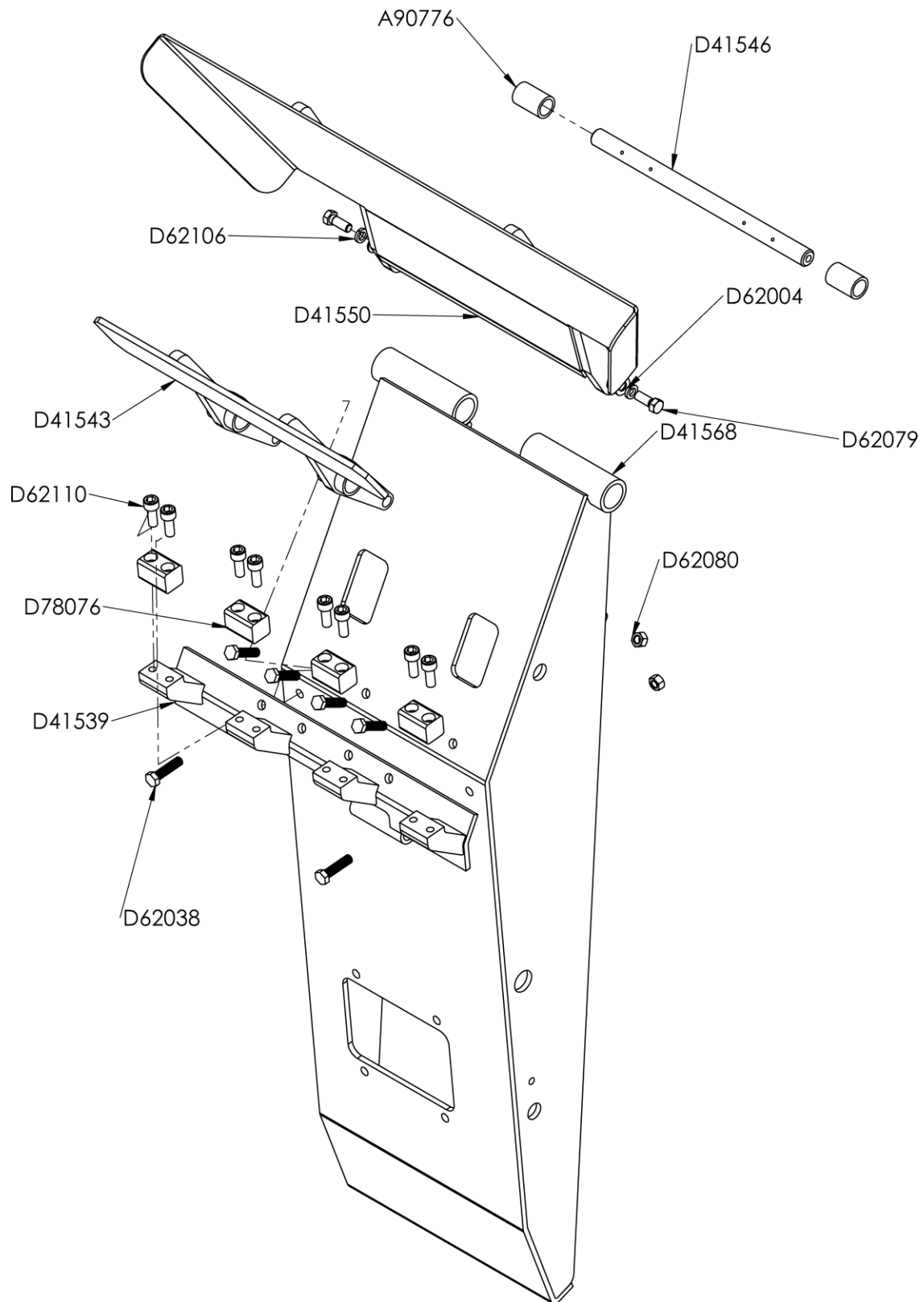

Backplate Exploded View

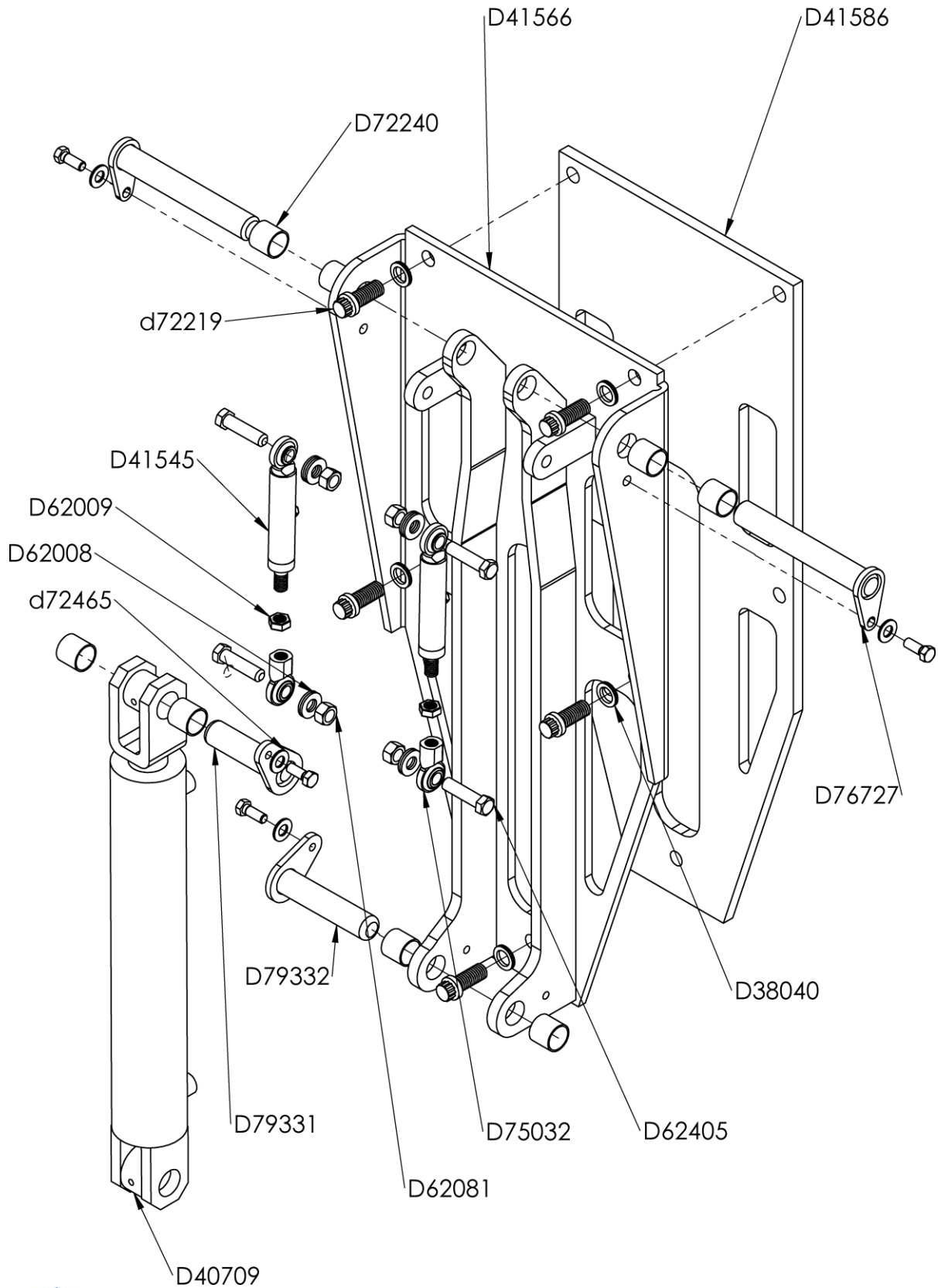

Perkins Manufacturing Company
 Creators of the TuckAway® Cart Lifter
www.perkinsmfg.com

800-882-5292

Revised:2/22/2021

Page 18

D6518 Parts List

Item	Description	Qty
A90776	Plastic Bushing Sm. 1 x 1.25 x 1 1/2" long	2
D38040	LOCKWASHER 5/8" NORDLOCK	5
D40709	CYLINDER ASSY	1
D41539	Teeth Bracket Weldment	1
D41543	Clamp Weld	1
D41545	Short Plunger Assembly	2
D41546	Clamp Pivot Pin	1
D41550	Chute Weldment	1
D41566	Mounting Plate Weldment	1
D41568	Face Plate Weldment (Rev A)	1
D41586	Back Plate	1
D62004	USS FLATWASHER 3/8 X 1 OD ZINC PLATED	2
D62008	SAE FLATWASHER 1/2 X 1.06 OD ZINC PLATED	10
D62038	BOLT HHCS 3/8-16 X 1 1/2 GR8, ZINC PLATED	6
D62079	BOLT HHCS 3/8-16 X 1 GR8 ZINC PLATED	6
D62080	LOCKNUT 3/8-16 GR 8 ZINC PLATED	6
D62081	LOCKNUT 1/2-13 GRADE 8 ZINC PLATED	4
D62106	SPLIT LOCKWASHER 3/8" ZINC PLATED	2
D62110	BOLT SHCS 3/8-16 X 1 GR8, ZINC PLATED	8
D62405	BOLT HHCS 1/2-13 X 2, GR8, Zinc Plated	4
D72219	12pt Flange Bolt 5/8-11 x 1 1/2 LG, ZINC PLATED	5
D72240	OILITE BEARING AA1110-01 1" ID X 1 1/8" OD X 1" LG REV A	8
D72465	NORDLOCK LOCKWASHER 3/8	4
D76727	PIN PIVOT WELD	2
D78076	TOOTH-BLACK PLASTIC UHMW REV A	4
D79331	CYL Base Pin Weld Pla REV A	1
D79332	Cylinder Head Pin Weld REV A	1
D63090	ADAPTER #8MT-#8MO	2
D63430	ADAPTER #8MT - #6MO	1
D63639	ADAPTER #6MO - #8FT	1
D63575	VALVE FLOW CONTROL ADJUSTABLE - 6 GPM MAX. #6 SAE PORTS *FREE FLOW ONE DIRECTION / ADJUSTABLE RESTRICTION IN OTHER DIRECTION.* RESTRICTS IN DIRECTION OF ARROW.	1
D63562	CAP #8 JIC	2
D72009	DRIVE SCREW #6-3/8 PLATED	4
D63491	Serial Number Plate	1
D75032	SHORTENED ROD EYE - 1/2-20 (REV A)	2
D62009	THIN JAMNUT 1/2-20 GR 8, ZINC PLATED	2



Making a Warranty Claim

For complete warranty coverage details, please see the warranty page at the end of this manual.

If you suspect that failure of the lifter to operate is due to a defect, please take a moment to locate the serial number of your lifter.

Warranty cannot be honored on lifters or individual pieces unless a serial number is provided. Since the tag is frequently lost, damaged, or painted over, it is a good idea to note the serial number in this manual at the time of installation.

At right is an example of the serial number plate. It will be stamped with a model number and serial number.

Once you have the number, please call Perkins Manufacturing at 800-882-5292 for additional instructions.



Protective Safety Labeling

Perkins provides each finished cart lifter with ANSI-specified caution labels. They are clearly placed directly on the machine for easy viewing by the operators.

Should the cart lifter ever be re-painted, or if the labels are damaged beyond recognition, it is advised to replace the labels immediately to help keep your crew safe.

OHSA always requires these labels to be in clear sight on the machine.

Responsibility to maintain proper caution and warning labels is the responsibility of the end-user.





You should make sure that all pressure is bled/released from the hydraulic or pneumatic system; for some systems it may be possible to work on a part of the system by using line-breaking or blanking procedures. Never loosen or tighten a hydraulic connection when the system is under pressure. The connection could fail catastrophically and cause an injection injury and/or damage to property. Inspect hoses regularly for wear then replace hoses before leaks can develop. Hydraulics systems should look clean and dry. You can typically see leaks where the machine is collecting dirt and debris that is sticking to the oil. Look for wet-looking areas that are collecting dirt. Check for abraded/scuffed hoses, loose or damaged fittings, or worn out seals, or other physical damage that may have led to creating the leak.





Perkins Manufacturing Company
Creators of the TuckAway® Cart Lifter
www.perkinsmfg.com

800-882-5292 Revised: 2/22/2021

Page 21

 	⚠ CAUTION
	<p>Pinch point hazard. Keep hands clear. Worker can be injured by moving parts.</p> <p>Skin injection hazard. Protect your hands & body from high pressure fluids. Relieve pressure before servicing. Do not check for leaks with your bare hands.</p>
<p>Compatible with ANSI Z245.60 type containers only.</p>	
<p>Cycle time must be 3-4 seconds up / 3-4 seconds down. Faster operation can cause damage and injury.</p>	
<p>Perkins Manufacturing, Company 708 482 9500 Label # D72589</p>	

 	⚠ ATENCIÓN
	<p>Punta Peligrosa. Mantenga las manos alejadas. El trabajador puede lesionarse moviendo partes.</p> <p>Riesgo de inyección cutánea. Proteja las manos y el cuerpo de líquidos en alta presión. Purgue la presión antes de realizar cualquier servicio. No busque fugas usando sus manos.</p>
<p>Compatible con ANSI Z245.60 solo contenedores de tipo.</p>	
<p>El tiempo del ciclo debe ser 3-4 segundos arriba / 3-4 segundos abajo. Una operación más rápida puede causar daños y lesiones.</p>	
<p>Perkins Manufacturing, Company 708 482 9500 Label # D72590</p>	

Dress appropriately for work with pants and sleeves that are not too long or too loose. Shirts should be fitted or tucked in. Avoid wearing loose and dangling jewelry. Tie back long hair and tuck braids and ponytails behind you or into your clothing. Wear the appropriate, well-fitting gloves for your job.

Look for possible pinch points before you start a task. Take the time to plan out your actions and decide on the necessary steps to work safely. Read and follow warning signs posted on equipment.

Machinery can pose a hazard with moving parts, conveyors, rollers, and rotating shafts. NEVER reach into a moving machine. Turn equipment off and use lockout/tagout procedures before adjusting, clearing a jam, repairing, or servicing a machine.





NOTICE

Grease all zerks on a weekly basis to maintain warranty.

Re-grease after power washing.

Visit www.perkinsmfg.com for important updates.

Please read the manual prior to operating or adjusting this machine for important information.

Perkins Manufacturing. Company 708 482 9500

Label # D72163

Maintaining the lifter is vital to ensure proper operation of the equipment and for warranty to be valid. Inspection of the lifter is also important to make sure there are no loose parts and that the lifter is properly greased. Not inspecting or maintaining the machine regularly can pose a hazard of parts coming loose, parts not moving properly or wear items to become too worn to not move properly. If any issues occur, please contact service immediately.



Perkins Manufacturing Company
Creators of the TuckAway® Cart Lifter
www.perkinsmfg.com

800-882-5292

Revised: 2/22/2021

Page 23

Safety Labeling and Training Requirements

Perkins provides safety labeling on all outgoing product per ANSI regulations, seen below.

19-01 Warning, Label and Safety Instructions.

Include standard safety instructions as one of the first items in a manual. This helps emphasize safe use of the product and can help the user understand the hazards, the consequences of the hazards and how to avoid the hazards. Priority placement also increases the likelihood that the information will be read. Any symbols or pictograms physically on the product should be included in the appropriate section of the manual to reinforce the association between the nature and severity of the hazard and the correct behavior.

The American National Standards Institute (ANSI) standard Z535.6, *Product Safety Information in Product Manuals, Instructions, and Other Collateral Materials*, should also be applied.

To help ensure the product user sees and understands warnings and safety instructions, you should make them conspicuous. It is critical that you make proper use of the signal words "*danger*", "*warning*", "*caution*" and "*notice*" and their corresponding signal colors *red*, *orange*, *yellow*, and *blue*.

Choosing the appropriate signal words and colors are based on an estimate of the likelihood of exposure to the hazardous situation and what could happen as a result of exposure to the hazard. The American National Standards Institute (ANSI) standard Z535.4, *Product Safety Signs and Labels*, defines the hazard signal words as follows:

DANGER: Indicates an imminently hazardous situation which, if not avoided, "will" result in death or serious injury. This signal word is to be limited to the most extreme situations.

WARNING: Indicates a potentially hazardous situation which, if not avoided, "could" result in death or serious injury.

CAUTION: Indicates a potentially hazardous situation, which, if not avoided, "may" result in minor or moderate injury. It may also be used to alert against unsafe practices.

NOTICE: Indicates information considered important, but not hazard related (e.g., messages relating to property damage).

It is the responsibility of owner of this product to maintain the safety labels, keep them clear & visible to all users, and replace the safety labels when they become worn or missing.

All users must read and understand this manual and the safety precautions before using this product.



Perkins Manufacturing Company
Creators of the TuckAway® Cart Lifter
www.perkinsmfg.com

800-882-5292

Revised: 08/08/23
Addendum

Manufacturing Company

Perkins Warranty Procedure

This procedure for claiming warranty must be followed or warranty will not be approved, credit will not be issued, and replacement parts will not be shipped. This document is not a replacement for the warranty policy. Please refer to the last page of your manual, which describes the warranty policy in detail.

If you believe your Perkins lifter has suffered from a failure that could be covered by warranty, immediately lock out any equipment that has failed per OSHA guidelines.

Take photographs of the lifter, including overall views of the unit and some close-ups, as necessary to properly record the failure in a way our engineering staff can examine. While taking photos of the lifter, record the serial number of the lifter.

Call Perkins at (800) 882-5292 and ask to speak to the service department. Requests for warranty can also be emailed to svaldez@perkinsmfg.com. Attach any photos to the email, as necessary. The service department will use the photos to determine if the return of parts for inspection is necessary or not. If the return of parts is required, the service department will issue you an RGA number.

Your replacement parts will be shipped at the time of your warranty request, but they will require a purchase order number/payment in order to ship. (Credit will be issued later, after warranty status is determined.) Your replacement parts will feature RGA numbers on the documentation referencing your warranty request. Replacements are sent UPS ground. For faster shipping, the customer will be charged.

Clearly mark the box of any returns with the provided RGA number in a prominent place. This helps our shippers identify your items. When your returned parts arrive, our service and engineering teams will inspect your shipment and determine if the failure is a defect covered by the warranty or not. If the item(s) are covered by warranty, credit will be issued. If the item(s) were not covered by warranty, a report will be generated that fully describes the reasoning behind the decision.

Common Warranty Mistakes:

Please do not ship lifters/parts to Perkins without first obtaining an RGA number. Parts received without prior authorization or without RGA markings will be discarded and credit will not be issued.

Orders that are placed without discussing warranty status will be treated as a typical order and will be billed accordingly. Credit will not be issued for warranty requests after the order is placed.

No warranty is allowed on lifters/parts not having a serial number.



Manufacturing Company

Perkins Return Policy:

If, within 30 days of receipt of the item(s), a customer would like to return an unused item(s), the customer may contact Perkins for a return authorization (RGA#). The item must be shipped within 2 weeks of the return authorization. The customer will pay the return freight and a 15% restocking fee on the return(s). The item must be in new / unused condition, and any damage or clean up required to restore the product to resalable condition will be charged to the customer.

Packages received without an RGA# on the packaging identifying who the product is from may be discarded or refused and credit may not be issued. Always make sure the RGA# is displayed on the box and on any included paperwork.

If Perkins shipped the wrong item(s), the incorrect item(s) may be returned within 30 days of receipt of the item by contacting Perkins for a return authorization (RGA#). The item(s) must be shipped within 2 weeks of the return authorization. Perkins will pay the return freight and waive the restocking fee.

If the return results in a net debit, the customer will be invoiced. If the return results in a net credit, the credit can be used against the replacement item(s) or a future purchase.

Special Notes:

Perkins does offer customized solutions and due to the customization of these items, Perkins cannot accept returns or refunds on anything custom ordered. This includes industrial units, cane lifters, and other items which have been specially fabricated to the customer's specifications. Unfortunately returns on these products cannot be accepted.

Perkins Manufacturing One-Year Limited Warranty

PERKINS MANUFACTURING COMPANY warrants its products to be free from defects in material and workmanship under normal use for a period of **one (1) year** from the date of delivery to the first purchaser.

Any claim under this warranty must be handled in accordance with PERKINS' warranty procedure.

This warranty is expressly limited to the repair or replacement in PERKINS' discretion of any component or part of any PERKINS product unit manufactured by PERKINS which is brought to PERKINS attention promptly after discovery and is proven to PERKINS' satisfaction to have been defective in material or workmanship.

This warranty shall not obligate PERKINS to bear the cost of labor or transportation charges in connection with the repair or replacement of defective parts, and it shall not apply to a product upon which repairs, or alterations have been made unless authorized in writing by PERKINS.

Any damage, wear & tear or improper use, substitution of parts not approved by PERKINS, modifications other than those done by PERKINS or as authorized in writing by PERKINS, or any alteration or repair by others in such a manner which, in PERKINS' judgment, materially and adversely affects the product shall void this warranty. Operation at an actuator cycle time of less than six seconds shall void this warranty. Wear items used for anti-friction purposes are not covered by this warranty.

Periodic maintenance is required in order to maintain warranty but is not covered by warranty. Please refer to the maintenance section of the service manual for instructions.

PERKINS makes no warranty of products manufactured by others and supplied by PERKINS, the same being subject to warranties, if any, of their respective manufacturers.

PERKINS shall not assume any liability for any incidental, consequential, direct, or indirect damage, loss or delay of any kind, including, but not limited to, the loss of profits, product or downtime.

PERKINS warrants any service parts it may sell for a period of ninety (90) day from the date of delivery for replacement only. The item being replaced must be returned to PERKINS for evaluation upon its request. The cost of labor to replace such part shall be the responsibility of the owner. PERKINS does not warrant any used parts.

PERKINS, whose policy is one of continuous improvement, reserves the right to improve its products through changes in design or materials as it may deem desirable without obligation to incorporate such changes in products of prior manufacture.

THE ABOVE WARRANTY SUPERCEDES AND IS IN LIEU OF ALL OTHER EXPRESS OR IMPLIED WARRANTIES INCLUDING, WITHOUT LIMITING, ANY IMPLIED WARRANTIES OF MERCHANTABILITY OR FITNESS FOR A PARTICULAR PURPOSE. NO EMPLOYEE OR ANY OTHER REPRESENTATIVE OF PERKINS IS AUTHORIZED TO CHANGE THIS WARRANTY IN ANY WAY OR TO GRANT ANY OTHER WARRANTY. THESE TERMS WILL BE CONSTRUED ACCORDING TO THE LAWS OF THE STATE OF ILLINOIS WITHOUT REGARD TO ITS CONFLICTS OF LAWS PROVISIONS. ALL ACTIONS OR PROCEEDINGS IN ANY WAY, MANNER OR RESPECT ARISING OUT OF OR RELATED TO THE GOODS WILL BE LITIGATED ONLY IN STATE OR FEDERAL COURTS, AS APPROPRIATE, LOCATED IN WILL COUNTY, ILLINOIS. BUYER CONSENTS AND SUBMITS TO JURISDICTION IN THE STATE OF ILLINOIS AND WAIVES ANY RIGHT TO TRANSFER THE VENUE OF ANY SUCH ACTION OR PROCEEDING.