



Installation & Operational Manual

Model D6064 Series Manual

Hydraulic Cart Lifter

Protected by US Patents 6,921,239 & 7,273,340



Perkins Manufacturing Company
Creators of the TuckAway® Cart Lifter
www.perkinsmfg.com

800-882-5292

Revised:4/1/22

D6064 Lifter Specifications

Cart Compatibility	ANSI Type B, US-Style two-bar carts having a bar to bar dimension of 14 ¾ - 15 ¼".
Typical Mounting Application	Front Loader
Tipper-Bar Compatible?	No.
Flow Rate Requirement	N/A
Cycle Time	N/A
Recommended Pressure Setting*	N/A
Maximum System Pressure	N/A
Weight Capacity**	N/A
Dump Angle	45 degrees from the horizon
Mounting Height (ground level to upper hook)	34"
Approximate Unit Weight (not counting packaging)	185 lbs
Hydraulic Package	Pneumatic Lifter
Warranty	1 year***

Perkins regularly makes product improvements. Specifications are subject to change without notice.

* Actual pressure required to lift a load can vary.

** Do not lift more than the recommended amount printed on the cart by the cart manufacturer or damage or injury may result.

*** See Warranty page for full details of coverage



Perkins Manufacturing Company
Creators of the TuckAway® Cart Lifter
www.perkinsmfg.com

800-882-5292

Revised:4/1/22
Page 1

ORIENTATION OF LEFT AND RIGHT HAND SIDES

To eliminate any confusion when discussing “left” and “right”, please see graphic below. Left and Right is that of the observer, when viewing the machine from the front of the machine.

**AS VIEWED WHEN LOOKING
AT THE FRONT OF THE LIFTER.**

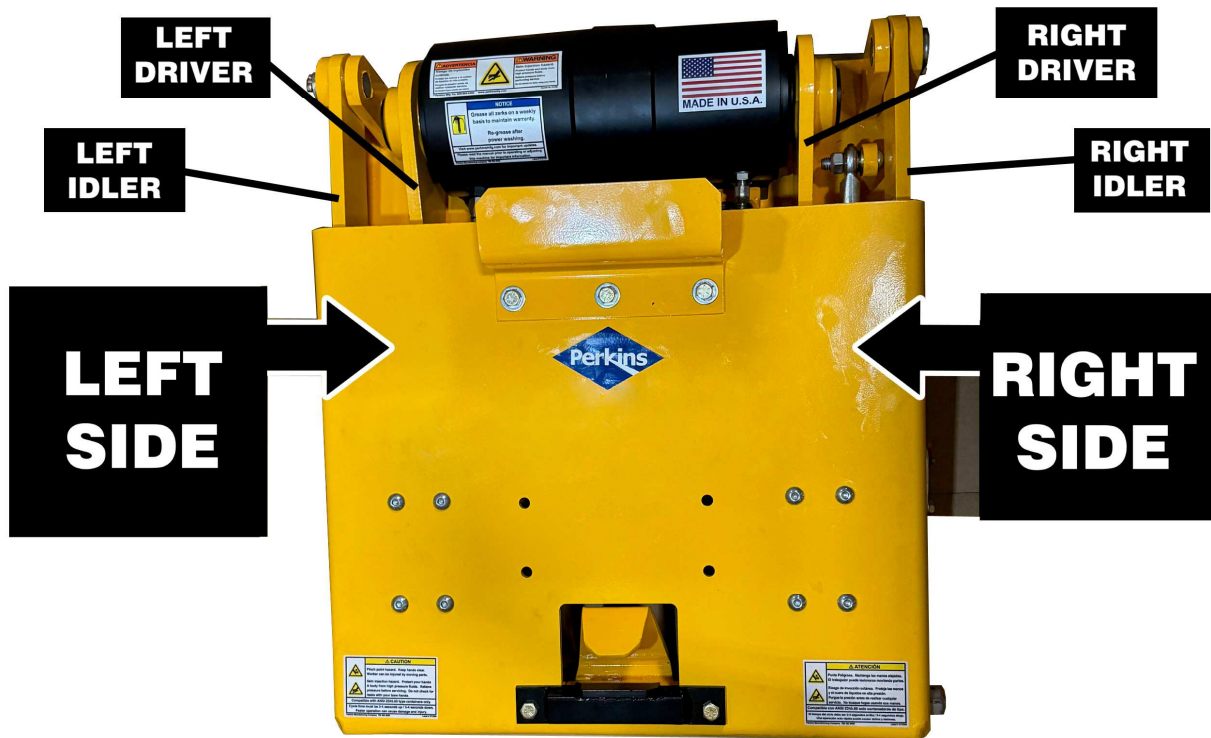

Drivers are always connected to the actuator hubs.

Idlers are not connected to the actuator.

Lifter shown is for example only. Your model may vary in appearance.



Perkins Manufacturing Company
Creators of the TuckAway® Cart Lifter
www.perkinsmfg.com

800-882-5292

Revised: 11/15/23
Addendum

Overall Dimensions

D6064

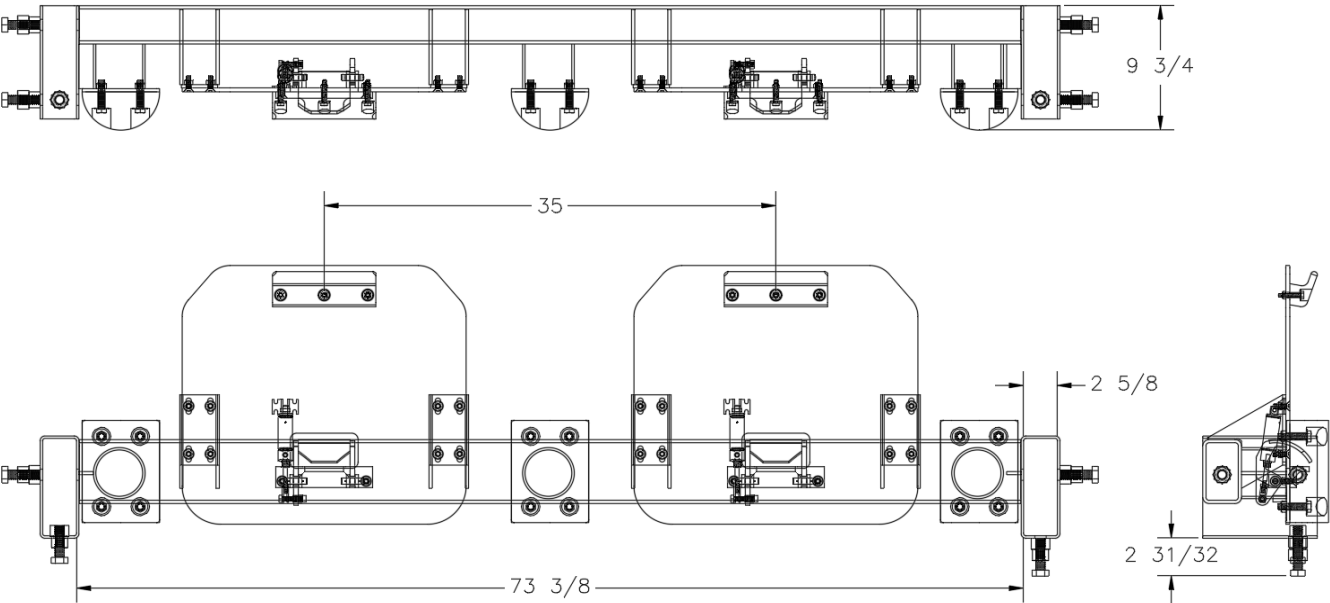

D6064b

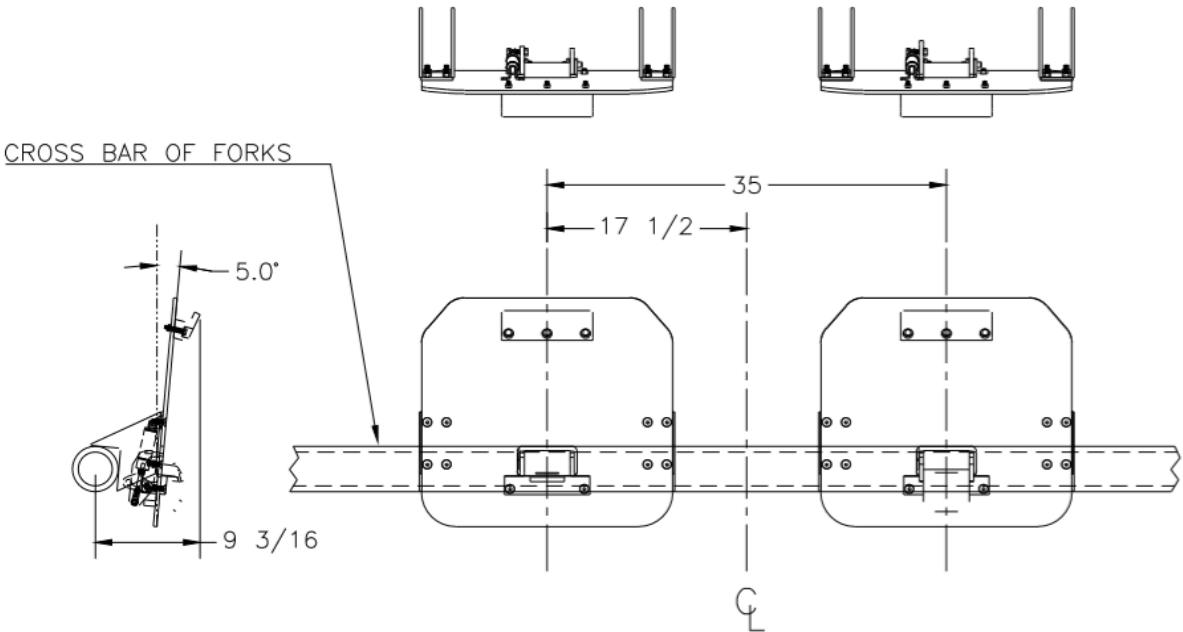

Perkins regularly makes product improvements. Dimensions are subject to change without notice.



Perkins Manufacturing Company
Creators of the TuckAway® Cart Lifter
www.perkinsmfg.com

800-882-5292

Revised:4/1/22
Page 2

D6064C

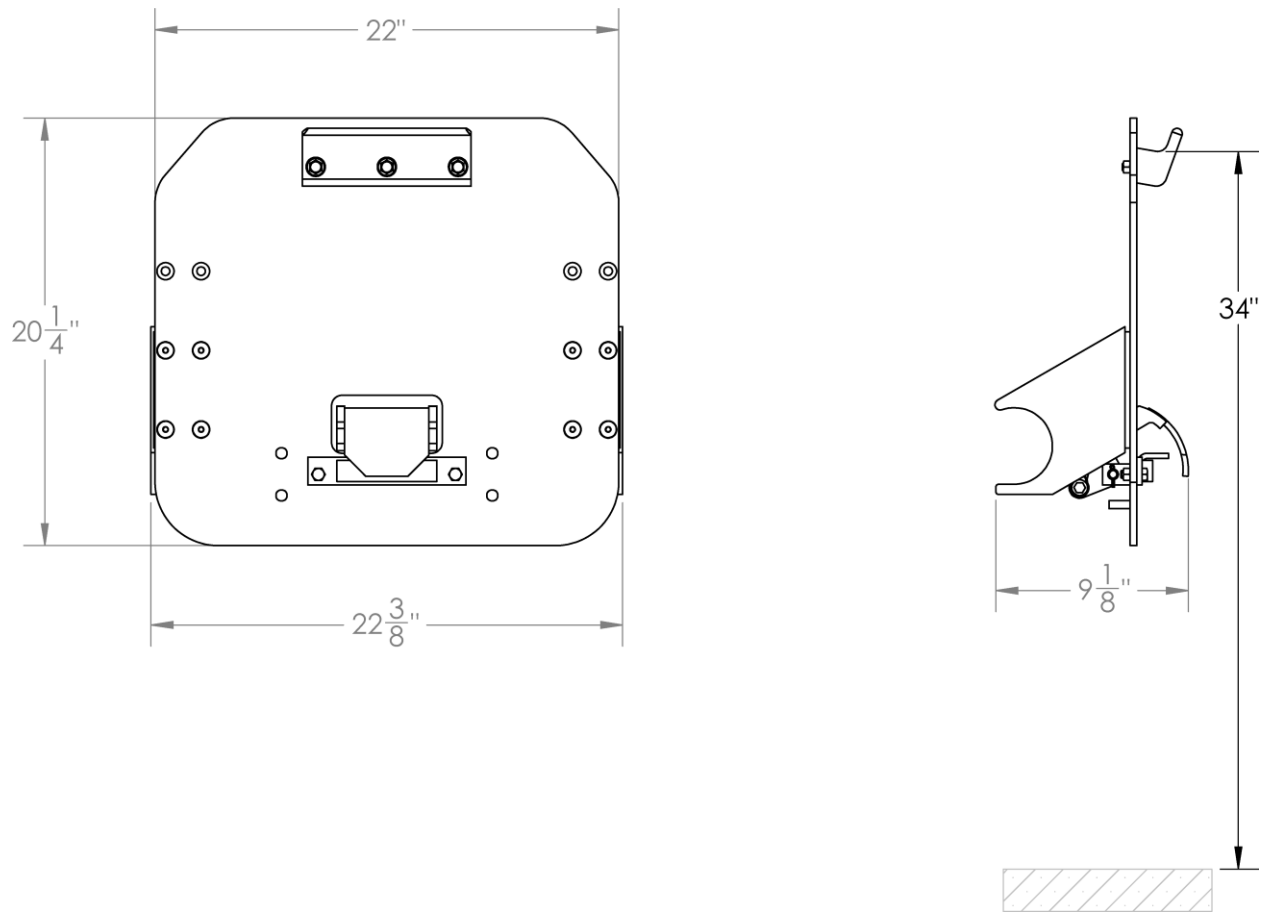

D6064D

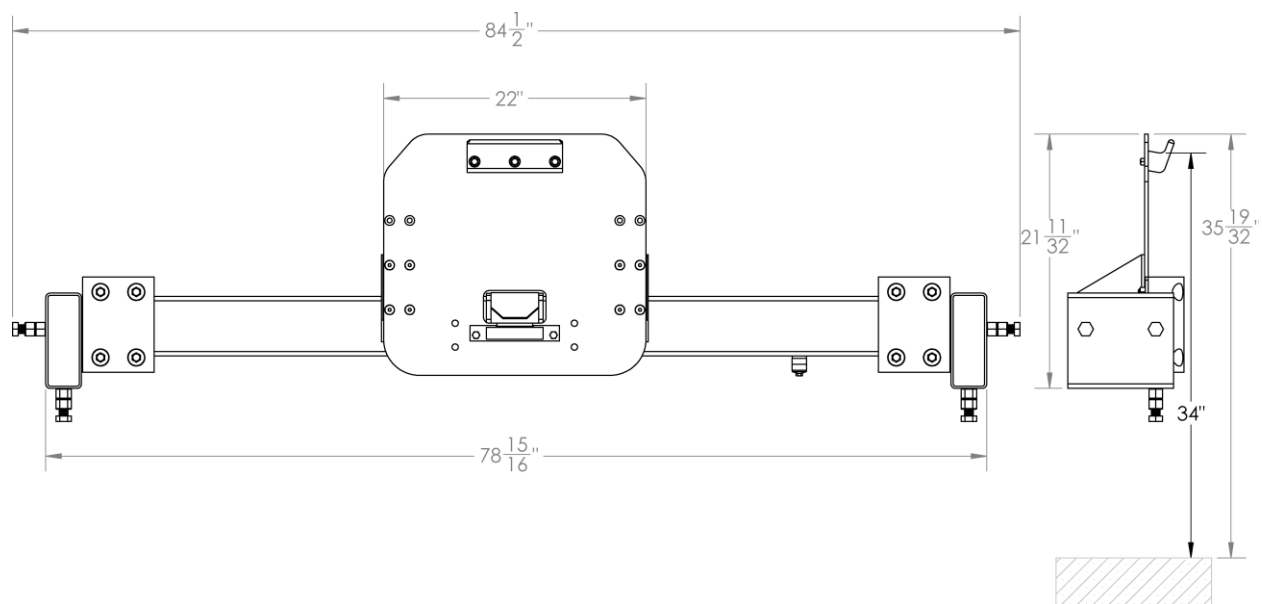

Perkins Manufacturing Company
 Creators of the TuckAway® Cart Lifter
www.perkinsmfg.com

800-882-5292

Revised: 4/1/22
 Page 3

D6064-M

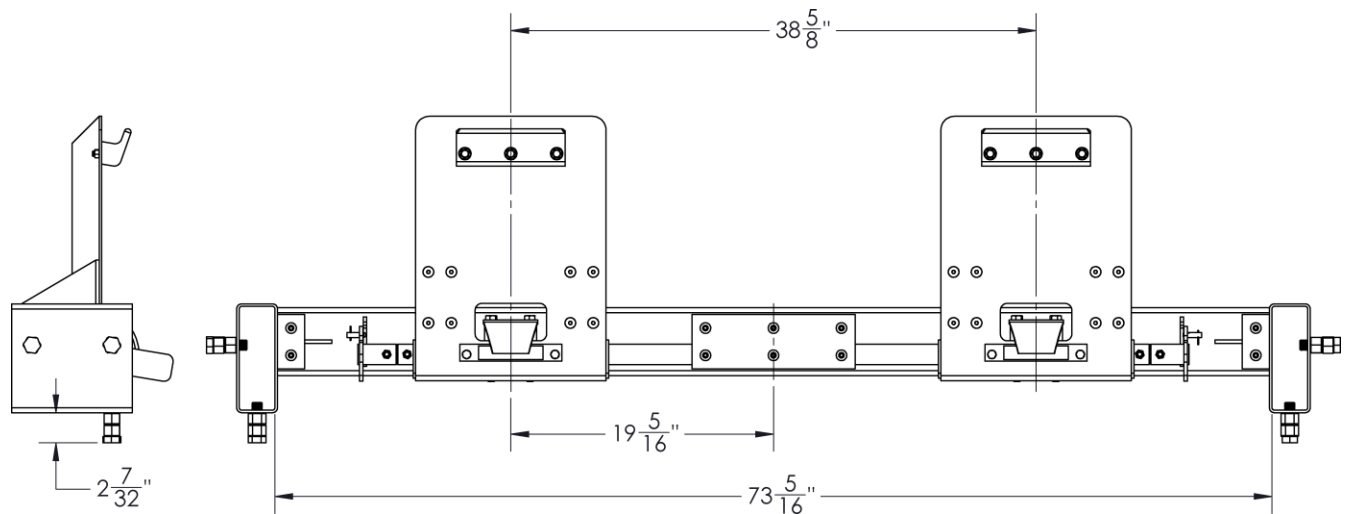

D6064-3

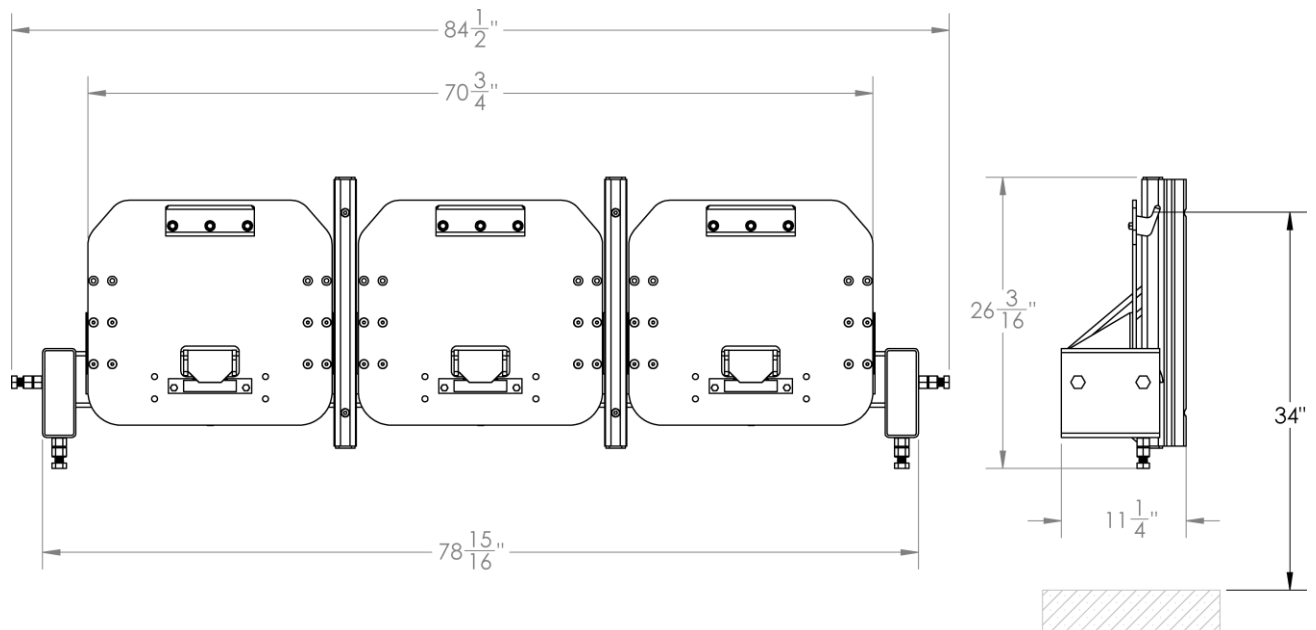

Glossary of Terms

Cart Types



ANSI Type B carts (US-Style two-bar carts) with a dimension of 14 $\frac{3}{4}$ - 15 $\frac{1}{4}$ " bar to bar spacing.



ANSI Type C Carts (European-type) Using an upper lip for lifting. Height to ground varies with size of cart.



ANSI Type D Carts (Diamond-Type)



ANSI Type G Carts (Automated Collection) Having a rounded body ideal for gripper arms to clasp around.

Note: Some ANSI Type B carts are also Type G compatible, but some carts, particularly older designs, are not. This affects gripper-arm type of lifters that rely on grasping the cart around it's body. If using a gripper arm type of lifter, check your carts and see if they have rounded corners (look for approximately 6" radius). If so, they are likely ANSI Type G compatible.

Key Components



Pneumatic

The valves are shown for reference / identification purposes only. Your specific installation may require other equipment not shown.



Perkins Manufacturing Company
Creators of the TuckAway® Cart Lifter
www.perkinsmfg.com

800-882-5292

Revised:4/1/22
Page 5

Installation Safety

Please read this manual prior to installing, repairing or using this cart lifter.

- ✧ Installation of this equipment requires welding, painting, grinding, torching and working with high- pressure hydraulic systems. The appropriate safety equipment should be used at all times.
- ✧ Always follow OSHA specified lock-out procedures while working with a truck.
- ✧ Cart lifters weigh, on average, between 185 to 300 lbs. Do not lift the lifter onto the mounting plate by hand. Always use proper lifting equipment.
- ✧ Always use a chain or strap to secure the lifter in the upright position during the installation process. Unsecured lifters may fall suddenly causing injury.
- ✧ The truck to which the lifter is to be installed should be empty of waste. Torching and welding can ignite the contents of the truck and cause a fire.
- ✧ Do not weld on the truck unless a ground is in place and the battery is disconnected.
- ✧ Do not open/loosen any hydraulic lines unless the system is off and depressurized.
- ✧ Always double-check hydraulic fittings and hoses for tightness prior to reactivating the pump.
- ✧ Always relocate lights that need to be moved due to the position of the cart lifter to a clear and unobstructed area clearly visible to drivers.
- ✧ All painting of the truck/lifter after installation is complete should be done with proper ventilation and per local regulations. Do not paint over caution and warning labels.
- ✧ If there are any questions about the proper installation or use of the cart lifter not covered in the manual, it is recommended to call Perkins at 800-882-5292.



Please be aware of the risks of working with welding equipment and consumables. Always use safety protection equipment. The sparks may ignite fire, always clean the area from flammable material or flammable chemicals, do not weld close to gas lines or on top of electrical cords or installations. Disconnect battery cables from the battery and make sure the vehicle is perfectly grounded prior to attempt to do any weld. Always weld in a ventilated area.



WHEN WELDING, WEAR APPROPRIATE EYE AND SKIN PROTECTION. WELDING LIGHT CAN BLIND. WELDING LIGHT CAN SUNBURN THE SKIN. LONG TERM EXPOSURE TO WELDING LIGHT CAN CAUSE CANCERS. ALWAYS WEAR PPE WHEN WELDING. PROPER PPE SHOULD ALSO BE WORN BY ANYONE IN THE THE WORK ZONE WHO MIGHT ALSO BE EXPOSED.



Correct and safe electric welding station

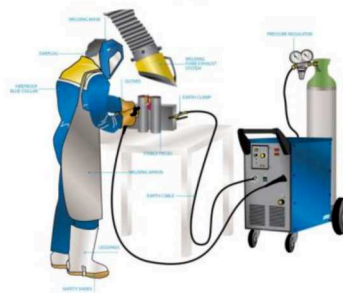

HYDRAULIC SYSTEMS CAN LEAK OUT HIGH PRESSURE WHICH CAN CAUSE SERIOUS INJURY, GANGRENE OR DEATH. DO NOT CHECK FOR LEAKS WITH YOUR BARE HANDS AND AVOID CONTACT WITH LEAKING OIL STREAMS.

HYDRAULIC OIL CAN ENTER THE BLOODSTREAM. SEEK MEDICAL ATTENTION IMMEDIATELY IF YOUR SKIN IS PUNCTURED BY HYDRAULIC OIL.

HYDRAULIC SYSTEMS CAN BECOME HOT (GENERALLY UP TO 170-180 DEG. F.) TO AVOID BURNS, DO NOT TOUCH VALVES, ACTUATORS, CYLINDERS, AND OTHER HOT COMPONENTS, EVEN AFTER THE SYSTEM IS SHUT OFF IT WILL REMAIN HOT AND TAKE TIME TO COOL DOWN.

ALWAYS TURN OFF A SYSTEM BEFORE SERVICING IT. DEPRESSURIZE THE CIRCUIT BY ACTIVATING THE CONTROLS WITH THE SYSTEM OFF TO RELIEVE ANY BUILT UP PRESSURE.

NEVER WORK UNDER A RAISED LOAD. RAISED EQUIPMENT CAN SUDDENLY FALL WHEN A VALVE OR LINE IS OPENED (LIKE A MOUSETRAP). IF THE EQUIPMENT MUST BE SERVICED IN THE RAISED POSITION, SECURE THE EQUIPMENT WITH CHAIN OR STRAP TO HOLD IT UP SAFETY.



Perkins Manufacturing Company
Creators of the TuckAway® Cart Lifter
www.perkinsmfg.com

800-882-5292 Revised:8/10/2023

Page 11

Installation Tips

Do not mount the lifter to a refuse body which is not already mounted to a chassis. Chassis heights can vary and this will affect the final installed height of the cart lifter.

Tack weld only until all positions and clearances are verified to work well for your application.

Always work on a smooth level surface with an empty truck.

Mark Your Centerlines

Begin by selecting whether the installation will be centered on the truck, or offset, or a double installation. Draw a centerline on the truck's loading sill.

A centered installation will place the lifter directly centered on the centerline of the truck.

An offset installation will place the lifter 17 ½" from the center of the truck, (usually to the curb side) as shown in the picture at right.

A double installation will place a lifter 17 ½" to the left and 17 ½" to the right of the truck's centerline.



A typical offset installation.

Determine the Mounting Height

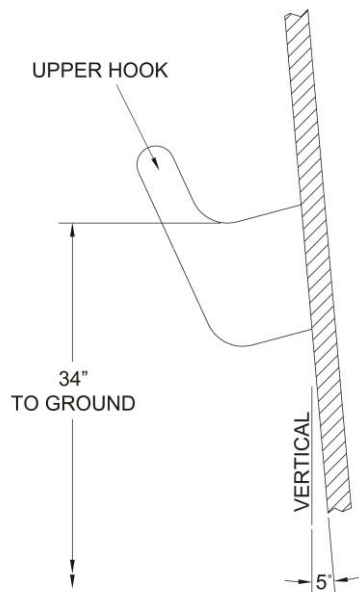

Upper hook mounting height

The mounting height is critical to the proper function of any cart lifter. The ideal location for the upper hook is 34" off the ground, when the lifter is positioned so that the faceplate is 5 degrees tilted back from vertical as shown in the diagram at left.

It is important that the packer body be mounted to a chassis, and the truck is empty and parked on a smooth and level surface when this mounting height is determined.

A cart lifter which has been positioned too low may kick carts away before successfully engaging them.

A cart lifter which is mounted too high will make it difficult for the operator to latch the cart at all, causing the operator to have to lift the cart onto the latch.

A good mounting height will make latching carts effortless with no lifting or holding the cart in place.



Positioning the Mounting

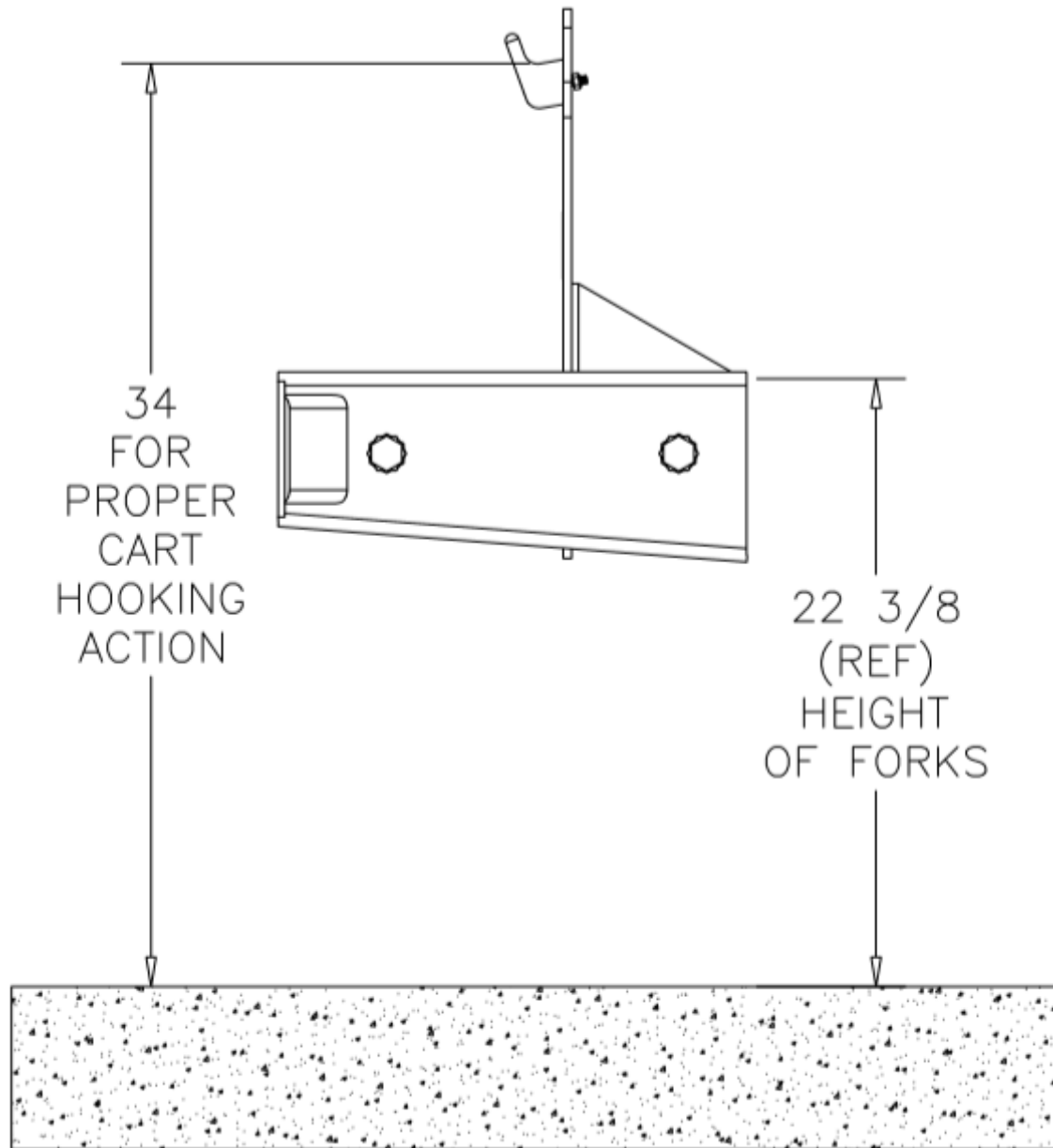

** The mounting plate may be positioned at 34" for proper hooking of carts. The mounting plate itself should be vertical and level.*



Perkins Manufacturing Company
Creators of the TuckAway® Cart Lifter
www.perkinsmfg.com

800-882-5292

Revised:4/1/22
Page 8

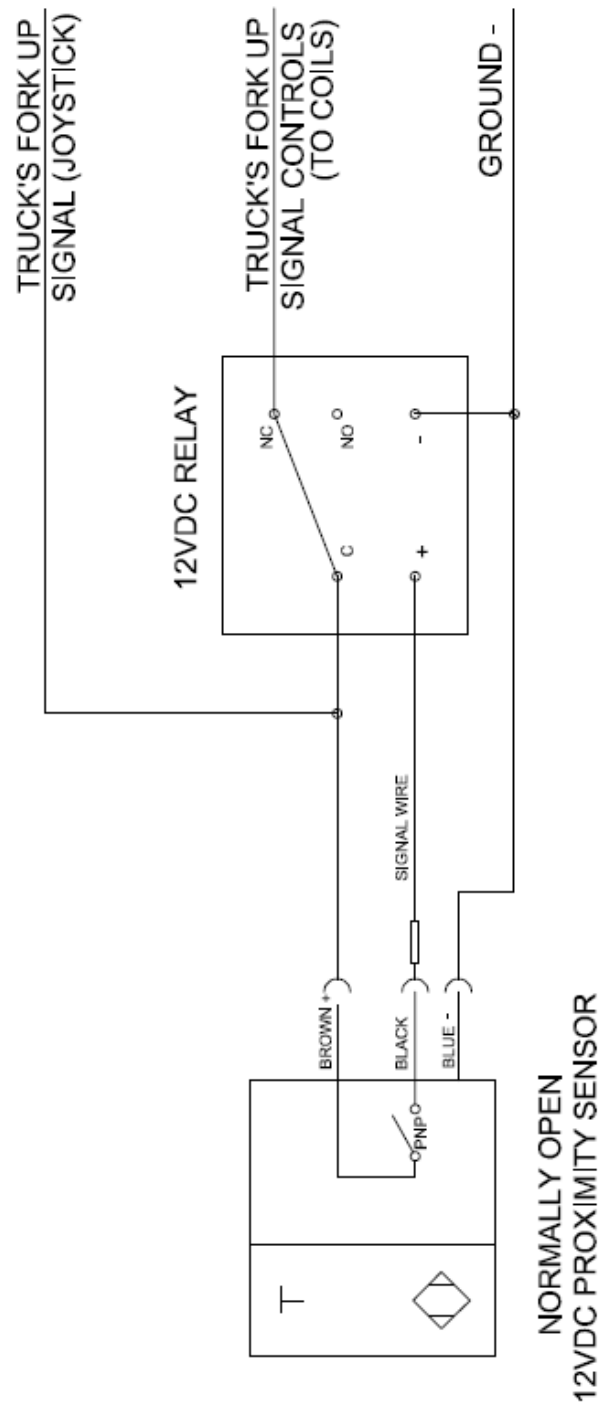

The purpose of the sensor is to sense the forks and stop the operator from pushing the faceplates into the grill or window guard.

*The sensor is sold separately or can be provided and rigged by the installer at your preference.



Perkins Manufacturing Company
Creators of the TuckAway® Cart Lifter
www.perkinsmfg.com

800-882-5292

Revised:4/1/22

Page 9

Operating the Lifter

- Start the engine and activate the pump
- Roll a cart to the lifter, placing it so the upper hook will grasp the top bar/pocket of the cart
- Pull handle to lift the front loader arms so that the carts will come up off the ground about a foot.
- Use the pneumatic hand lever to close the latches of the D6064 frontload lifter
- Raise the front loader arms and dump the bin contents.
- Bring the front loader arms back down, so that the carts are still about a foot in the air.
- Release the pneumatic hand lever so the lower latches release the carts.
- Bring the front loader arms all the way down to return the carts to the ground.
- Remove empty carts and repeat as necessary.



Safe Operating Tips

Always follow your company's safety policy during the use of this lifter, including use of proper clothing/ personal protective gear, reflective clothing, etc. Remember, you are operating the lifter on a public road/alley among moving traffic. Always be aware of your surroundings and watch for cars and pedestrians.

Do not lift anything with the lifter other than ANSI approved carts which are in good condition. Non-approved carts may not lock properly, causing them to fall from the lifter, which can cause damage or injury and will void the warranty.

Do not use the lifter for any purpose other than lifting a cart. Lifters are not meant as steps, they are not to be used to help lift a commercial container or used to crush/breakdown an item. Doing so can cause serious damage or injury and will void the warranty.

Speeding up the lifter beyond the recommended cycle time of 6-8 seconds and/or adjusting the relief valve to pick up weights heavier than 400 lbs can lead to damage or injury and will void the warranty.

Do not operate the lifter unless the area around it is clear of personnel. This means do not touch the lifter while it is in operation and do not stand or sit under/near the lifter while it is moving. Lifters have pinch points which can cause serious injury. Stay clear at all times.

Lifters can hang very low to the ground at certain points of their lift cycle. It is the operator's responsibility to move the lifter to a safe position while going down the road, such as putting the lifter all the way up or fully into the storage position. Lifters left hanging low risk bottoming out on the street, which will cause serious lifter damage. Damage caused by bottoming out is not covered by warranty.

Lifters of all kinds can be struck by utility poles, walls, other vehicles, backed into earthen hills, etc. It is the operator's responsibility to position the cart lifter in a safe position prior to coming close to any other foreign object. If the lifter is damaged by collision, the damage will not be covered by warranty.

If the lifter is installed in such a way that the lifter or cart can make contact with the packer blade, then it is critical to pay attention and make sure the lifter is not operated when the packer blade is down or coming down.

If the truck is equipped to dump commercial containers, the lifter must be stored all the way down prior to engaging the commercial container or the cart lifter may be crushed by the container. This damage is not covered by warranty.



Making a Warranty Claim

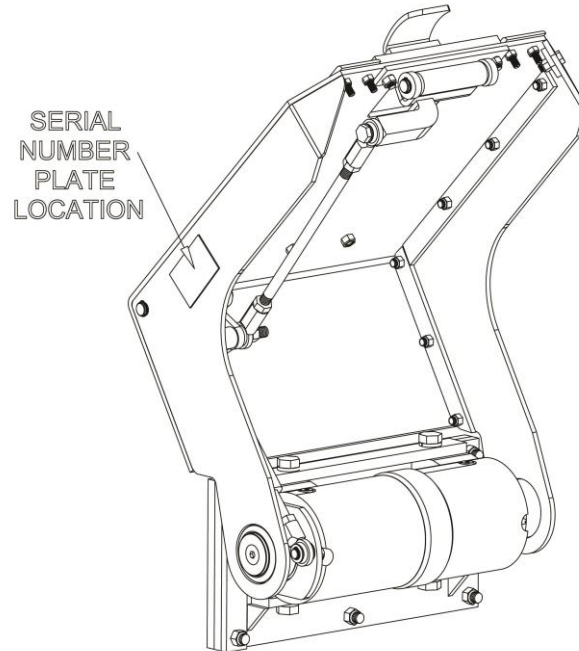

For complete warranty coverage details, please see the warranty page at the end of this manual.

If you suspect that failure of the lifter to operate is due to a defect, please take a moment to locate the serial number of your lifter.

Warranty cannot be honored on lifters or individual pieces unless a serial number is provided. Since the tag is frequently lost, damaged, or painted over, it is a good idea to note the serial number in this manual at the time of installation.

At right is an example of the serial number plate. It will be stamped with a model number and serial number.

Once you have the number, please call Perkins Manufacturing at 800-882-5292 for additional instructions.

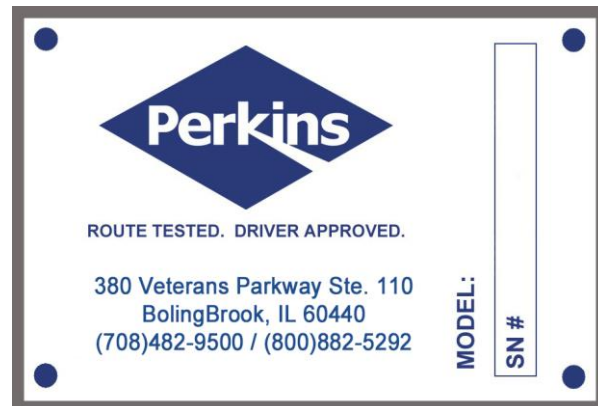

Perkins Manufacturing Company
Creators of the TuckAway® Cart Lifter
www.perkinsmfg.com

800-882-5292

Revised:4/1/22
Page 12

D6064 – Exploded Face Plate

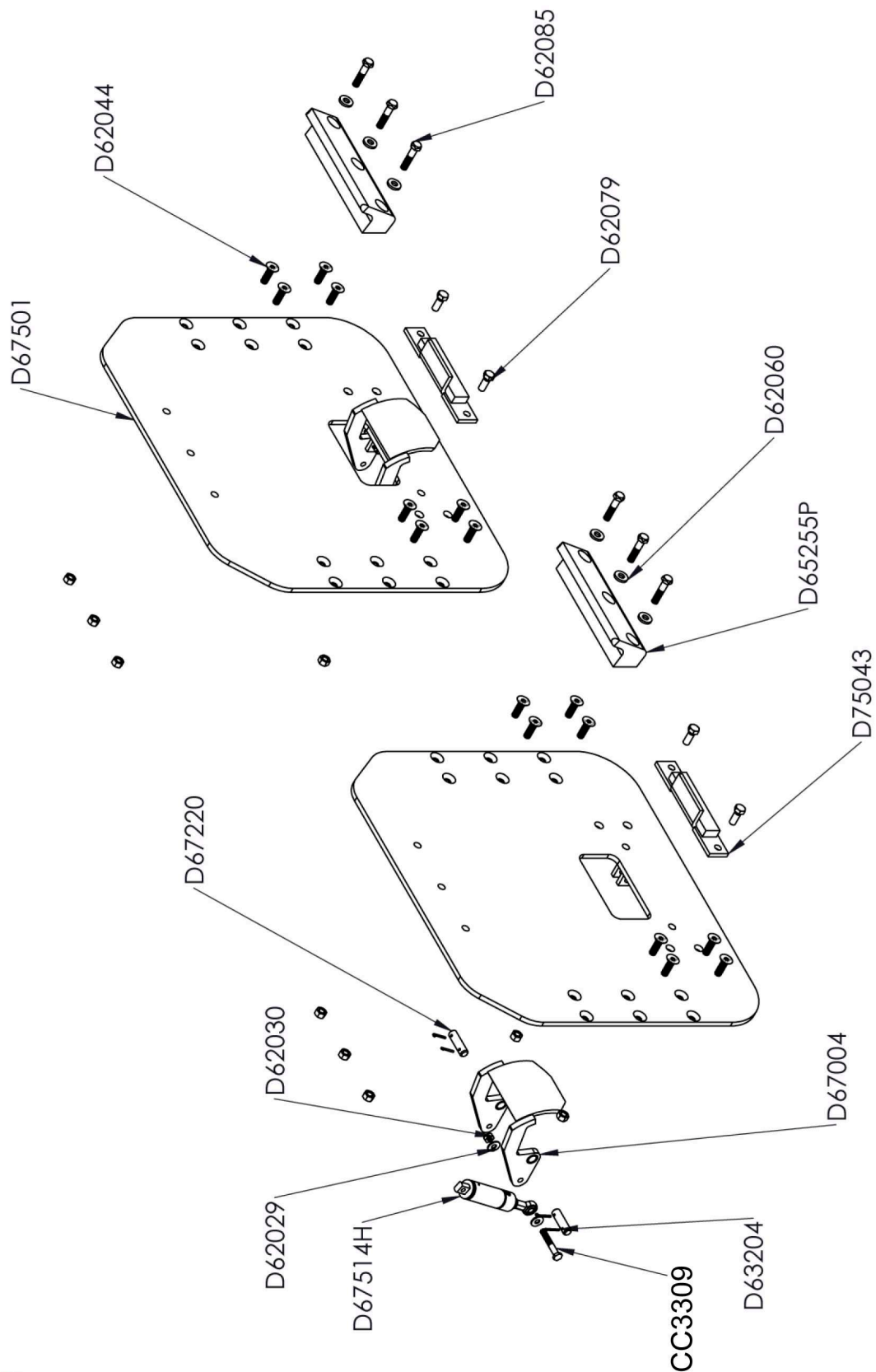

D6064 – Exploded Base Frame

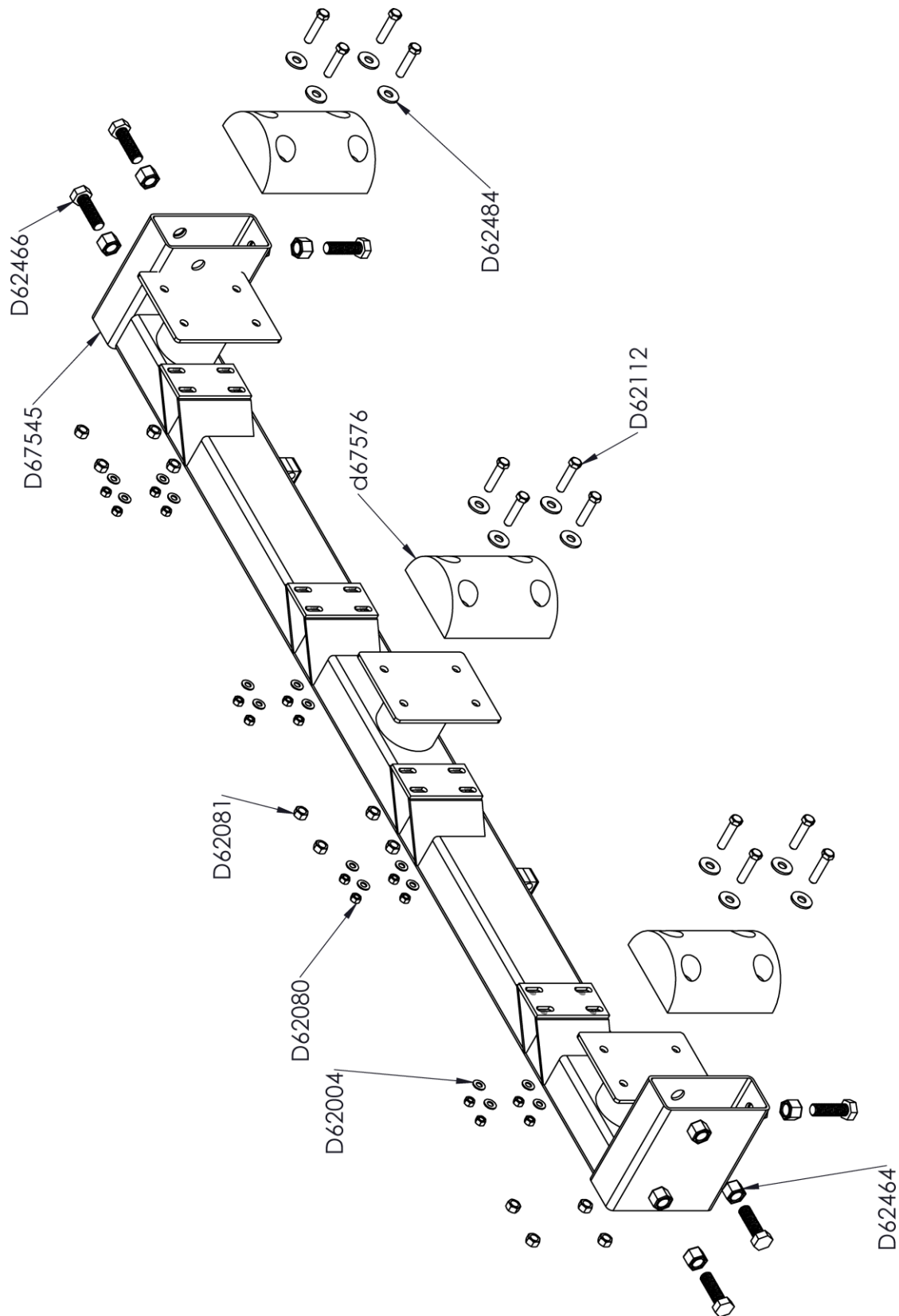

Perkins Manufacturing Company
Creators of the TuckAway® Cart Lifter
www.perkinsmfg.com

800-882-5292

Revised: 4/1/22
Page 14

D6064b – Exploded

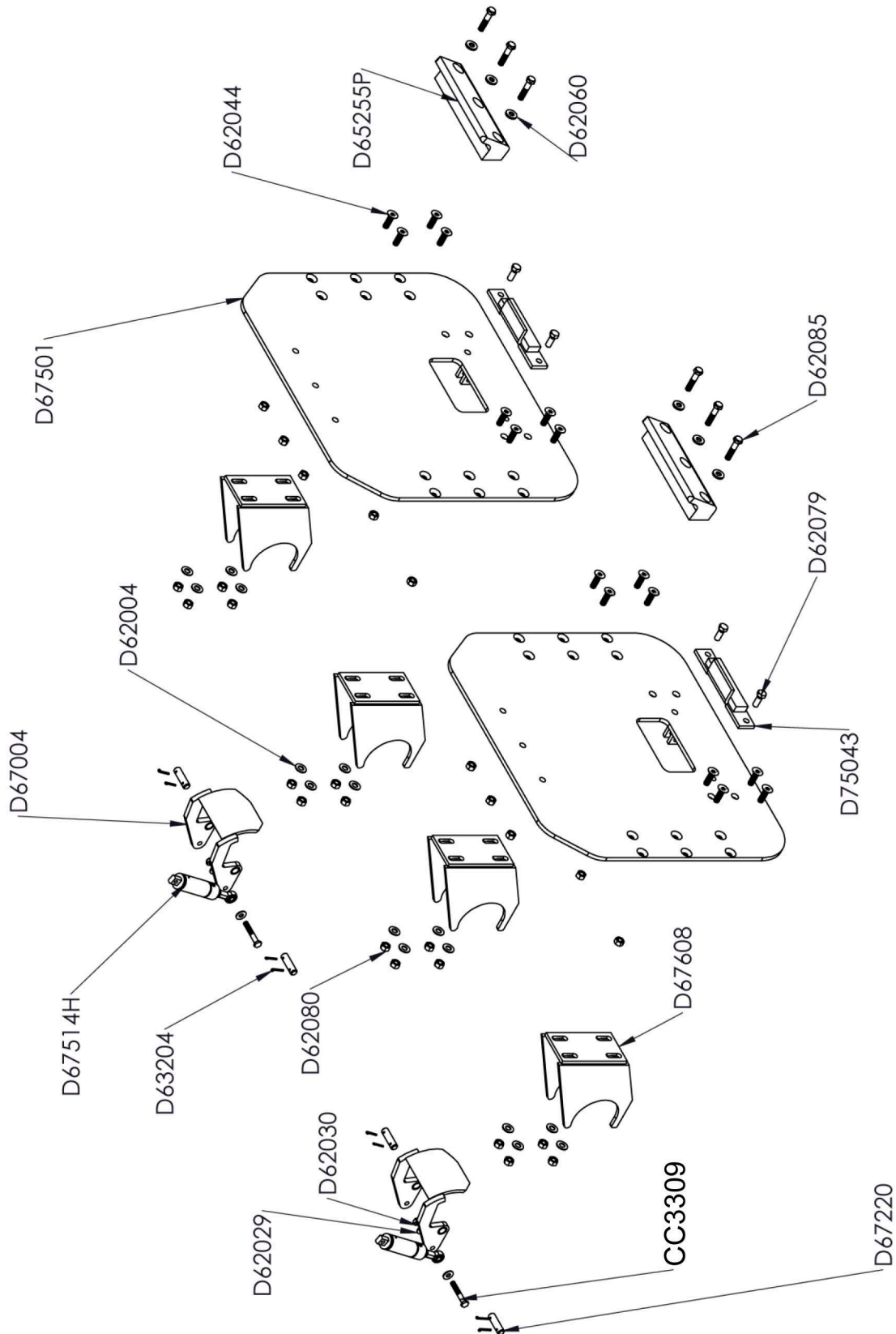

D6064D – Exploded Faceplate

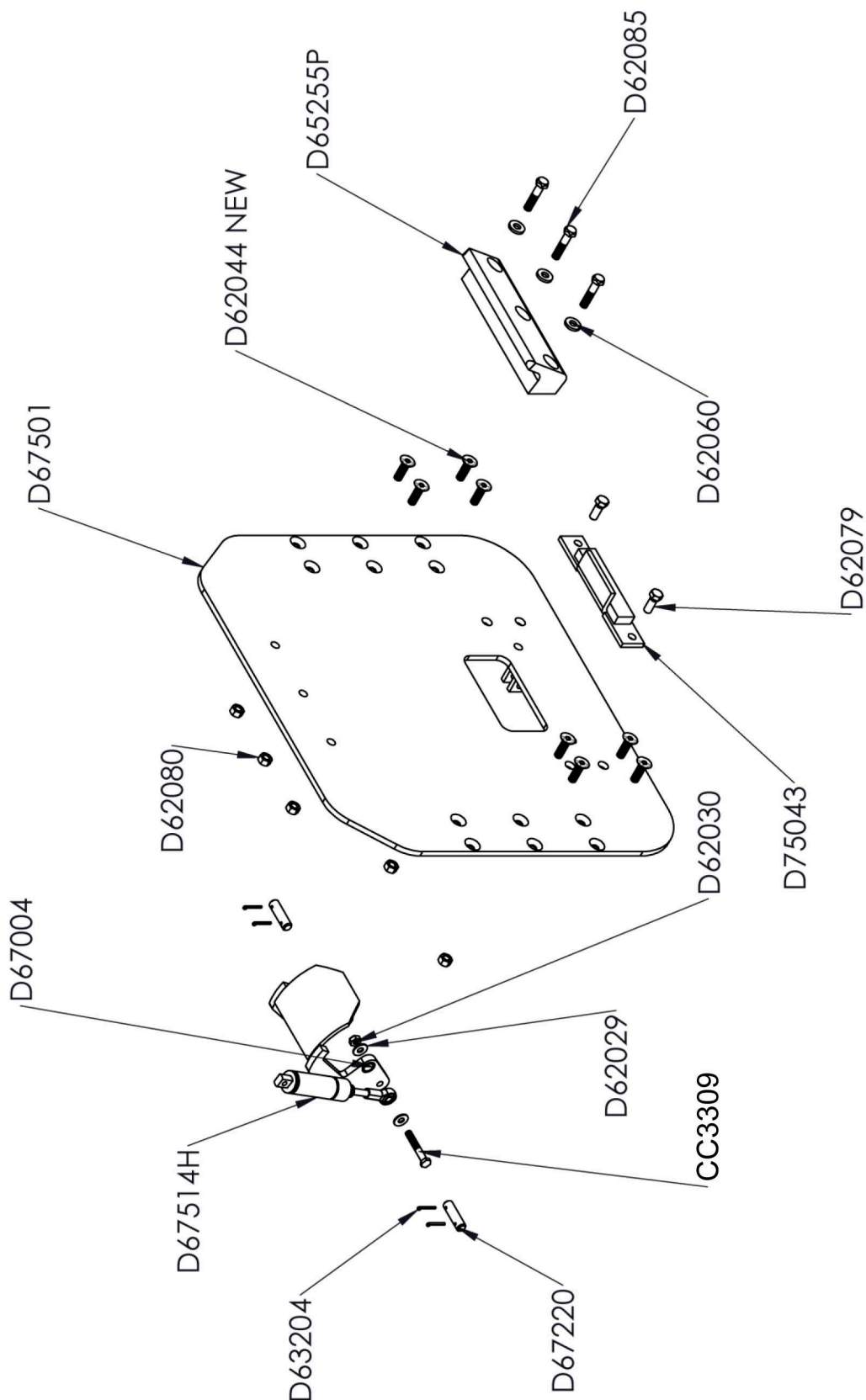

D6064D – Exploded Base Frame

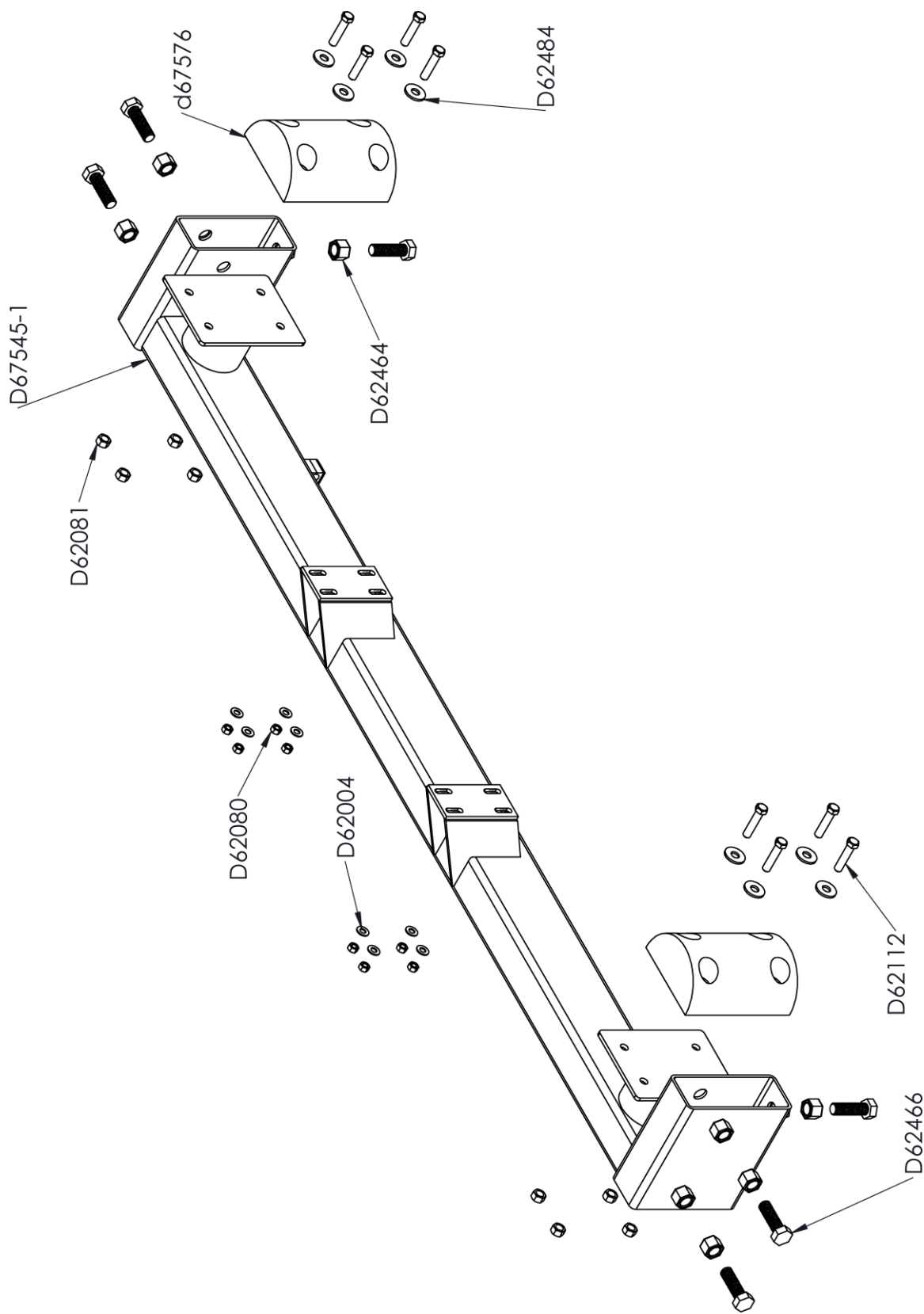

D6064-3 – Exploded Face Plate

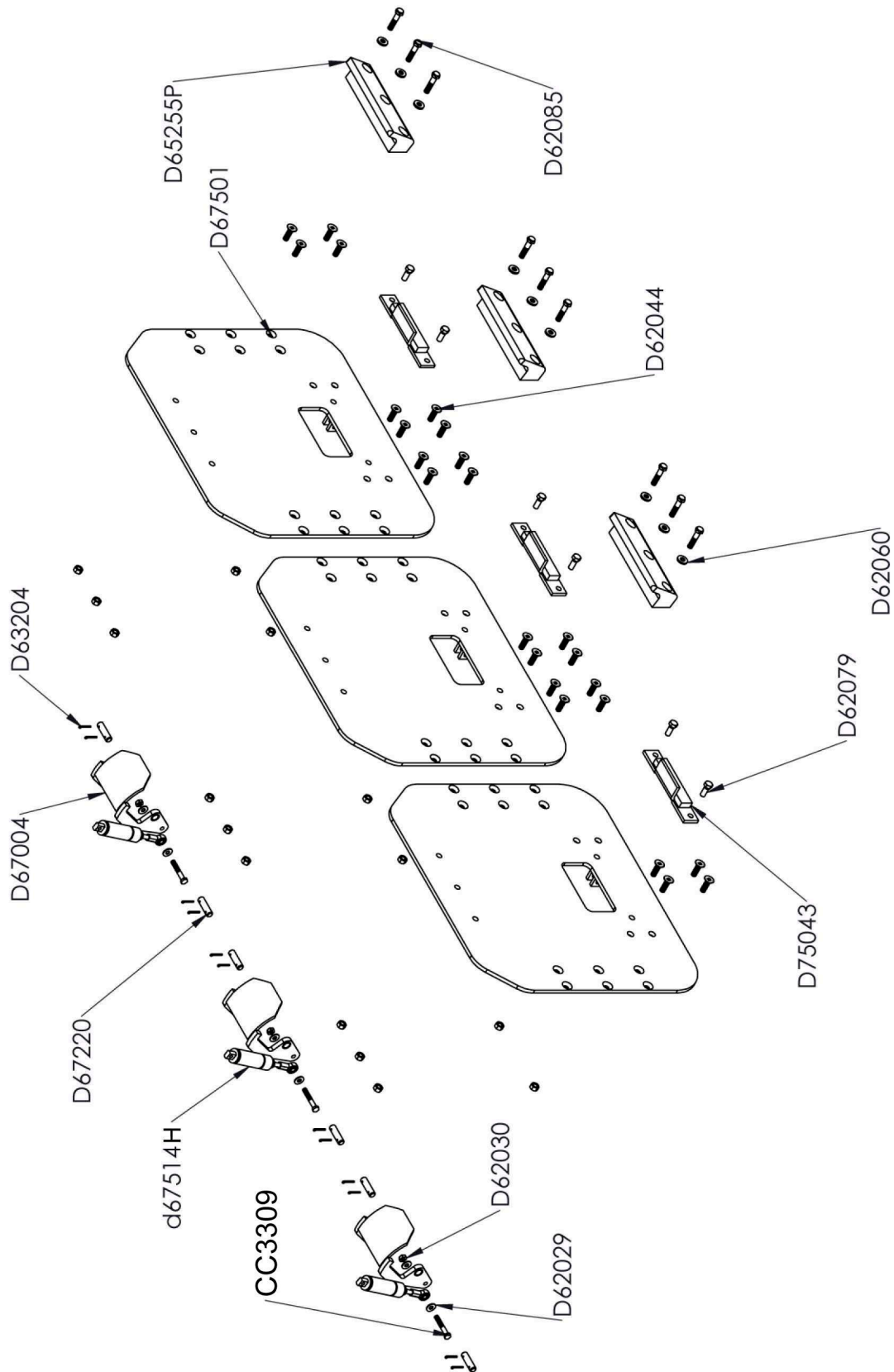

D6064-3 – Exploded Base Frame

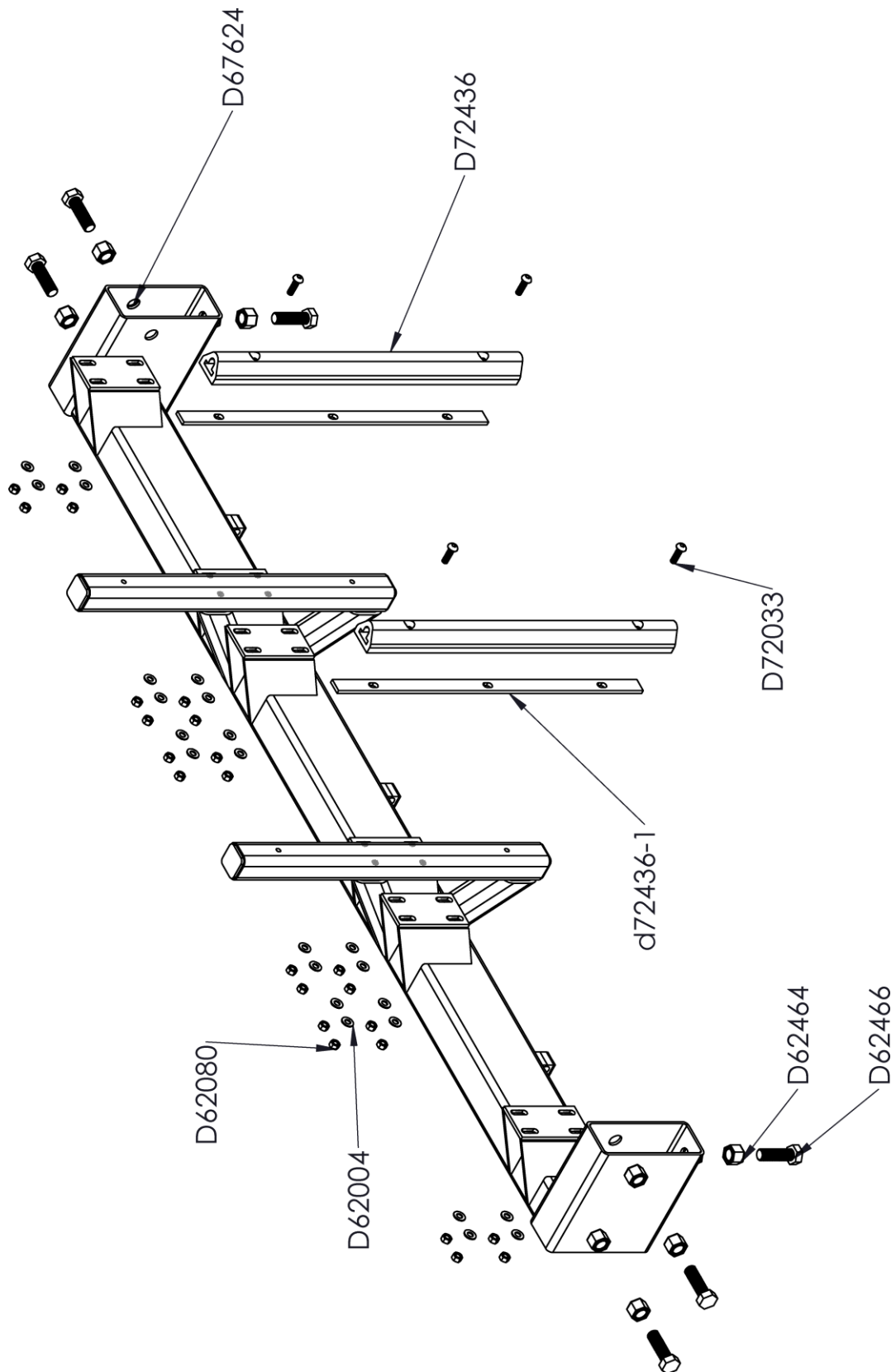

Perkins Manufacturing Company
Creators of the TuckAway® Cart Lifter
www.perkinsmfg.com

800-882-5292

Revised: 4/1/22
Page 19

D6064-M – Exploded Base Frame

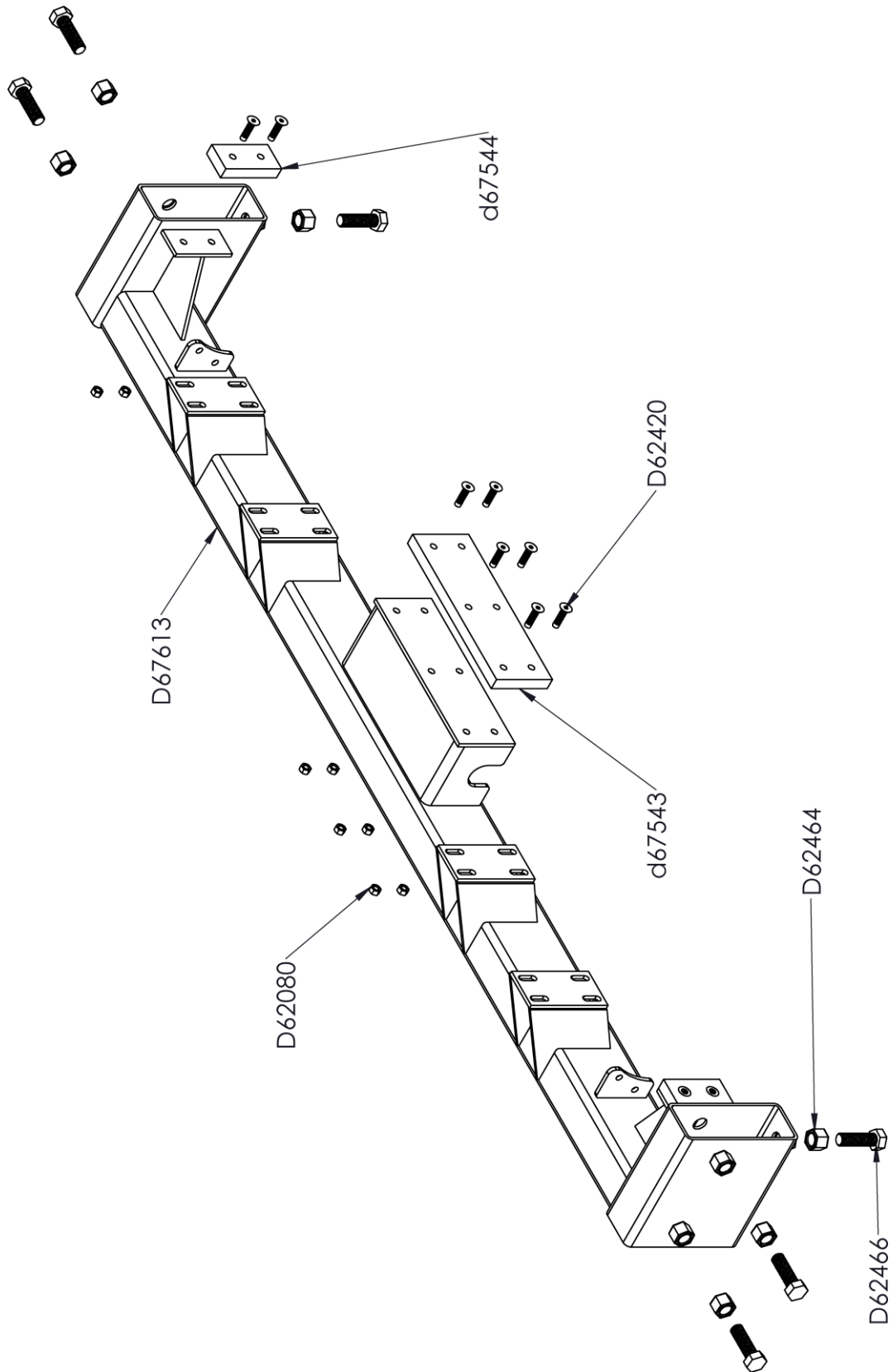

Perkins Manufacturing Company
Creators of the TuckAway® Cart Lifter
www.perkinsmfg.com

800-882-5292

Revised: 4/1/22
Page 20

D6064-M – Exploded Face Plate

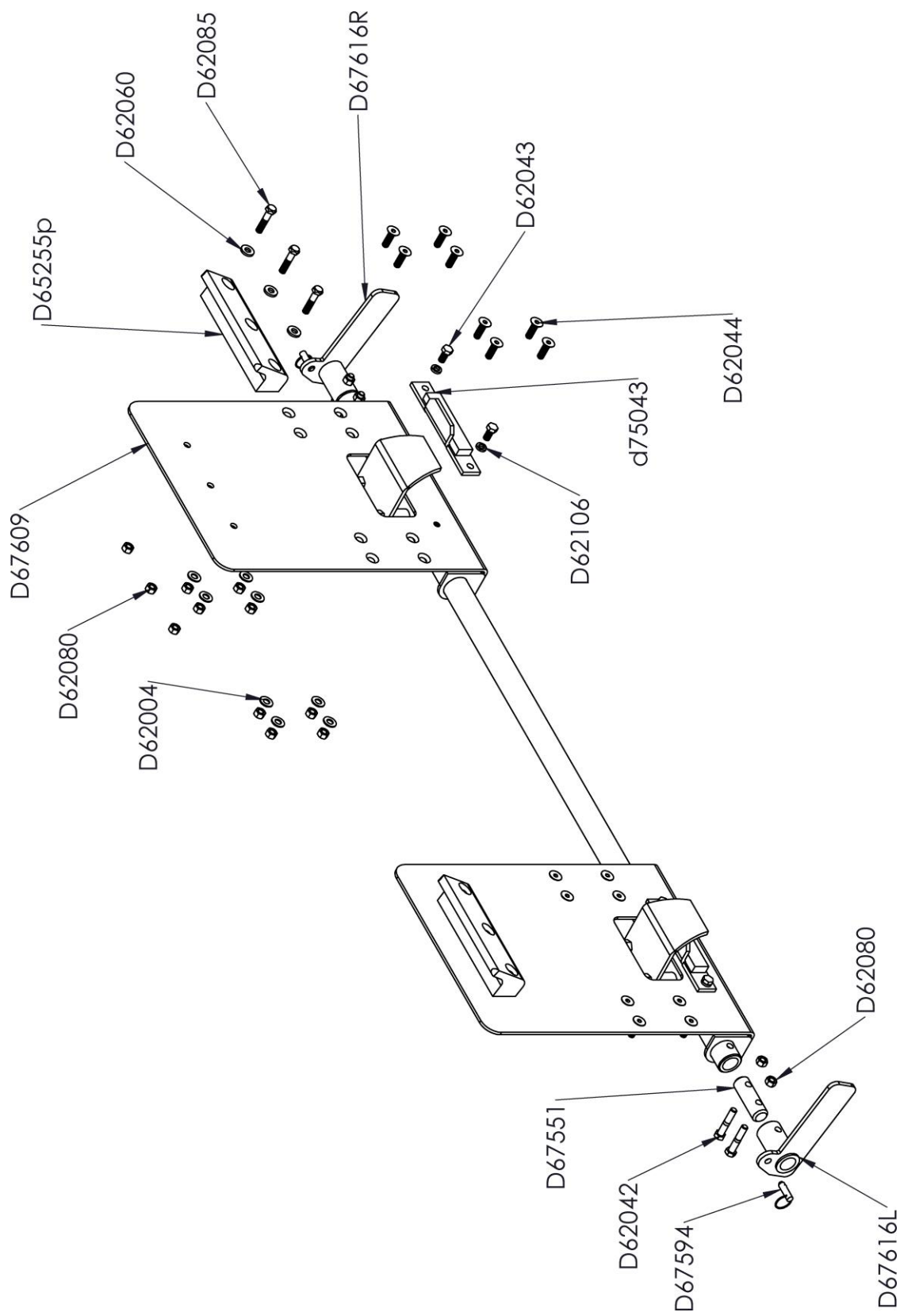

D6064-M – Exploded Manual Latch

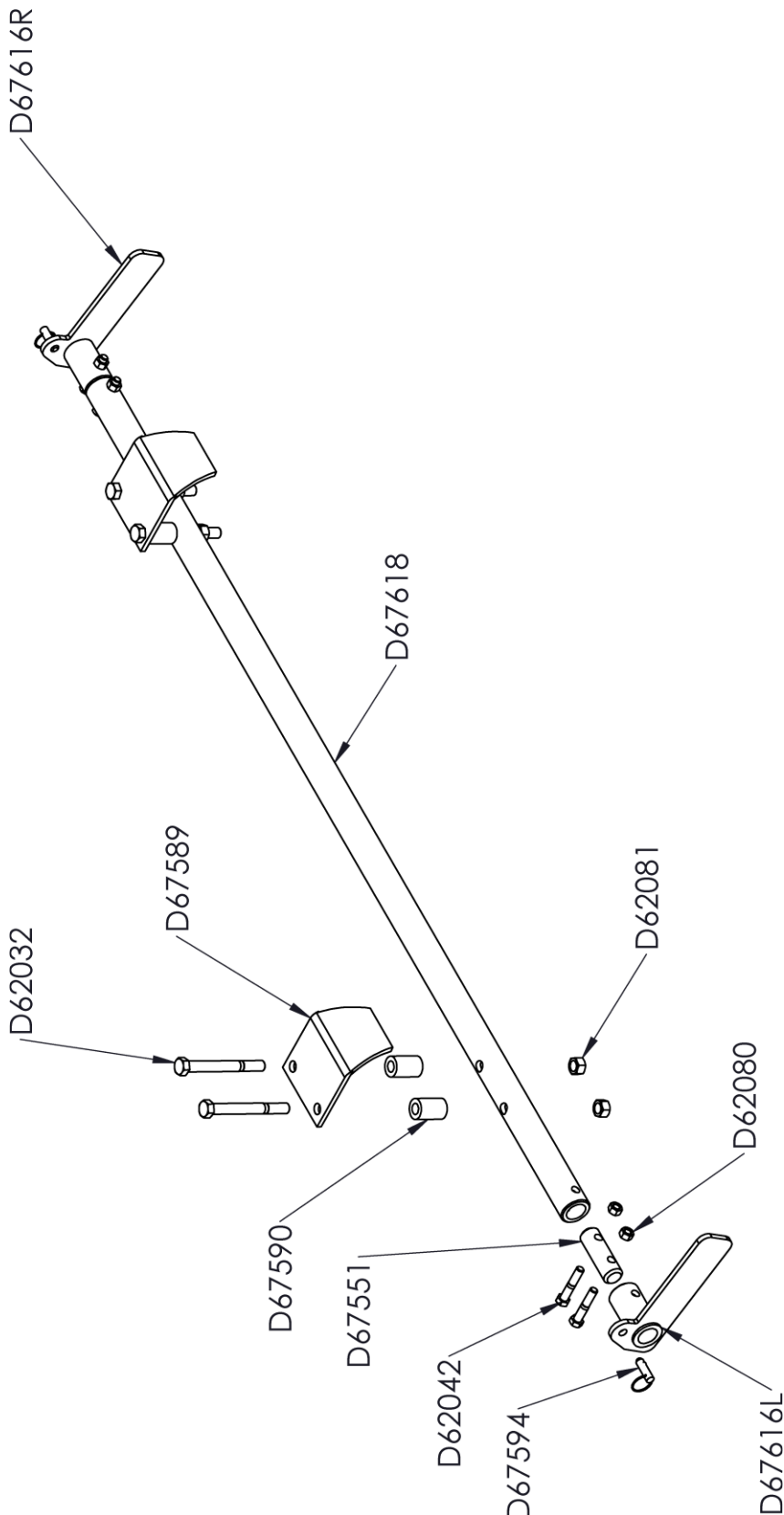

Perkins Manufacturing Company
Creators of the TuckAway® Cart Lifter
www.perkinsmfg.com

800-882-5292

Revised:4/1/22

Page 22

D6064 – Parts List

Item	Description	Qty
D62004	USS FLATWASHER 3/8 X 1 OD ZINC PLATED	16
D62029	SAE FLATWASHER 5/16 x .688 OD (ZINC PLATED)	16
D62030	LOCKNUT 5/16-18 GRADE 8 ZINC PLATED	2
D62044	BOLT FHCS 3/8-16 X 1 1/4 GR8, ZINC PLATED	16
D62060	SAE FLATWASHER 3/8 ID x 13/16 OD X 1/8TH ZINC PLATED	6
D62080	LOCKNUT 3/8-16 GR 8 ZINC PLATED	26
D62085	BOLT HHCS 3/8-16 x 1 3/4 GR8, ZINC PLATED	6
D62413	BOLT HHCS 1/4-20 X 1 GR8 ZINC PLATED	2
D62457	LOCKNUT 1/4-20 GR8 ZINC PLATED	2
D62464	HEX NUT 3/4-10 GRADE 8 ZINC PLATED	6
D62466	BOLT HHCS 3/4-10 X 2 .5, FULLY THREADED, GR8 ZINC PLATED	6
D62474	LABEL-CAUTION (ENG/SPAN)	1
D63204	COTTER PIN 3/32 X 1	8
D63491	SERIAL NUMBER PLATE	1
D65255P	PLASTIC UPPER HOOK (REV B)	2
D67004	LATCH ASSY LOCKING WELD (REV A)	2
D67220	PIN LATCH (REV A)	4
D67501	PLATE FRONT WELD (REV B)	2
D67517	LATCH CYLINDER AIR HOSE (REV A)	2
D67518	BEARING ROD EYE 5/16-24 FEMALE	2
D67520	AIR PIPE 1/4" ID X 18.5" LONG	1
D67521	AIR PIPE 1/4" ID X 38.5" LONG	1
D67522	TEE (AIR LINE) 1/4in ID	1
D67523	ELBOW (AIR LINE) 90 1/4in ID	1
D67525	PNEUMATIC MANUAL LEVER VALVE	1
D67545	FRAME WELDMENT - FOR DUAL FACEPLATES	1
D75043	LOWER STOP-WELD	2
D67576	RUBBER TRUCK BUMPER HALF-BARREL, 4-HOLE	3
D67514H	AIR CYLINDER - SPRING RETURN W/DOUBLE SPRING TENSION	2
D62081	LOCKNUT 1/2-13 GRADE 8 ZINC PLATED	12
D62484	USS FLATWASHER 1/2 x 1.37 OD ZINC PLATED	12
D72042	BOLT HHCS 1/2-13 X 2 1/2, GR8, ZINC PLATED	12
D72009	DRIVE SCREW #6-3/8 PLATED	4
D72113	LABEL - PERKINS LOGO, DIAMOND CUT, 4" LONG X 2 1/2" HIGH,	1
D72589	LABEL - "CAUTION" FOR D6220-TYPE MODELS	1
D72590	LABEL - "CAUTION" FOR D6220-TYPE MODELS - SPANISH	1
CC3309	BOLT HHCS 5/16-18 X 1 3/4 L9 F, ZINC PLATED	2
D62079	BOLT HHCS 3/8-16 X 1 GR8 ZINC PLATED	4
D72631	LABEL - "MADE IN THE USA"	1



D6064B – Parts List

Item	Description	Qty
D62004	USS FLATWASHER 3/8 X 1 OD ZINC PLATED	16
D62029	SAE FLATWASHER 5/16 x .688 OD (ZINC PLATED)	16
D62030	LOCKNUT 5/16-18 GRADE 8 ZINC PLATED	2
D62044	BOLT FHCS 3/8-16 X 1 1/4 GR8, ZINC PLATED	16
D62060	SAE FLATWASHER 3/8 ID x 13/16 OD X 1/8TH ZINC PLATED	6
D62080	LOCKNUT 3/8-16 GR 8 ZINC PLATED	28
D62085	BOLT HHCS 3/8-16 x 1 3/4 GR8, ZINC PLATED	6
D62413	BOLT HHCS 1/4-20 X 1 GR8 ZINC PLATED	2
D62457	LOCKNUT 1/4-20 GR8 ZINC PLATED	2
D62474	LABEL-CAUTION (ENG/SPAN)	1
D63204	COTTER PIN 3/32 X 1	8
D63491	SERIAL NUMBER PLATE	1
D65255P	PLASTIC UPPER HOOK (REV B)	2
D67004	LATCH ASSY LOCKING WELD (REV A)	2
D67220	PIN LATCH (REV A)	4
D67501	PLATE FRONT WELD (REV B)	2
D67517	LATCH CYLINDER AIR HOSE (REV A)	2
D67518	BEARING ROD EYE 5/16-24 FEMALE	2
D67520	AIR PIPE 1/4" ID X 18.5" LONG	1
D67521	AIR PIPE 1/4" ID X 38.5" LONG	1
D67522	TEE (AIR LINE) 1/4in ID	1
D67523	ELBOW (AIR LINE) 90 1/4in ID	1
D67525	PNEUMATIC MANUAL LEVER VALVE	1
D67608	MTG BRACKET WELD - 3 1/2 C.BAR	4
D75043	LOWER STOP-WELD	2
D67514H	AIR CYLINDER - SPRING RETURN W/DOUBLE SPRING TENSION AND LONGER BODY	2
D72148	HOSE CLAMP SET (DUAL) #6 HOSE	2
D62079	BOLT HHCS 3/8-16 X 1 GR8 ZINC PLATED	4
CC3309	BOLT HHCS 5/16-18 X 1 3/4 L9 F, ZINC PLATED	2



D6064-3 – Parts List

Item	Description	Qty
D62004	USS FLATWASHER 3/8 X 1 OD ZINC PLATED	24
D62029	SAE FLATWASHER 5/16 x .688 OD (ZINC PLATED)	16
D62030	LOCKNUT 5/16-18 GRADE 8 ZINC PLATED	3
D62044	BOLT FHCS 3/8-16 X 1 1/4 GR8, ZINC PLATED	24
D62060	SAE FLATWASHER 3/8 ID x 13/16 OD X 1/8TH ZINC PLATED	9
D62080	LOCKNUT 3/8-16 GR 8 ZINC PLATED	10
D62085	BOLT HHCS 3/8-16 x 1 3/4 GR8, ZINC PLATED	9
D62413	BOLT HHCS 1/4-20 X 1 GR8 ZINC PLATED	3
D62457	LOCKNUT 1/4-20 GR8 ZINC PLATED	3
D62464	HEX NUT 3/4-10 GRADE 8 ZINC PLATED	6
D62466	BOLT HHCS 3/4-10 X 2 .5, FULLY THREADED, GR8 ZINC PLATED	6
D62474	LABEL-CAUTION (ENG/SPAN)	1
D63204	COTTER PIN 3/32 X 1	12
D63491	SERIAL NUMBER PLATE	1
D65255P	PLASTIC UPPER HOOK (REV B)	3
D67004	LATCH ASSY LOCKING WELD (REV A)	3
D67220	PIN LATCH (REV A)	6
D67501	PLATE FRONT WELD (REV B)	3
D67517	LATCH CYLINDER AIR HOSE (REV A)	3
D67518	BEARING ROD EYE 5/16-24 FEMALE	3
D67520	AIR PIPE 1/4" ID X 18.5" LONG	1
D67522	TEE (AIR LINE) 1/4in ID	2
D67523	ELBOW (AIR LINE) 90 1/4in ID	1
D67525	PNEUMATIC MANUAL LEVER VALVE	1
D67624	3-FACEPLATE FRAME WELD (REV A)	1
D72033	BOLT BHCS 3/8-16 X 1 1/4, GR 8, ZINC PLATED	4
D72436	VESTIL RUBBER BUMPER 2 x 24	2
D72436-1	BUMPER INSERT, VESTIL BUMPER	2
D75043	LOWER STOP-WELD	3
D67514H	AIR CYLINDER - SPRING RETURN W/DOUBLE SPRING TENSION AND LONGER BODY	3



Item	Description	Qty
D62004	USS FLATWASHER 3/8 X 1 OD ZINC PLATED	8
D62029	SAE FLATWASHER 5/16 x .688 OD (ZINC PLATED)	7
D62030	LOCKNUT 5/16-18 GRADE 8 ZINC PLATED	1
D62044	BOLT FHCS 3/8-16 X 1 1/4 GR8, ZINC PLATED	8
D62060	SAE FLATWASHER 3/8 ID x 13/16 OD X 1/8TH ZINC PLATED	3
D62080	LOCKNUT 3/8-16 GR 8 ZINC PLATED	14
D62085	BOLT HHCS 3/8-16 x 1 3/4 GR8, ZINC PLATED	3
D62413	BOLT HHCS 1/4-20 X 1 GR8 ZINC PLATED	1
D62457	LOCKNUT 1/4-20 GR8 ZINC PLATED	1
D62474	LABEL-CAUTION (ENG/SPAN)	1
D63204	COTTER PIN 3/32 X 1	4
D63491	SERIAL NUMBER PLATE	1
D65255P	PLASTIC UPPER HOOK (REV B)	1
D67004	LATCH ASSY LOCKING WELD (REV A)	1
D67220	PIN LATCH (REV A)	2
D67501	PLATE FRONT WELD (REV B)	1
D67517	LATCH CYLINDER AIR HOSE (REV A)	1
D67518	BEARING ROD EYE 5/16-24 FEMALE	1
D67520	AIR PIPE 1/4" ID X 18.5" LONG	1
D67523	ELBOW (AIR LINE) 90 1/4in ID	1
D67525	PNEUMATIC MANUAL LEVER VALVE	1
D67608	MTG BRACKET WELD - 3 1/2 C.BAR	2
D75043	LOWER STOP-WELD	1
D67514H	AIR CYLINDER - SPRING RETURN W/DOUBLE SPRING TENSION AND LONGER BODY	1
CC3309	BOLT HHCS 5/16-18 X 1 3/4 L9 F, ZINC PLATED	1
D72148	HOSE CLAMP SET (DUAL) #6 HOSE	1



Item	Description	Qty
D62004	USS FLATWASHER 3/8 X 1 OD ZINC PLATED	8
D62030	LOCKNUT 5/16-18 GRADE 8 ZINC PLATED	1
D62044	BOLT FHCS 3/8-16 X 1 1/4 GR8, ZINC PLATED	8
D62060	SAE FLATWASHER 3/8 ID x 13/16 OD X 1/8TH ZINC PLATED	3
D62080	LOCKNUT 3/8-16 GR 8 ZINC PLATED	14
D62085	BOLT HHCS 3/8-16 x 1 3/4 GR8, ZINC PLATED	3
D62413	BOLT HHCS 1/4-20 X 1 GR8 ZINC PLATED	1
D62457	LOCKNUT 1/4-20 GR8 ZINC PLATED	1
D62464	HEX NUT 3/4-10 GRADE 8 ZINC PLATED	6
D62466	BOLT HHCS 3/4-10 X 2 .5, FULLY THREADED, GR8 ZINC PLATED	6
D62474	LABEL-CAUTION (ENG/SPAN)	1
D63204	COTTER PIN 3/32 X 1	4
D63491	SERIAL NUMBER PLATE	1
D65255P	PLASTIC UPPER HOOK (REV B)	1
D67004	LATCH ASSY LOCKING WELD (REV A)	1
D67220	PIN LATCH (REV A)	2
D67501	PLATE FRONT WELD (REV B)	1
D67517	LATCH CYLINDER AIR HOSE (REV A)	1
D67518	BEARING ROD EYE 5/16-24 FEMALE	1
D67521	AIR PIPE 1/4" ID X 38.5" LONG	1
D67523	ELBOW (AIR LINE) 90 1/4in ID	1
D67525	PNEUMATIC MANUAL LEVER VALVE	1
D75043	LOWER STOP-WELD	1
D67514H	AIR CYLINDER - SPRING RETURN W/DOUBLE SPRING TENSION AND LONGER BODY	1
D67545-1	SINGLE FACEPLATE FRAME WELDMENT (REV A)	1
D67576	RUBBER TRUCK BUMPER HALF-BARREL, 4-HOLE	2
D62112	BOLT HHCS 1/2-13 x 2 1/4 GR8, ZINC PLATED	8
D62484	USS FLATWASHER 1/2 x 1.37 OD ZINC PLATED	8
D62081	LOCKNUT 1/2-13 GRADE 8 ZINC PLATED	8
D72009	DRIVE SCREW #6-3/8 PLATED	4



D6064-M – Parts List

Item	Description	Qty
D62004	USS FLATWASHER 3/8 X 1 OD ZINC PLATED	16
D62032	BOLT HHCS 1/2-13 X 4 1/2 GR8, ZINC PLATED	4
D62042	BOLT HHCS 3/8-16 X 2 GRADE 8 ZINC PLATED	4
D62044	BOLT FHCS 3/8-16 X 1 1/4 GR8, ZINC PLATED	16
D62060	SAE FLATWASHER 3/8 ID x 13/16 OD X 1/8TH ZINC PLATED	6
D62080	LOCKNUT 3/8-16 GR 8 ZINC PLATED	36
D62081	LOCKNUT 1/2-13 GRADE 8 ZINC PLATED	4
D62085	BOLT HHCS 3/8-16 x 1 3/4 GR8, ZINC PLATED	6
D62420	BOLT FHCS 3/8-16 X 1 1/2 GR8, ZINC PLATED	10
D62464	HEX NUT 3/4-10 GRADE 8 ZINC PLATED	6
D62466	BOLT HHCS 3/4-10 X 2 .5, FULLY THREADED, GR8 ZINC PLATED	6
D62474	LABEL-CAUTION (ENG/SPAN)	1
D63491	SERIAL NUMBER PLATE	1
D65255P	PLASTIC UPPER HOOK (REV B)	2
D67543	RUBBER PAD, (REV B)	1
D67544	SM. RUBBER PAD (REV B)	2
D67551	PIN - CONNECTOR	2
D67589	LOWER LATCH (REV A)	2
D67590	LATCH MTG BOSS	4
D67594	QUICK RELEASE PIN	2
D67609	FACEPLATE WELD	2
D67613	FRAME WELD	1
D67618	LATCH TUBE	1
D75043	LOWER STOP-WELD	2
D67549	SM. STOP PLATE	2
D67542	CENTER PAD PLATE	1
D67616L	HANDLE WELD	1
D67616R	HANDLE WELD	1
D62043	BOLT HHCS 3/8-16 X 3/4 GR8, ZINC PLATED	4
D62106	SPLIT LOCKWASHER 3/8" ZINC PLATED	4



Protective Safety Labeling

Perkins provides each finished cart lifter with ANSI-specified caution labels. They are clearly placed directly on the machine for easy viewing by the operators.

Should the cart lifter ever be re-painted, or if the labels are damaged beyond recognition, it is advised to replace the labels immediately to help keep your crew safe.

OHSA always requires these labels to be in clear sight on the machine.

Responsibility to maintain proper caution and warning labels is the responsibility of the end-user.



Maintaining the lifter is vital to ensure proper operation of the equipment and for warranty to be valid. Inspection of the lifter is also important to make sure there are no loose parts and that the lifter is properly greased. Not inspecting or maintaining the machine regularly can pose a hazard of parts coming loose, parts not moving properly or wear items to become too worn to not move properly. If any issues occur, please contact service immediately.

Dress appropriately for work with pants and sleeves that are not too long or too loose. Shirts should be fitted or tucked in. Avoid wearing loose and dangling jewelry. Tie back long hair and tuck braids and ponytails behind you or into your clothing. Wear the appropriate, well-fitting gloves for your job.

Look for possible pinch points before you start a task. Take the time to plan out your actions and decide on the necessary steps to work safely. Read and follow warning signs posted on equipment.

Machinery can pose a hazard with moving parts, conveyors, rollers, and rotating shafts. NEVER reach into a moving machine. Turn equipment off and use lockout/tagout procedures before adjusting, clearing a jam, repairing, or servicing a machine.



Safety Labeling and Training Requirements

Perkins provides safety labeling on all outgoing product per ANSI regulations, seen below.

19-01 Warning, Label and Safety Instructions.

Include standard safety instructions as one of the first items in a manual. This helps emphasize safe use of the product and can help the user understand the hazards, the consequences of the hazards and how to avoid the hazards. Priority placement also increases the likelihood that the information will be read. Any symbols or pictograms physically on the product should be included in the appropriate section of the manual to reinforce the association between the nature and severity of the hazard and the correct behavior.

The American National Standards Institute (ANSI) standard Z535.6, *Product Safety Information in Product Manuals, Instructions, and Other Collateral Materials*, should also be applied.

To help ensure the product user sees and understands warnings and safety instructions, you should make them conspicuous. It is critical that you make proper use of the signal words "*danger*", "*warning*", "*caution*" and "*notice*" and their corresponding signal colors *red*, *orange*, *yellow*, and *blue*.

Choosing the appropriate signal words and colors are based on an estimate of the likelihood of exposure to the hazardous situation and what could happen as a result of exposure to the hazard. The American National Standards Institute (ANSI) standard Z535.4, *Product Safety Signs and Labels*, defines the hazard signal words as follows:

DANGER: Indicates an imminently hazardous situation which, if not avoided, "will" result in death or serious injury. This signal word is to be limited to the most extreme situations.

WARNING: Indicates a potentially hazardous situation which, if not avoided, "could" result in death or serious injury.

CAUTION: Indicates a potentially hazardous situation, which, if not avoided, "may" result in minor or moderate injury. It may also be used to alert against unsafe practices.

NOTICE: Indicates information considered important, but not hazard related (e.g., messages relating to property damage).

It is the responsibility of owner of this product to maintain the safety labels, keep them clear & visible to all users, and replace the safety labels when they become worn or missing.

All users must read and understand this manual and the safety precautions before using this product.



Perkins Manufacturing Company
Creators of the TuckAway® Cart Lifter
www.perkinsmfg.com

800-882-5292

Revised: 08/08/23
Addendum

Manufacturing Company

Perkins Warranty Procedure

This procedure for claiming warranty must be followed or warranty will not be approved, credit will not be issued, and replacement parts will not be shipped. This document is not a replacement for the warranty policy. Please refer to the last page of your manual, which describes the warranty policy in detail.

If you believe your Perkins lifter has suffered from a failure that could be covered by warranty, immediately lock out any equipment that has failed per OSHA guidelines.

Take photographs of the lifter, including overall views of the unit and some close-ups, as necessary to properly record the failure in a way our engineering staff can examine. While taking photos of the lifter, record the serial number of the lifter.

Call Perkins at (800) 882-5292 and ask to speak to the service department. Requests for warranty can also be emailed to svaldez@perkinsmfg.com. Attach any photos to the email, as necessary. The service department will use the photos to determine if the return of parts for inspection is necessary or not. If the return of parts is required, the service department will issue you an RGA number.

Your replacement parts will be shipped at the time of your warranty request, but they will require a purchase order number/payment in order to ship. (Credit will be issued later, after warranty status is determined.) Your replacement parts will feature RGA numbers on the documentation referencing your warranty request. Replacements are sent UPS ground. For faster shipping, the customer will be charged.

Clearly mark the box of any returns with the provided RGA number in a prominent place. This helps our shippers identify your items. When your returned parts arrive, our service and engineering teams will inspect your shipment and determine if the failure is a defect covered by the warranty or not. If the item(s) are covered by warranty, credit will be issued. If the item(s) were not covered by warranty, a report will be generated that fully describes the reasoning behind the decision.

Common Warranty Mistakes:

Please do not ship lifters/parts to Perkins without first obtaining an RGA number. Parts received without prior authorization or without RGA markings will be discarded and credit will not be issued.

Orders that are placed without discussing warranty status will be treated as a typical order and will be billed accordingly. Credit will not be issued for warranty requests after the order is placed.

No warranty is allowed on lifters/parts not having a serial number.



Manufacturing Company

Perkins Return Policy:

If, within 30 days of receipt of the item(s), a customer would like to return an unused item(s), the customer may contact Perkins for a return authorization (RGA#). The item must be shipped within 2 weeks of the return authorization. The customer will pay the return freight and a 15% restocking fee on the return(s). The item must be in new / unused condition, and any damage or clean up required to restore the product to resalable condition will be charged to the customer.

Packages received without an RGA# on the packaging identifying who the product is from may be discarded or refused and credit may not be issued. Always make sure the RGA# is displayed on the box and on any included paperwork.

If Perkins shipped the wrong item(s), the incorrect item(s) may be returned within 30 days of receipt of the item by contacting Perkins for a return authorization (RGA#). The item(s) must be shipped within 2 weeks of the return authorization. Perkins will pay the return freight and waive the restocking fee.

If the return results in a net debit, the customer will be invoiced. If the return results in a net credit, the credit can be used against the replacement item(s) or a future purchase.

Special Notes:

Perkins does offer customized solutions and due to the customization of these items, Perkins cannot accept returns or refunds on anything custom ordered. This includes industrial units, cane lifters, and other items which have been specially fabricated to the customer's specifications. Unfortunately returns on these products cannot be accepted.

Perkins Manufacturing One-Year Limited Warranty

PERKINS MANUFACTURING COMPANY warrants its products to be free from defects in material and workmanship under normal use for a period of **one (1) year** from the date of delivery to the first purchaser.

Any claim under this warranty must be handled in accordance with PERKINS' warranty procedure.

This warranty is expressly limited to the repair or replacement in PERKINS' discretion of any component or part of any PERKINS product unit manufactured by PERKINS which is brought to PERKINS attention promptly after discovery and is proven to PERKINS' satisfaction to have been defective in material or workmanship.

This warranty shall not obligate PERKINS to bear the cost of labor or transportation charges in connection with the repair or replacement of defective parts, and it shall not apply to a product upon which repairs, or alterations have been made unless authorized in writing by PERKINS.

Any damage, wear & tear or improper use, substitution of parts not approved by PERKINS, modifications other than those done by PERKINS or as authorized in writing by PERKINS, or any alteration or repair by others in such a manner which, in PERKINS' judgment, materially and adversely affects the product shall void this warranty. Operation at an actuator cycle time of less than six seconds shall void this warranty. Wear items used for anti-friction purposes are not covered by this warranty.

Periodic maintenance is required in order to maintain warranty but is not covered by warranty. Please refer to the maintenance section of the service manual for instructions.

PERKINS makes no warranty of products manufactured by others and supplied by PERKINS, the same being subject to warranties, if any, of their respective manufacturers.

PERKINS shall not assume any liability for any incidental, consequential, direct, or indirect damage, loss or delay of any kind, including, but not limited to, the loss of profits, product or downtime.

PERKINS warrants any service parts it may sell for a period of ninety (90) day from the date of delivery for replacement only. The item being replaced must be returned to PERKINS for evaluation upon its request. The cost of labor to replace such part shall be the responsibility of the owner. PERKINS does not warrant any used parts.

PERKINS, whose policy is one of continuous improvement, reserves the right to improve its products through changes in design or materials as it may deem desirable without obligation to incorporate such changes in products of prior manufacture.

THE ABOVE WARRANTY SUPERCEDES AND IS IN LIEU OF ALL OTHER EXPRESS OR IMPLIED WARRANTIES INCLUDING, WITHOUT LIMITING, ANY IMPLIED WARRANTIES OF MERCHANTABILITY OR FITNESS FOR A PARTICULAR PURPOSE. NO EMPLOYEE OR ANY OTHER REPRESENTATIVE OF PERKINS IS AUTHORIZED TO CHANGE THIS WARRANTY IN ANY WAY OR TO GRANT ANY OTHER WARRANTY. THESE TERMS WILL BE CONSTRUED ACCORDING TO THE LAWS OF THE STATE OF ILLINOIS WITHOUT REGARD TO ITS CONFLICTS OF LAWS PROVISIONS. ALL ACTIONS OR PROCEEDINGS IN ANY WAY, MANNER OR RESPECT ARISING OUT OF OR RELATED TO THE GOODS WILL BE LITIGATED ONLY IN STATE OR FEDERAL COURTS, AS APPROPRIATE, LOCATED IN WILL COUNTY, ILLINOIS. BUYER CONSENTS AND SUBMITS TO JURISDICTION IN THE STATE OF ILLINOIS AND WAIVES ANY RIGHT TO TRANSFER THE VENUE OF ANY SUCH ACTION OR PROCEEDING.