



Sweep Lids Installation & Operational Manual for 6-yard and 8-yard Satellites.

Full Size & 50/50

**6 Yard Satellite with Full Size Body and
Sweep Lid.**



**8 Yard Satellite with 50/50 Body
and Sweep Lid.**



Perkins Manufacturing Company
Creators of the TuckAway® Cart Lifter
www.perkinsmfg.com

800-882-5292

Revise: 12/19/23

Page 1 of 44

Sweep Lid Only, Specifications

Cart Compatibility	N/A
Typical Mounting Application	To mount on 6 yard or 8 yard Perkins Satellite
Flow Rate Requirement	1.5 gpm (12 VDC pump), 3 gpm (24 pump), 8 gpm (PTO & Pump).
Cycle Time of Sweep Lid	
Cycle Time of Dump Body	N/A
Recommended Pressure Setting	1,200 psi at the pressure relief valve
Mounting Height	Top of Satellite body.
Approximate Unit Weight (not counting packaging)	1,000 lbs.
Warranty	1 year limited warranty. See warranty page for details***

Perkins regularly makes product improvements. Specifications are subject to change without notice.

*** See Warranty page enclosed in this manual for full details of coverage



Perkins Manufacturing Company
Creators of the TuckAway® Cart Lifter
www.perkinsmfg.com

800-882-5292

Revise: 4/26/22
Page **2** of **44**

ORIENTATION OF LEFT AND RIGHT HAND SIDES

To eliminate any confusion when discussing “left” and “right”, please see graphic below. Left and Right is that of the observer, when viewing the machine from the front of the machine.

**AS VIEWED WHEN LOOKING
AT THE FRONT OF THE LIFTER.**

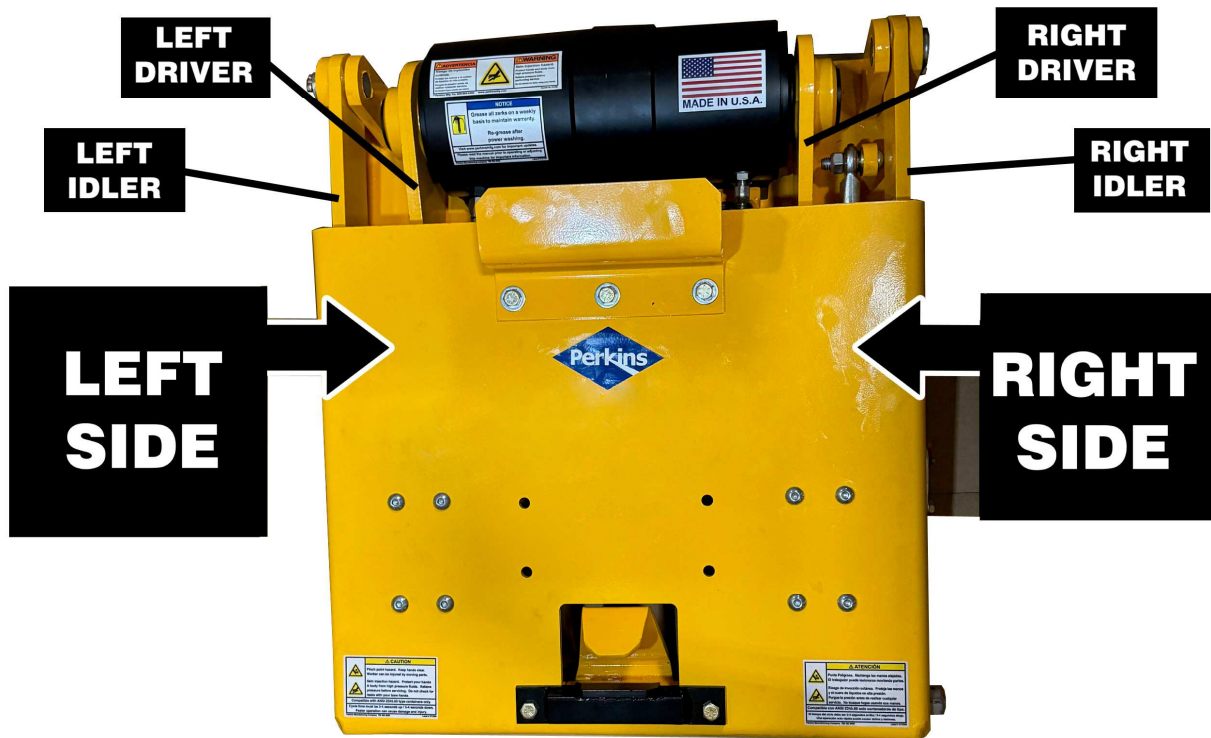

Drivers are always connected to the actuator hubs.

Idlers are not connected to the actuator.

Lifter shown is for example only. Your model may vary in appearance.



Perkins Manufacturing Company
Creators of the TuckAway® Cart Lifter
www.perkinsmfg.com

800-882-5292

Revised: 11/15/23
Addendum

Please be aware of the risks of working with welding equipment and consumables. Always use safety protection equipment. The sparks may ignite fire, always clean the area from flammable material or flammable chemicals, do not weld close to gas lines or on top of electrical cords or installations. Disconnect battery cables from the battery and make sure the vehicle is perfectly grounded prior to attempt to do any weld. Always weld in a ventilated area.



WHEN WELDING, WEAR APPROPRIATE EYE AND SKIN PROTECTION. WELDING LIGHT CAN BLIND. WELDING LIGHT CAN SUNBURN THE SKIN. LONG TERM EXPOSURE TO WELDING LIGHT CAN CAUSE CANCERS. ALWAYS WEAR PPE WHEN WELDING. PROPER PPE SHOULD ALSO BE WORN BY ANYONE IN THE THE WORK ZONE WHO MIGHT ALSO BE EXPOSED.



Correct and safe electric welding station

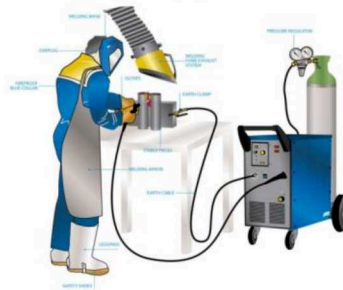

HYDRAULIC SYSTEMS CAN LEAK OUT HIGH PRESSURE WHICH CAN CAUSE SERIOUS INJURY, GANGRENE OR DEATH. DO NOT CHECK FOR LEAKS WITH YOUR BARE HANDS AND AVOID CONTACT WITH LEAKING OIL STREAMS.

HYDRAULIC OIL CAN ENTER THE BLOODSTREAM. SEEK MEDICAL ATTENTION IMMEDIATELY IF YOUR SKIN IS PUNCTURED BY HYDRAULIC OIL.

HYDRAULIC SYSTEMS CAN BECOME HOT (GENERALLY UP TO 170-180 DEG. F.) TO AVOID BURNS, DO NOT TOUCH VALVES, ACTUATORS, CYLINDERS, AND OTHER HOT COMPONENTS, EVEN AFTER THE SYSTEM IS SHUT OFF IT WILL REMAIN HOT AND TAKE TIME TO COOL DOWN.

ALWAYS TURN OFF A SYSTEM BEFORE SERVICING IT. DEPRESSURIZE THE CIRCUIT BY ACTIVATING THE CONTROLS WITH THE SYSTEM OFF TO RELIEVE ANY BUILT UP PRESSURE.

NEVER WORK UNDER A RAISED LOAD. RAISED EQUIPMENT CAN SUDDENLY FALL WHEN A VALVE OR LINE IS OPENED (LIKE A MOUSETRAP). IF THE EQUIPMENT MUST BE SERVICED IN THE RAISED POSITION, SECURE THE EQUIPMENT WITH CHAIN OR STRAP TO HOLD IT UP SAFETY.



Perkins Manufacturing Company
Creators of the TuckAway® Cart Lifter
www.perkinsmfg.com

800-882-5292 Revised: 8/10/2023

Page 11

Overall Dimensions 6-Yard Full Body (D34000)

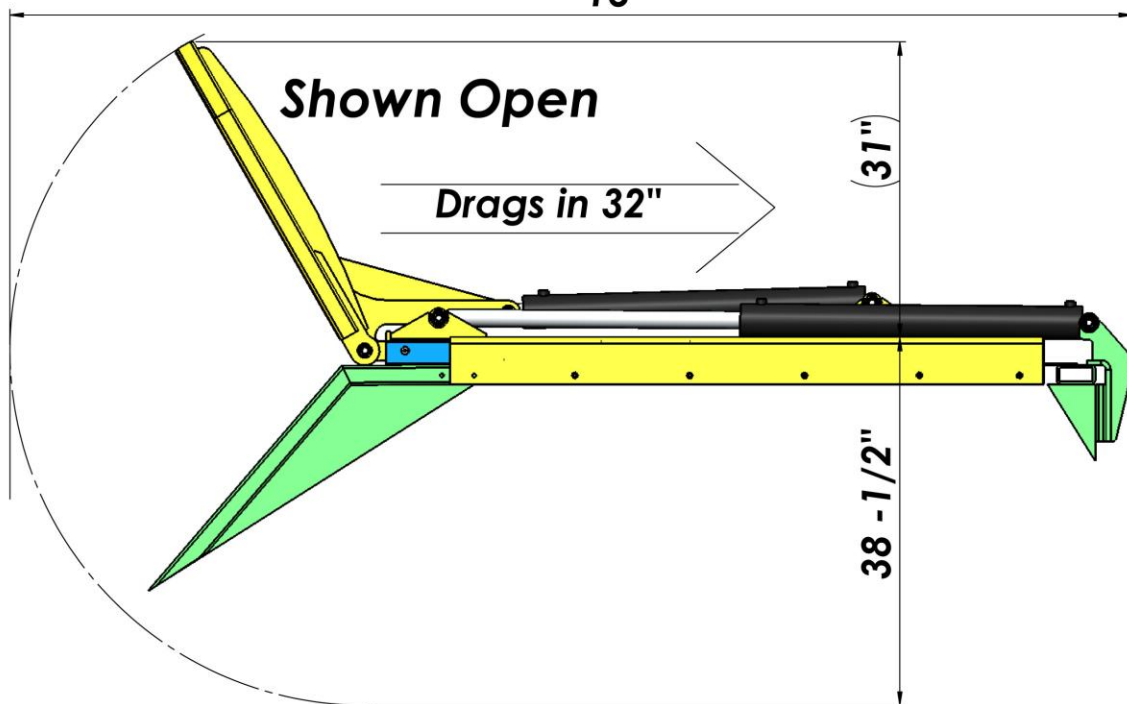
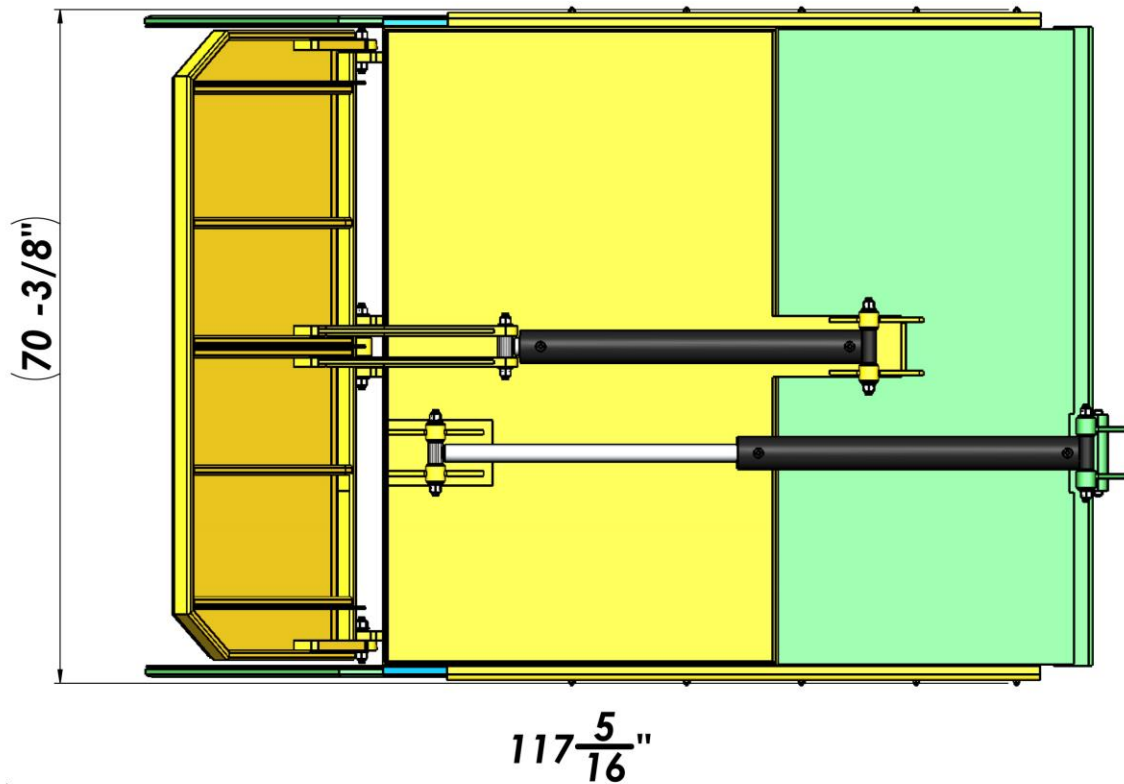

D34000 Weight 900 Lbs

Perkins regularly makes product improvements. Dimensions are subject to change without notice.



Perkins Manufacturing Company
Creators of the TuckAway® Cart Lifter
www.perkinsmfg.com

800-882-5292

Revise: 4/26/22

Page 3 of 44

Overall Dimensions 6-Yard 50/50 (D34065)

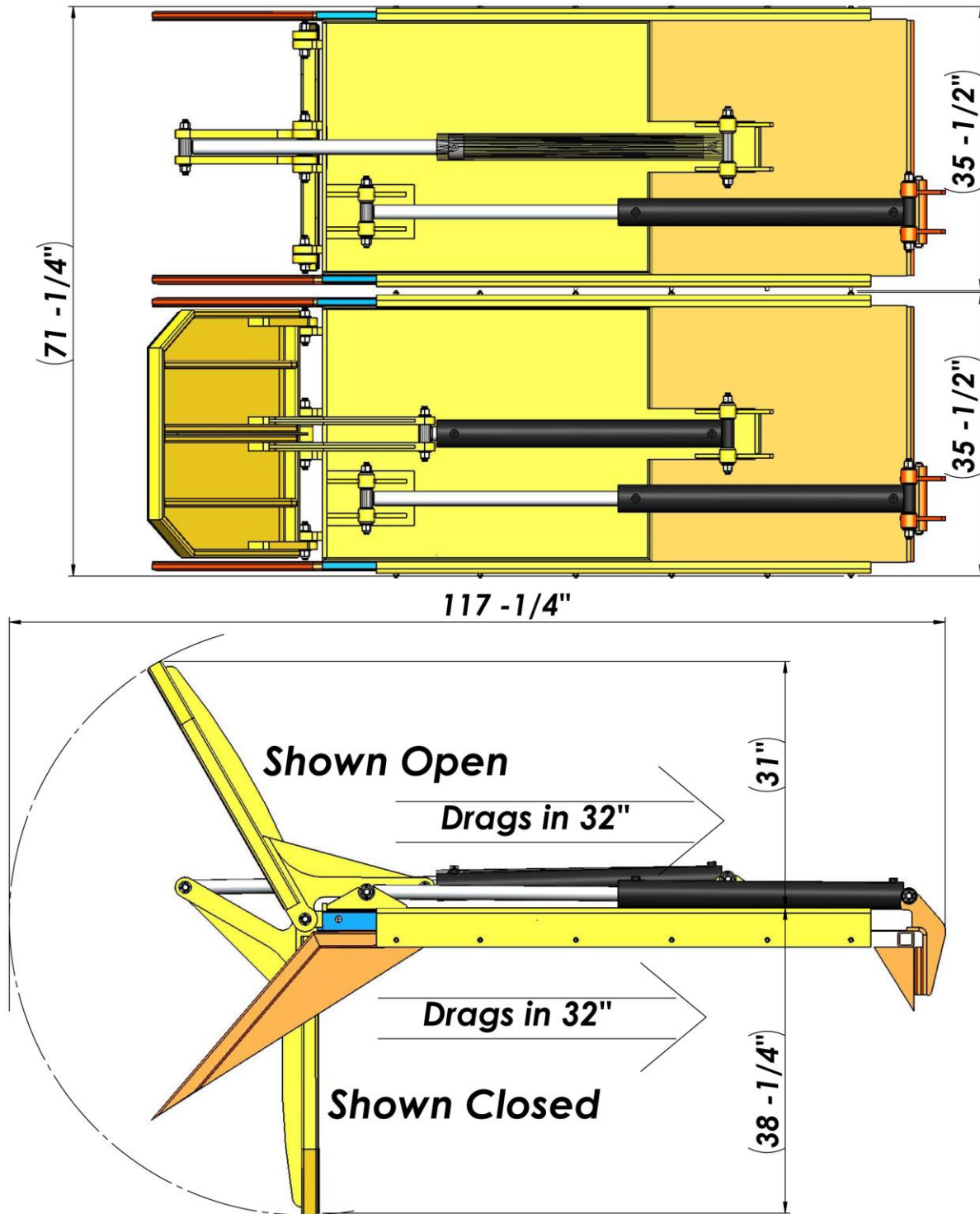

D34065 Weight 1200 Lbs

Perkins regularly makes product improvements. Dimensions are subject to change without notice.



Perkins Manufacturing Company
Creators of the TuckAway® Cart Lifter
www.perkinsmfg.com

800-882-5292

Revise: 4/26/22

Page 4 of 44

Overall Dimensions 8-Yard Full Body (D39715)

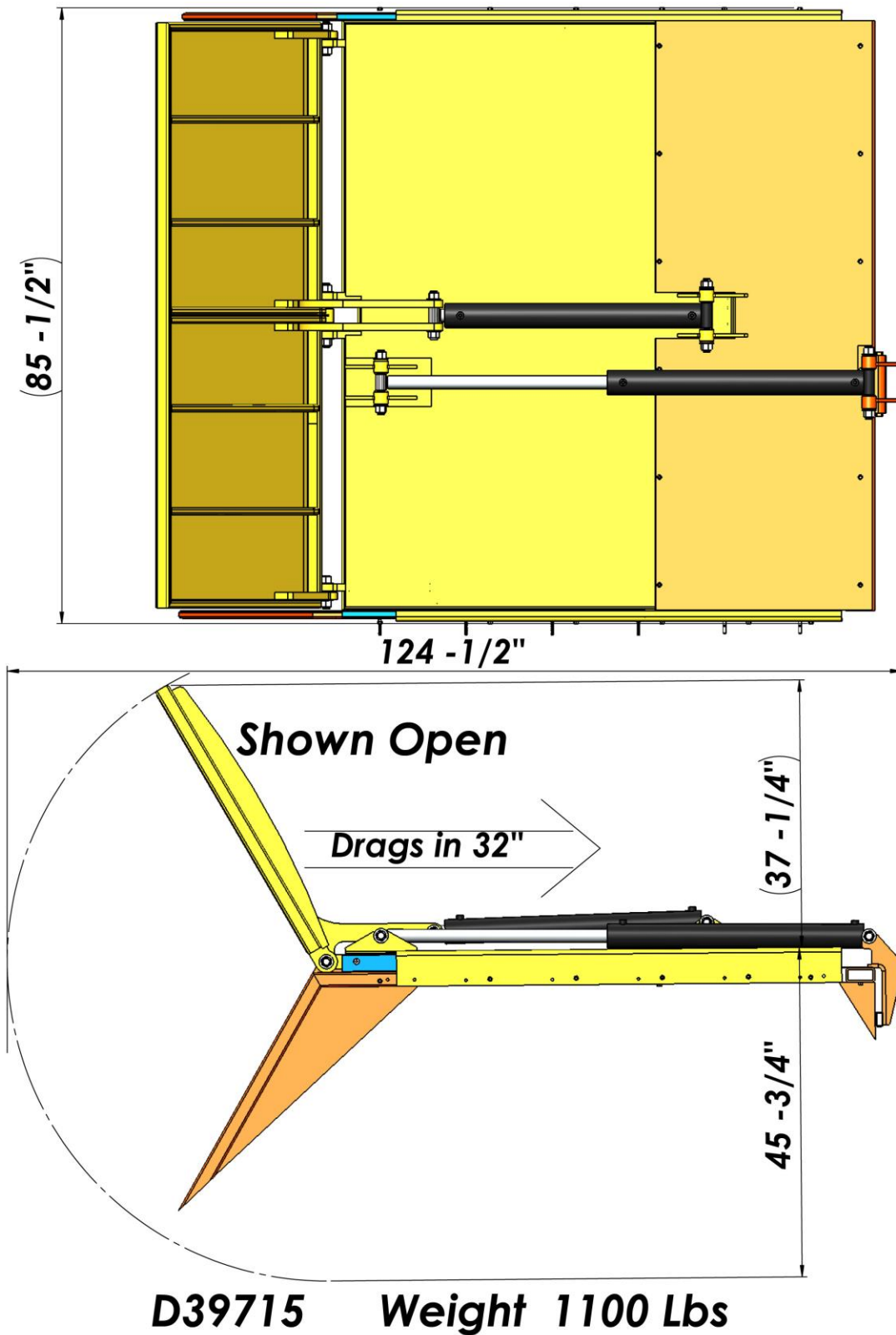

Perkins regularly makes product improvements. Dimensions are subject to change without notice.



Perkins Manufacturing Company
Creators of the TuckAway® Cart Lifter
www.perkinsmfg.com

800-882-5292

Revise: 4/26/22

Page 6 of 44

Overall Dimensions 8-Yard 50/50 (D39730)

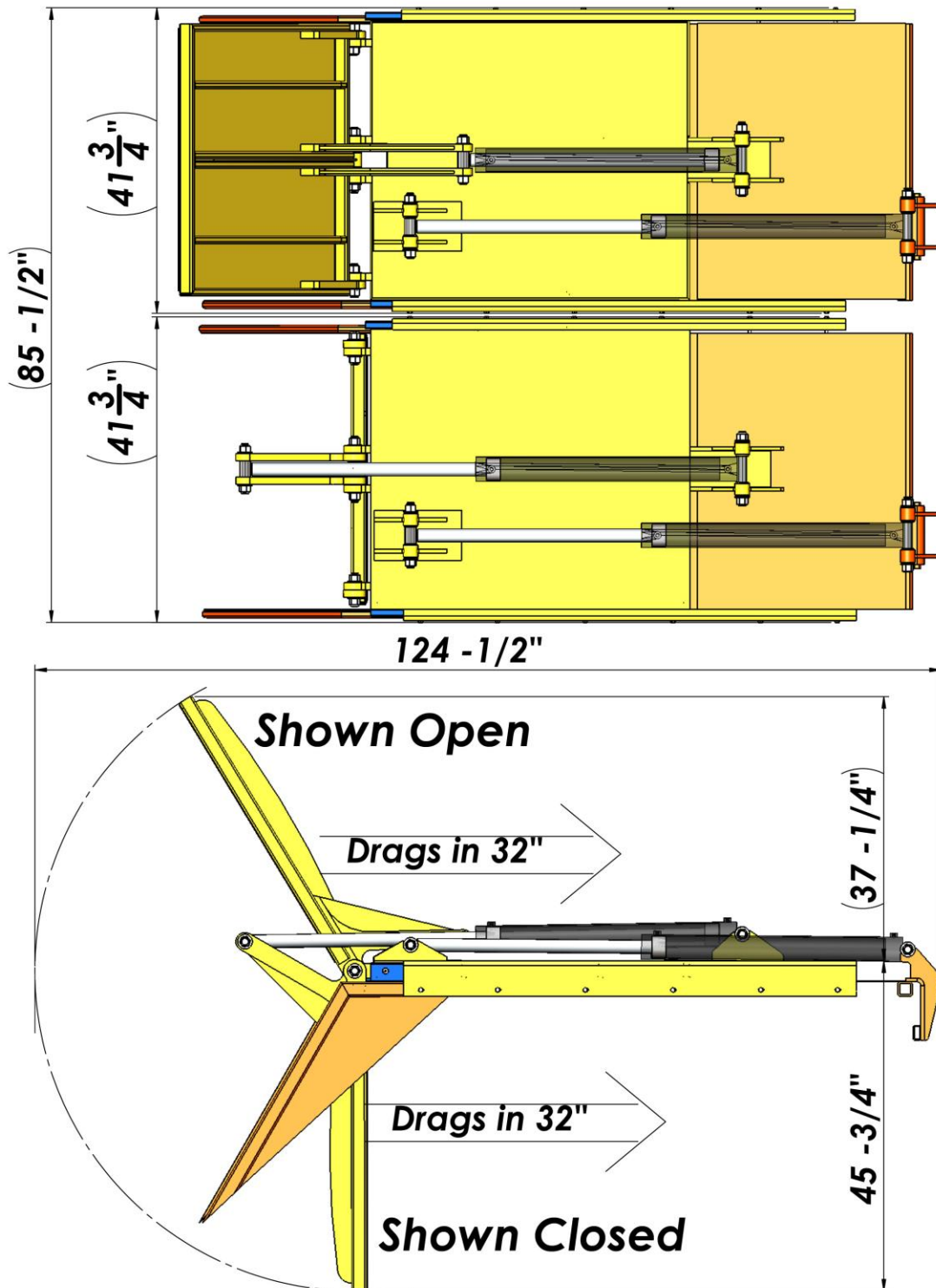

D39730 Weight 1400 Lbs

Perkins regularly makes product improvements. Dimensions are subject to change without notice.



Perkins Manufacturing Company
Creators of the TuckAway® Cart Lifter
www.perkinsmfg.com

800-882-5292

Revise: 4/26/22

Page 8 of 44

Cycle Times

The cycle time of a sweep lid is dictated by GPM (Gallons Per Minute) output from the hydraulic power source. The chart below represents three case scenarios: with our standard 12VDC pump, optional 24 VDC pump and 8 GPM pump driven by a PTO inserted into the transmission's vehicle. This third choice, requires the vehicle to be "PTO ready". Price varies for either of the choices.

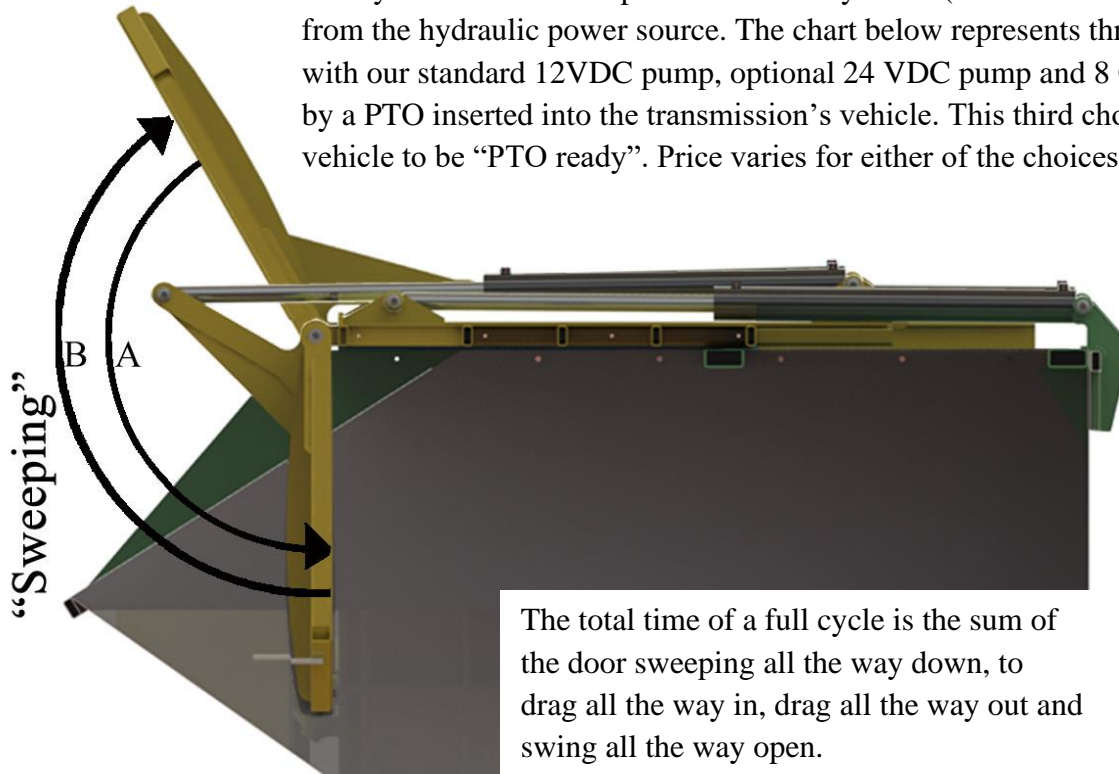

	Standard, 12VDC (2 GPM) Pump	Optional, 24VDC (3.2 GPM) Pump	Optional, PTO & Pump (ex. 8 GPM)
A	27 Seconds	18 Seconds	7 Seconds
B	19 Seconds	12 Seconds	5 Seconds
C	19 Seconds	12 Seconds	5 Seconds
D	27 Seconds	18 Seconds	7 Seconds

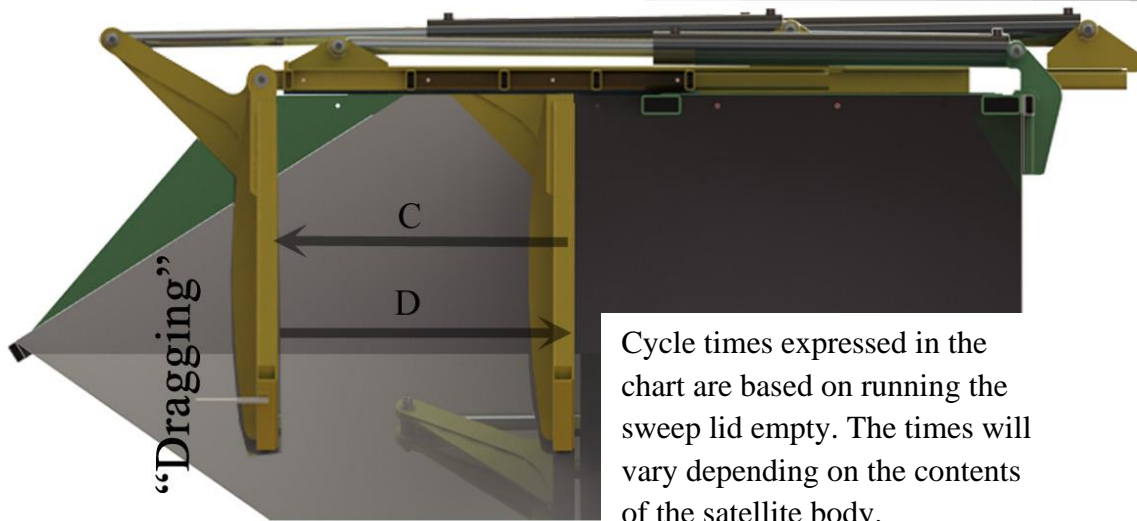

Installation Safety

Please read this manual prior to installing, repairing or using this cart lifter.

- ✧ Installation of this equipment requires welding, painting, grinding, torching and working with high- pressure hydraulic systems. The appropriate safety equipment should be used at all times.
- ✧ Always follow OSHA specified lock-out procedures while working with a truck.
- ✧ Always use proper lifting equipment when positioning equipment during installation.
- ✧ Always use a chain or strap to secure the equipment in the upright position during the installation process. Unsecured equipment may fall suddenly causing injury.
- ✧ Clear the work area of flammable materials before performing any welding.
- ✧ Do not weld on the truck unless a ground is in place and the battery is disconnected.
- ✧ Do not open/loosen any hydraulic lines unless the system is off and depressurized.
- ✧ Always double-check hydraulic fittings and hoses for tightness prior to reactivating the pump.
- ✧ Relocate the license plate or any lights that might be obstructed by the tipper or dump body.
- ✧ Do not paint over caution and warning labels.
- ✧ Do not operate the dump body function unless the mounting brackets are fully anchored to the truck bed.
- ✧ Take care when operating the dump body. Be sure to only operate it on a smooth level surface. Sloped terrain could lead to unbalancing the truck.
- ✧ If there are any questions about the proper installation or use of the cart lifter not covered in the manual, it is recommended to call Perkins at 800-882-5292.



Installation

Although your satellite may come with Sweep Lid ready, already installed, the following instructions will describe how to install the sweep lid on an existent satellite to which we are adding the sweep feature.

First, we need to install the weld on additions. Please make sure there is a ground cable connected to the truck's metal body and the that battery cables have been disconnected prior to attempting any weld.

Remove the dust or grease from the areas to be weld and with the use of an electrical sanding machine, remove the paint, as this could cause a defective welding. Please ensure a safety environment with proper ventilation and proper safety equipment for proper protection, remember, if there is a doubt if a protection is necessary or not, will never be too much for our protection.

After all the cautions had been covered, proceed to install the upper tubes (8). Begin to install the one that needs to be flush to the top and against the back panel, right at the upper back corner, tack weld in position. Measure 32" for the 6-yard satellite and 29" for the 8-yard, from the inside face of the tube already installed towards the front of the bucket and mark, that will be the position for the second tube (8), tack weld the tube flush to the top and in the mark that you just did. Now lay the top panel (7) on top of the tubes and installed from the center of the first tube and accommodate evenly to cover the gap that is between tubes, tack weld only. See image bellow.

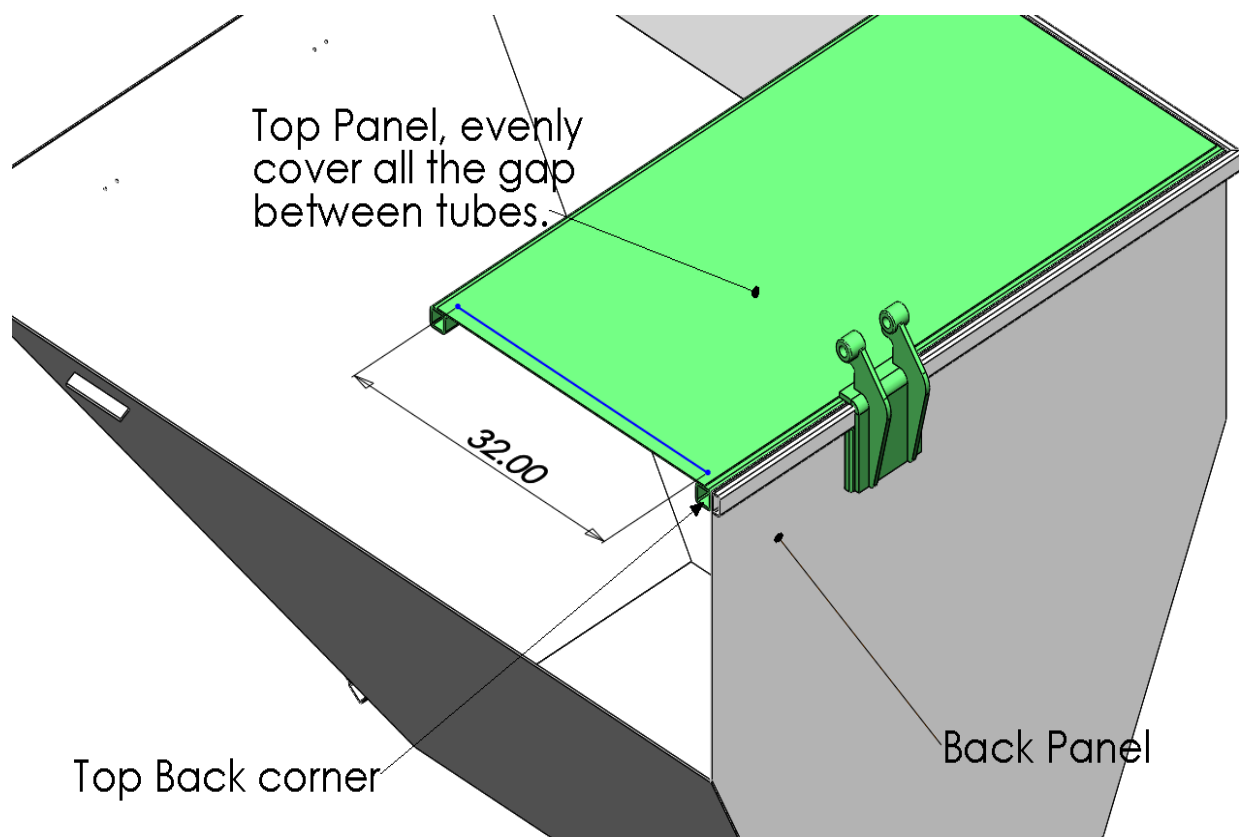

Install the overflow corner weldments (5) & (6), install them flush to the inside of the bucket side panel and flush to the top edge of the outside tubes, these over flow corner weldments are meant to move the corner of the bucket 17" towards the back. Tack weld only. See image below.

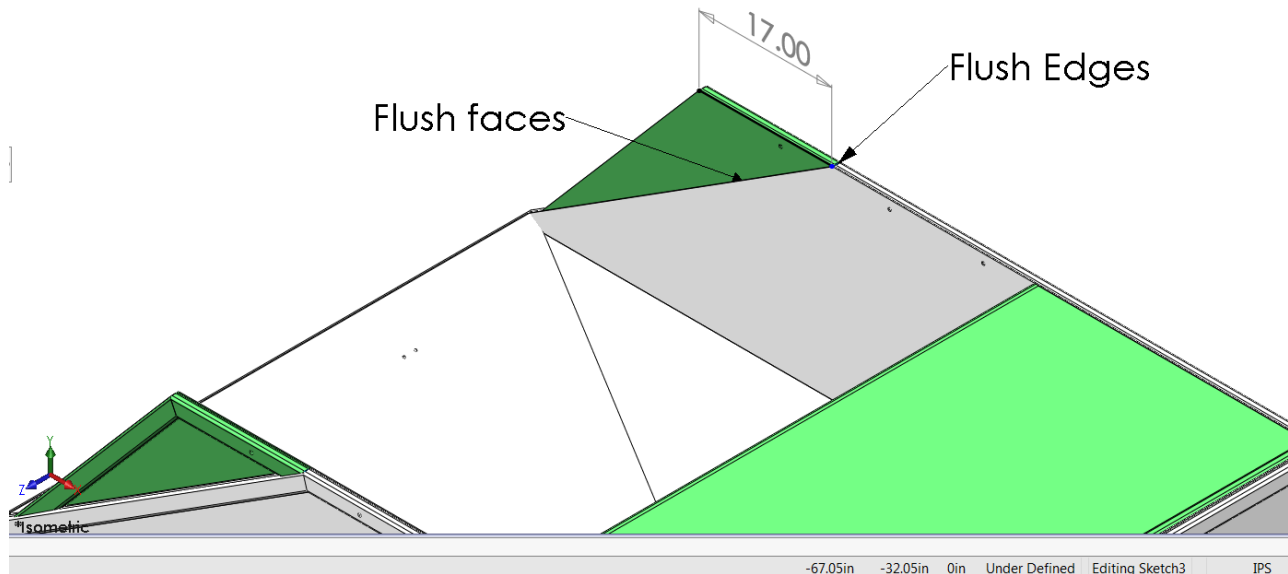

For the following step we will need a power drill, air or electric, with a 13/32" drill bit, to make it easier, it can be done in two stages, first use a 3/16" drill bit and second use the 13/32". We will also need a clamping device to temporarily secure the side rails (15) & (17), locate the rails at 6-1/2" from the back of the rear tube to where the rail is going start and flush to the bottom of the side tubes, mark the holes location, remove the rails and drill. See below.

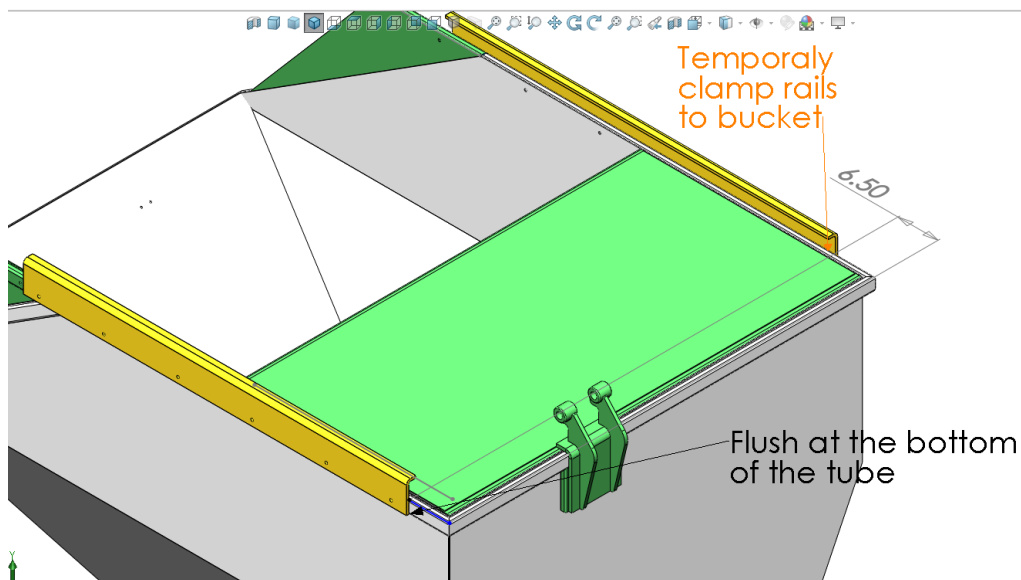

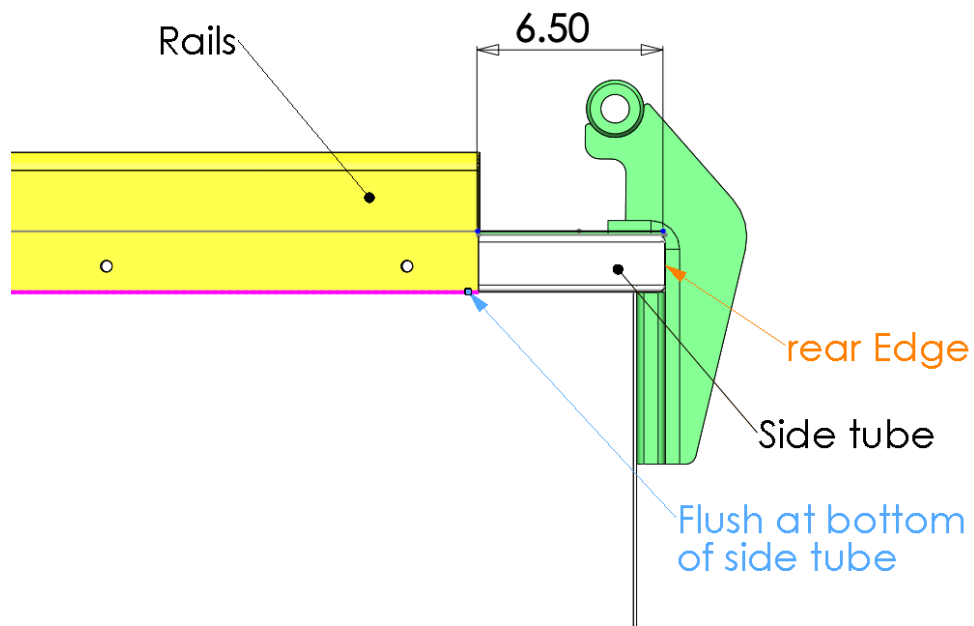

Once the holes are drilled attach the rails (15) (17) to the bucket (29) or buckets (31) (32) with the bolts (22) and nuts (23), tight appropriately. Attach Nylon slide blocks (9) to slide weldment (2) or weldments (2) (2a) with the bolts (25) and nuts (23), tight appropriately. If slide weldment (2) and swivel door (3) don't have the bushings (27) installed, press them into their location before installation.

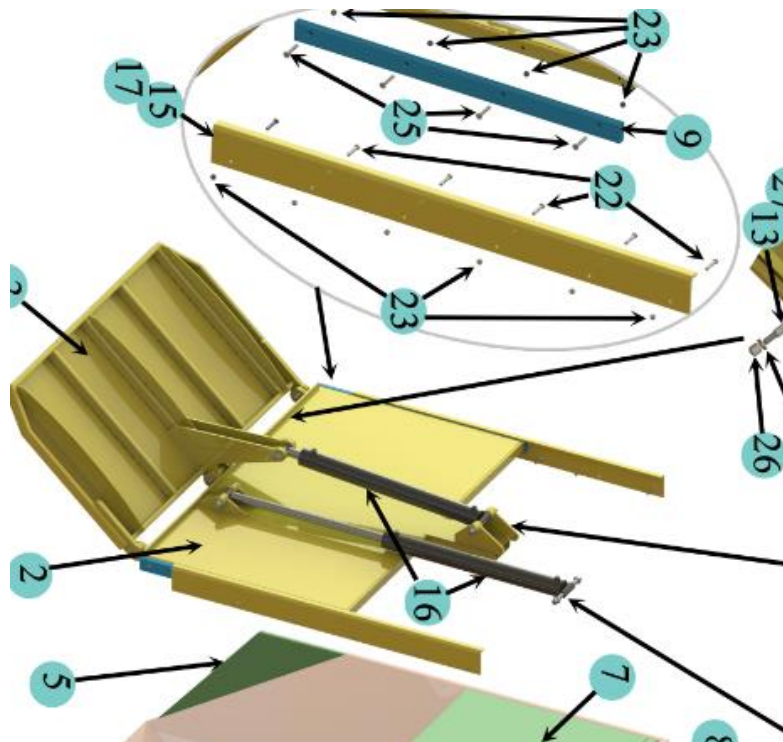

Perkins Manufacturing Company
 Creators of the TuckAway® Cart Lifter
www.perkinsmfg.com

800-882-5292

Revise: 4/26/22
 Page 13 of 44

With the use of heavy lifting equipment, Slide the assembly from the back of the bucket (from where the overflow corner triangles are installed) thru the rails, a gap, side to side, no less than 1/8" and no more than 1/2" and no less than 1/8" no more than 1/4" top/down, should be observed between rails and slide weldment assembly.

Push the slide assembly all the way in and install the hydraulic cylinder (16) into its assigned location, insert the cylinder rod side and secure it with pin (11) lock the pin (11) with spacers (14) and nuts (26).

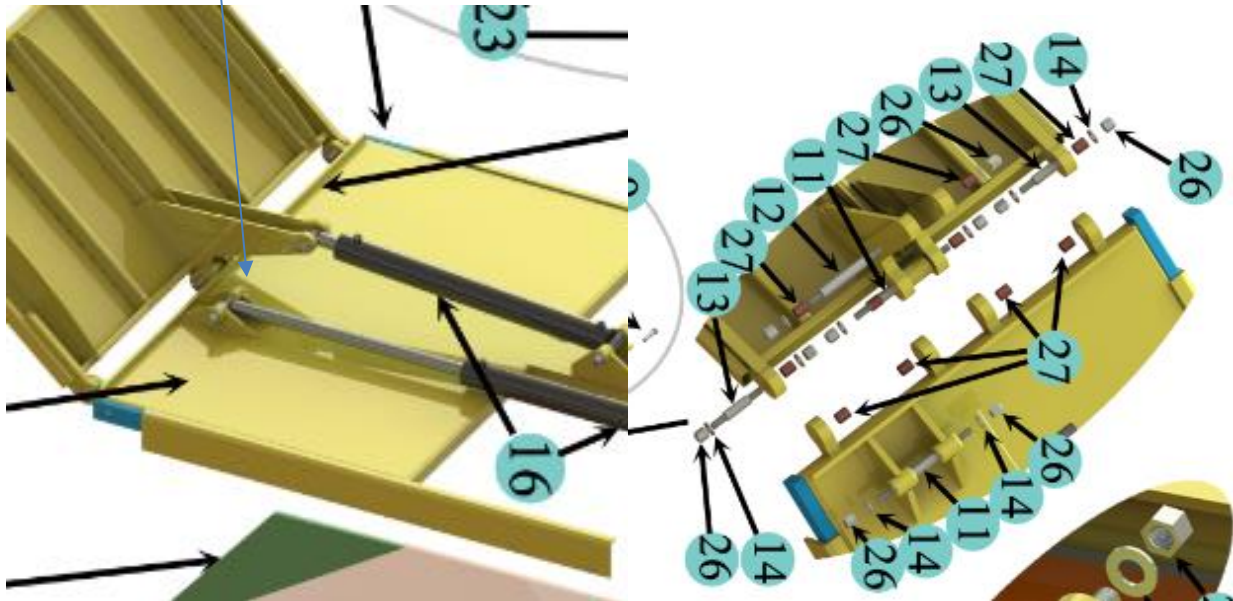

At the other end, bore side, of the cylinder (16), already attached from one side, install the rear gusset weldment (4), secure it with pin (10) and lock the pin (10) with spacer (14) and nuts (26). With the cylinder (16) all the way closed and the weldment (4) attached, sit the weldment (4) on top of the bucket and against the rear end. Before welding the rear weldment gusset (4), make sure cylinder is all the way closed and cylinder is perfectly aligned as is necessary for proper operation, tack weld the rear gusset weldment in place.

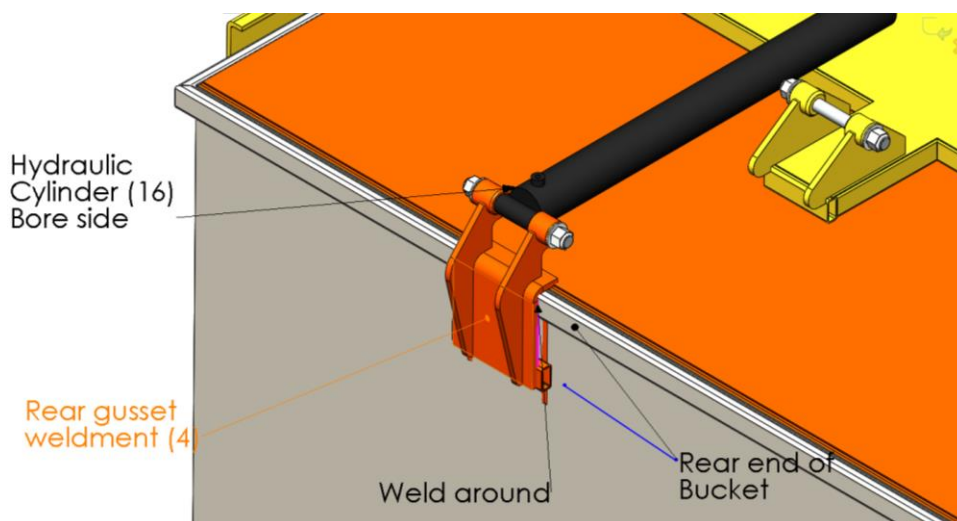

With the use of heavy lifting equipment, lift the swivel door (3) or swivel doors (3) (3a) and align it with the slide weldment (2) already installed. Center the piece and align the holes, insert and secure with pins (11) and (13) and lock the pins with spacers (14) and nuts (26), make sure the door freely rotates.

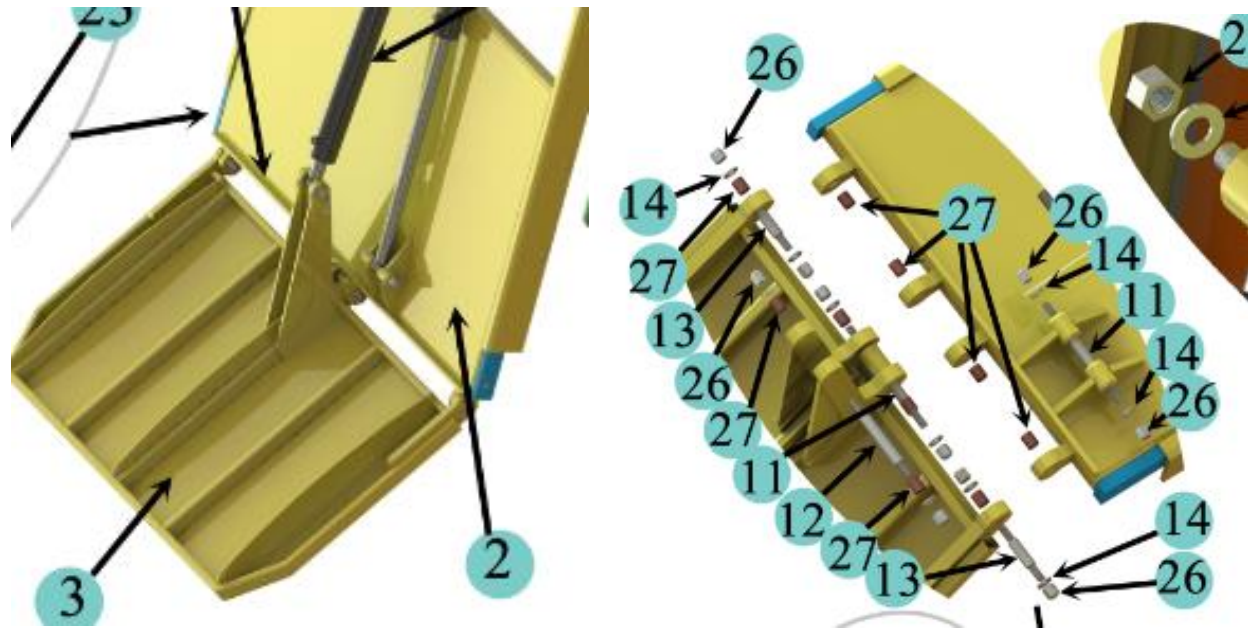

Attach the second hydraulic cylinder (16) to the slide weldment (2) from the rod side and to the swivel door (3) from the rod side, secure with pins (10) and (12), lock the pins with spacer (14) and nuts (26).

After this last step is completed, is time to hydraulically test the unit prior to fully weld all the components. With caution and considering all the safety advices before mentioned, apply hydraulic power to the cylinders. Run the two operations fully to make sure movement is free and without hesitation, ensure alignment and remove all the components, leaving only those to be weld. With the use of heavy lifting equipment, we can remove all the components without the need of disassembling if that is preferred. Once the operation has been validated, fully weld the components, clean and paint or re-paint, making sure not damaging or painting over safety labels. Finalize the assembly.



CAUTION!

SAT BODY MUST BE FULLY DOWN IN ORDER
TO OPERATE DRAG SLED OR SWEEP LID SAFELY.

DO NOT OPERATE DRAG SLED OR SWEEP LID
WHEN SAT BODY IS ELEVATED!

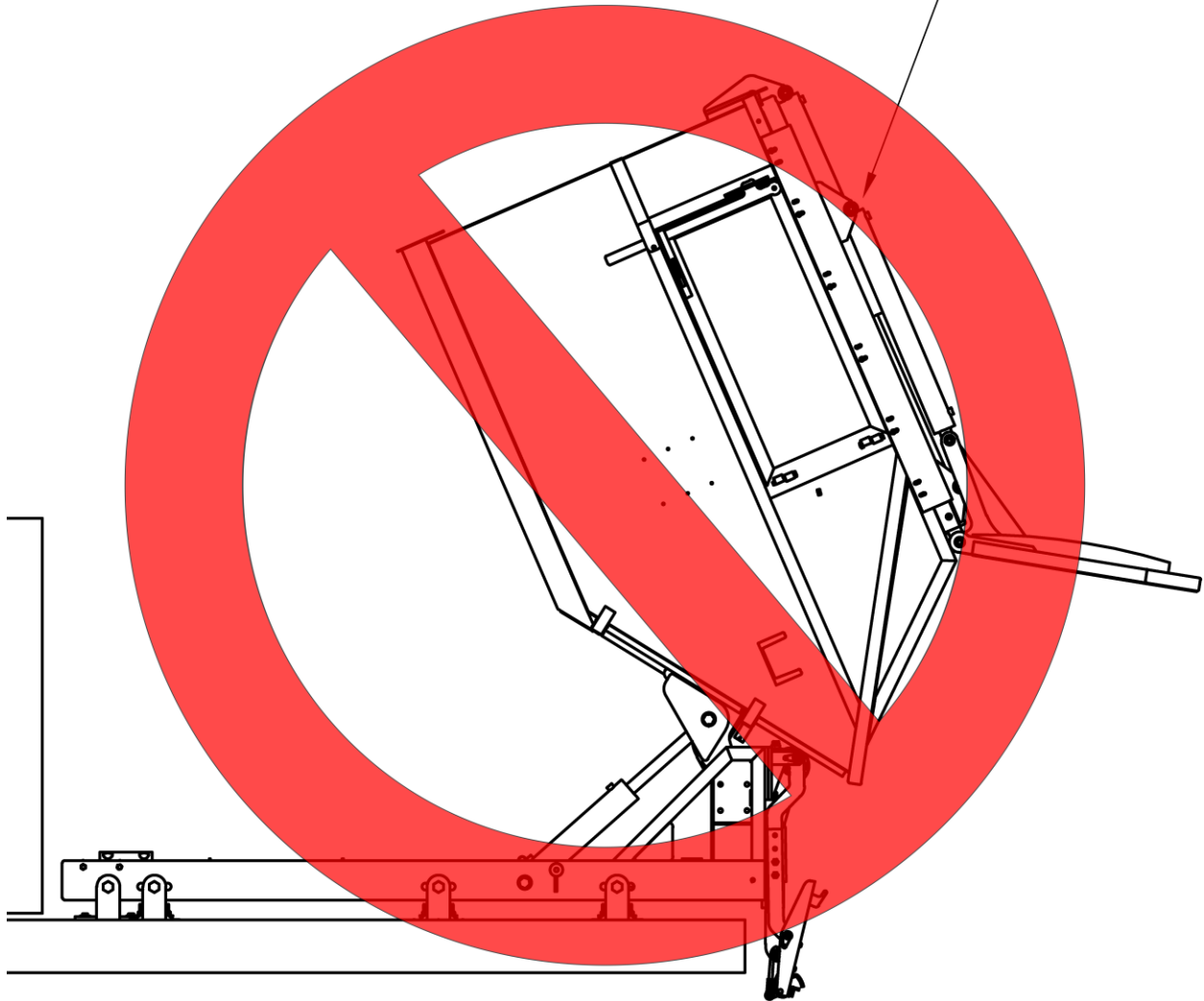

The optional Sweep-Lid will not break up furniture, household appliances, scrap wood, etc. If your SAT is equipped with a sweep lid, be careful not to use it to crush up bulky items or damage will occur. The sweep lid is not intended to function as a compactor. This type of damage is considered operator error and is not covered by warranty.



Hydraulic installation

When a satellite is purchased with a sweep lid already installed, all the welding and drilling instructions mentioned in the previous pages, does not apply. The instructions on how install a two hydraulics sections on the already existent hydraulic pack to operate the sweep lid, will not apply as well, the power pack will come with all the necessary valves for its functions already installed.

Depending on the number of hydraulic devices your satellite is equipped with, this will be the number of hydraulic valves your power pack will have attached. However, this instruction applies for existent satellites with the need of adding sweep lids or any other hydraulic device that originally was not equipped.

The sweep lid operation requires two extra valves to be added in the case of a full body application, and in the case of a split body application, this will require four extra valves addition.

Hydraulic components, necessary for the sweep lid installation:



1- 4 button pendant control for full body application.

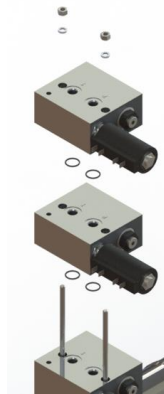

2- set of valves to add. Which will include: 2 -valves, 4 -O-ring seals, 2- lock washers, 2- lock nuts, 2 long threaded rods.

This will be for the full body application, for the split application will be double the amount.

4 long hydraulic hoses and set of clamps to weld and route the hoses through the sides of the bucket.



Perkins Manufacturing Company
Creators of the TuckAway® Cart Lifter
www.perkinsmfg.com

800-882-5292

Revise: 4/26/22
Page 17 of 44

Locate the power pack and remove the bolts holding the valves together, do not remove or move the valves, hydraulic seals are trapped between sections, if for some reason the valves are moved or separate from the assembly, make sure the seals are in place before reassembling the valves.

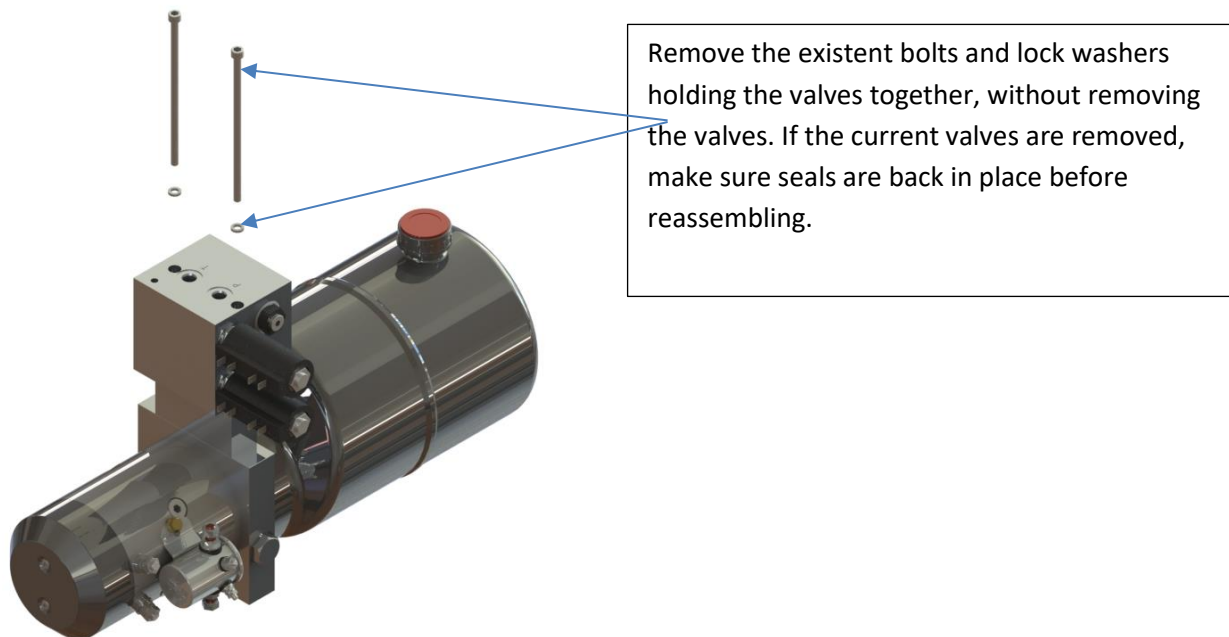

Insert the long-threaded rods into the hole threaded grooves, where the bolts were and screw them in, install the first two seals on top of the existent valve, install the first valve, install the second two seals on top the added valve, install the second valve, secure and tight the assembly with the lock washer and lock nuts, tight appropriately. Before the next step, test the pump for proper assembling. Without removing the plugs from the added valves, run the existent functions, make sure there are no leaks.

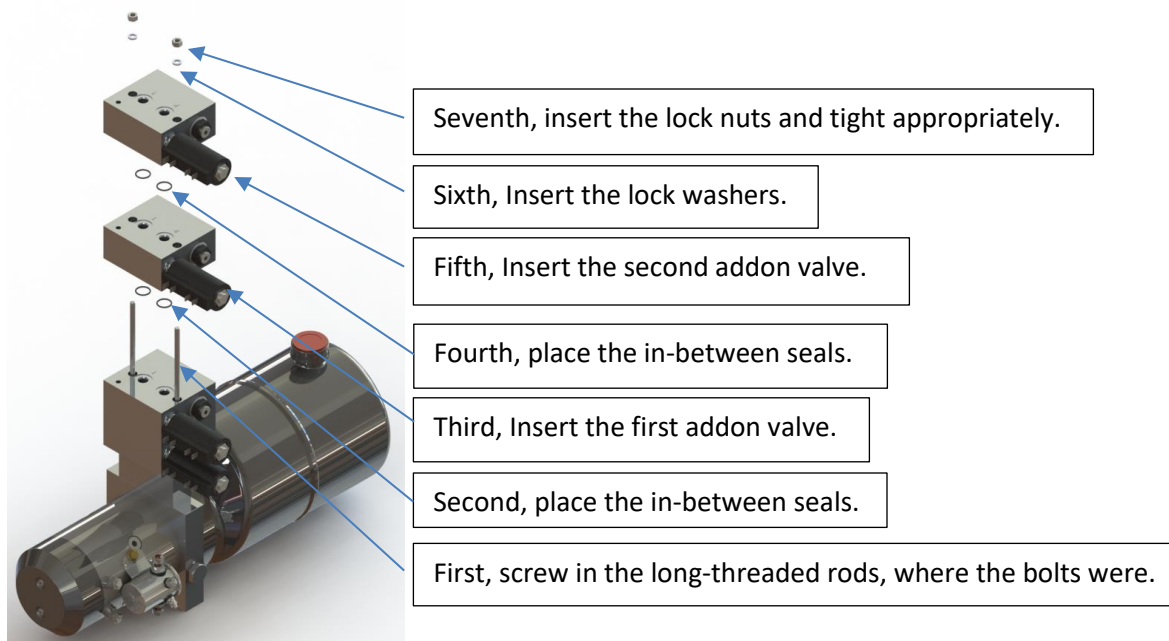

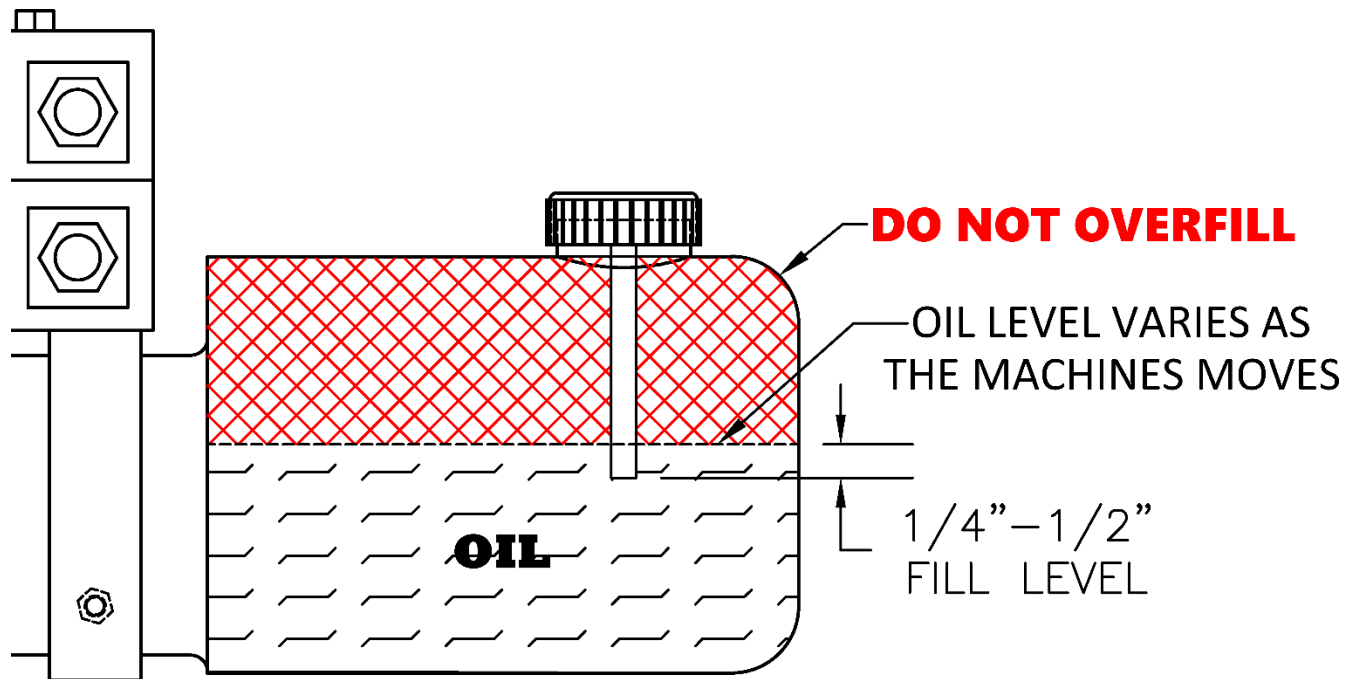

The oil level inside the tank rises and lowers as the equipment moves up and down. It is normal for the tank to appear less than full at times.

For initial setup only, the cylinders and hoses may be empty of fluid and will have to fill. Pour oil into the tank half-full and operate the equipment slowly. As the equipment fills with oil, the level in the tank will drop. Continue to add oil slowly, and operate the equipment bit by bit, until the cylinders and hoses are full. It will be necessary to bleed the air out of the system by operating all functions of the unit repeatedly until all the air has been flushed out. While there is air in the lines, the movement will at times be jerky or have a stutter. Once the air is completely out, the movement will become smooth.

NOTE: DO NOT OVERFILL THE OIL TANK.

The tank is "full" when the dipstick reaches about 1/4"-1/2" into the oil level. **NEVER FILL THE TANK TO THE TOP, EXCESS OIL WILL OVERFLOW OUT.**



Perkins Manufacturing Company
 Creators of the TuckAway® Cart Lifter
www.perkinsmfg.com

800-882-5292

Revise: 4/26/22

Page 19 of 44

Once the installation of the valves has been completed and tested to prove that there are no leaks, begin to weld the hose clamps. Weld the clamps to route the hoses, not obstructing doors or getting on the way of moving parts, since the bucket swivels up and down, account for the movement trying to have enough slack for the hoses not to be too tensioned or too loose. See Below images



Perkins Manufacturing Company
Creators of the TuckAway® Cart Lifter
www.perkinsmfg.com

800-882-5292

Revise: 4/26/22
Page 20 of 44

Perkins Pendant Wiring

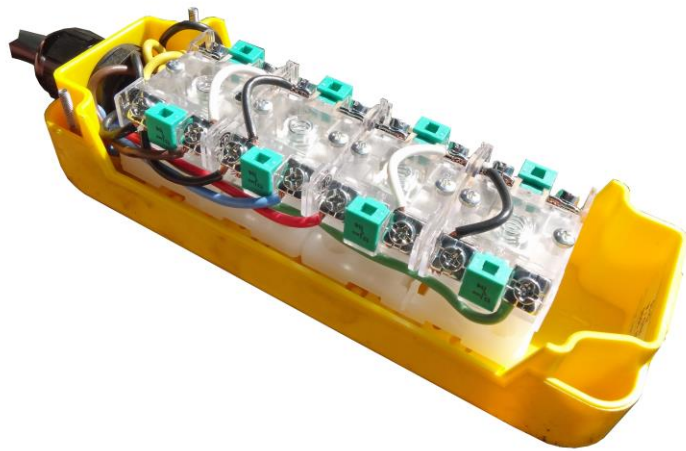

The pendant comes prewired. If repairs are necessary, re-wire the pendant as shown.

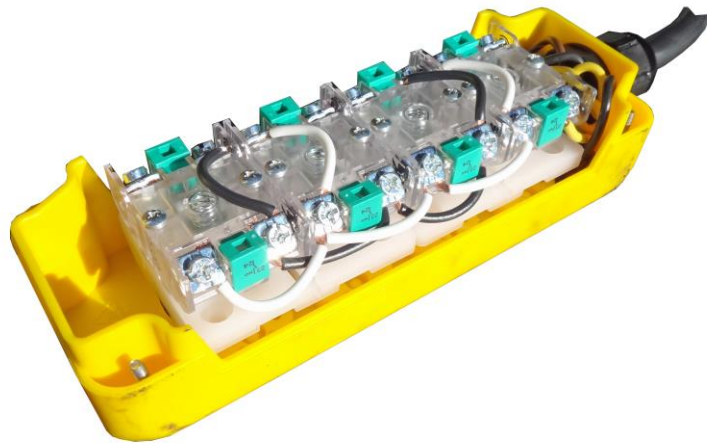

Opposite view



Perkins Manufacturing Company
Creators of the TuckAway® Cart Lifter
www.perkinsmfg.com

800-882-5292

Revise: 4/26/22
Page **21** of **44**

DC Power Pack Hydraulic Schematic, Overall dimensions and Parts View (Four Functions Shown)

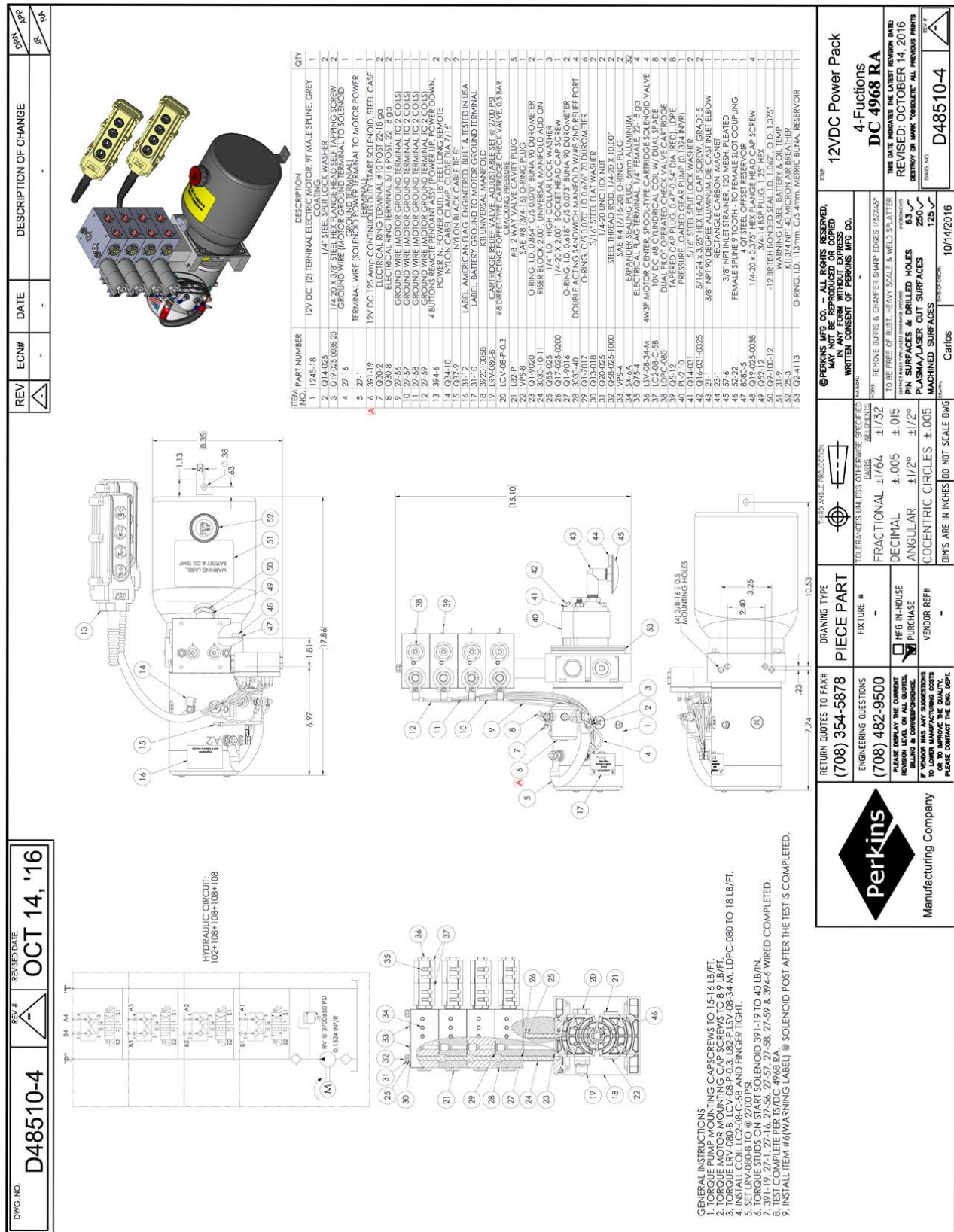

PERKINS MANUFACTURING COMPANY

12VDC Power Pack

4-Functions

DC 4968 RA

THE DATE INDICATES THE LATEST REVISION DATE

REVISED: OCTOBER 14, 2016

DESTROY OR MARK "OBSOLETE" ALL PREVIOUS PRINTS

DWG. NO. **D48510-4**

DATE **10/14/2016**



Power Draw Guide

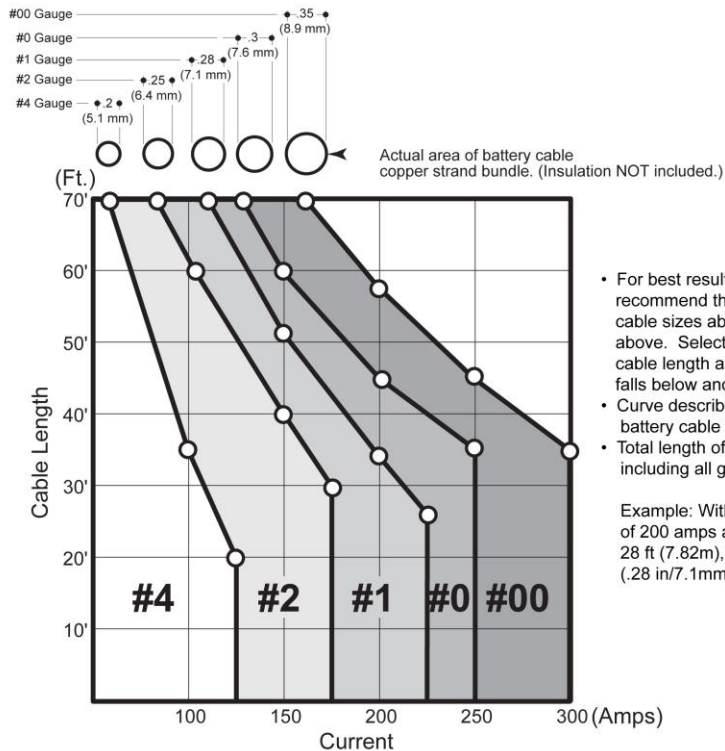

- For best results, Monarch would recommend that you increase 1 or 2 cable sizes above the minimum shown above. Select cable size so that your cable length and maximum amp draw falls below and to the left of curve.
- Curve describes a 1 volt loss in the battery cable itself.
- Total length of battery cable(s) including all ground cables.

Example: With maximum current draw of 200 amps and total cable length of 28 ft (7.82m), Select #1 gauge (.28 in/7.1mm) or larger.

It is required to run the electric supply lines directly up the battery of the truck for maximum power draw of 250 amps or the system will not have the proper lifting power.

**DO NOT SIMPLY
ATTACH THE
POWER SUPPLY TO A
LIGHTING WIRE.**

Solenoid Wiring Guide

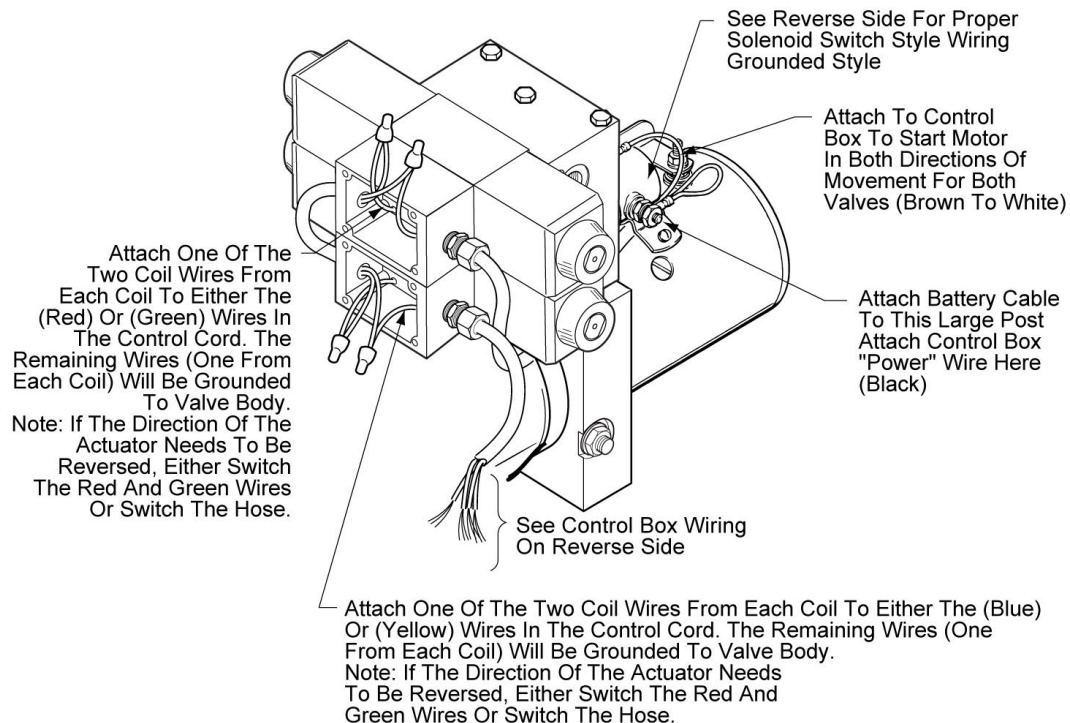

Perkins Manufacturing Company
Creators of the TuckAway® Cart Lifter
www.perkinsmfg.com

800-882-5292

Revise: 4/26/22

Page 23 of 44

NOTICE ON THE POSITION OF THE D03 DIRECTIONAL CONTROL VALVE STACK

The control valve stack must be installed in a way that the d03 spool is horizontal at all times. Inside the valve is a spool with springs. The springs self-center the spool when the power is disengaged. When positioned horizontally, the spool self-centers normally. When incorrectly positioned vertically, the springs must work harder to return the spool to center, which may lead to jamming and malfunctions.

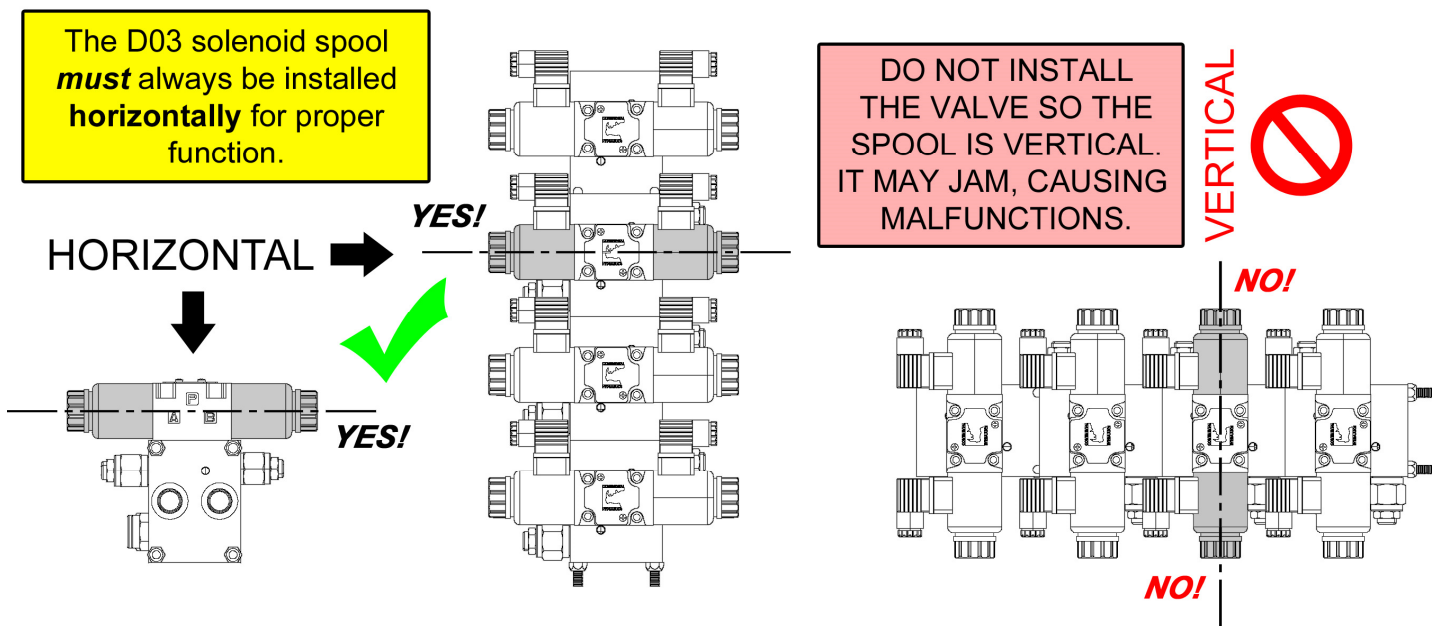

Please orientate the valve properly during your installation process so malfunctions do not occur.



If the spool does become jammed, it can be freed by manually sticking a screwdriver into the slot at the end of the spool and giving a small push to un-stick the spool.



Perkins Manufacturing Company
Creators of the TuckAway® Cart Lifter
www.perkinsmfg.com

800-882-5292

Revised: 08/10/23
Addendum

 WARNING	
	This unit is equipped with an over-heat protection circuit.
	The circuit will shut off when the motor temperature is too hot, which will prevent the operator from damaging the motor with continued use.
	The circuit will automatically reset itself after the motor cools to a safe level. Then normal operation can resume.

Do not paint over this label. Replace if damage

D72845

Battery powered DC units have a duty cycle of 2 minutes of active use every 10 minutes. That means 2 minutes on, 8 minutes off. The intention is for periodic operation, with some driving time between uses. Example of acceptable use: Servicing a park or trail, where the bins are spread out and the motor will have time to cool off in-between service points.

The more the motor is used, the hotter it becomes. Overheated motors can suffer from permanent burnout without warning and need to be replaced. To prevent this, our power packs come with a built-in circuit with a thermometer. When the motor reaches a certain temperature, the circuit will trip, and the motor will stop working. If this happens, the operator simply needs to wait for the motor to cool enough for the heat protection circuit to automatically reset, then they can continue operation normally.

These battery-operated units are not intended for continuous back-to-back action. (Example, 20 bins at a single stop with little or no break between bins). In situations where all the bins are at one location, the circuit protecting the motor from overheating will trip, causing a delay in operations. If your operations involve heavy back-to-back usage, Perkins recommends equipping your vehicle with a PTO system instead which can handle continuous use.



Hydraulic Schematic

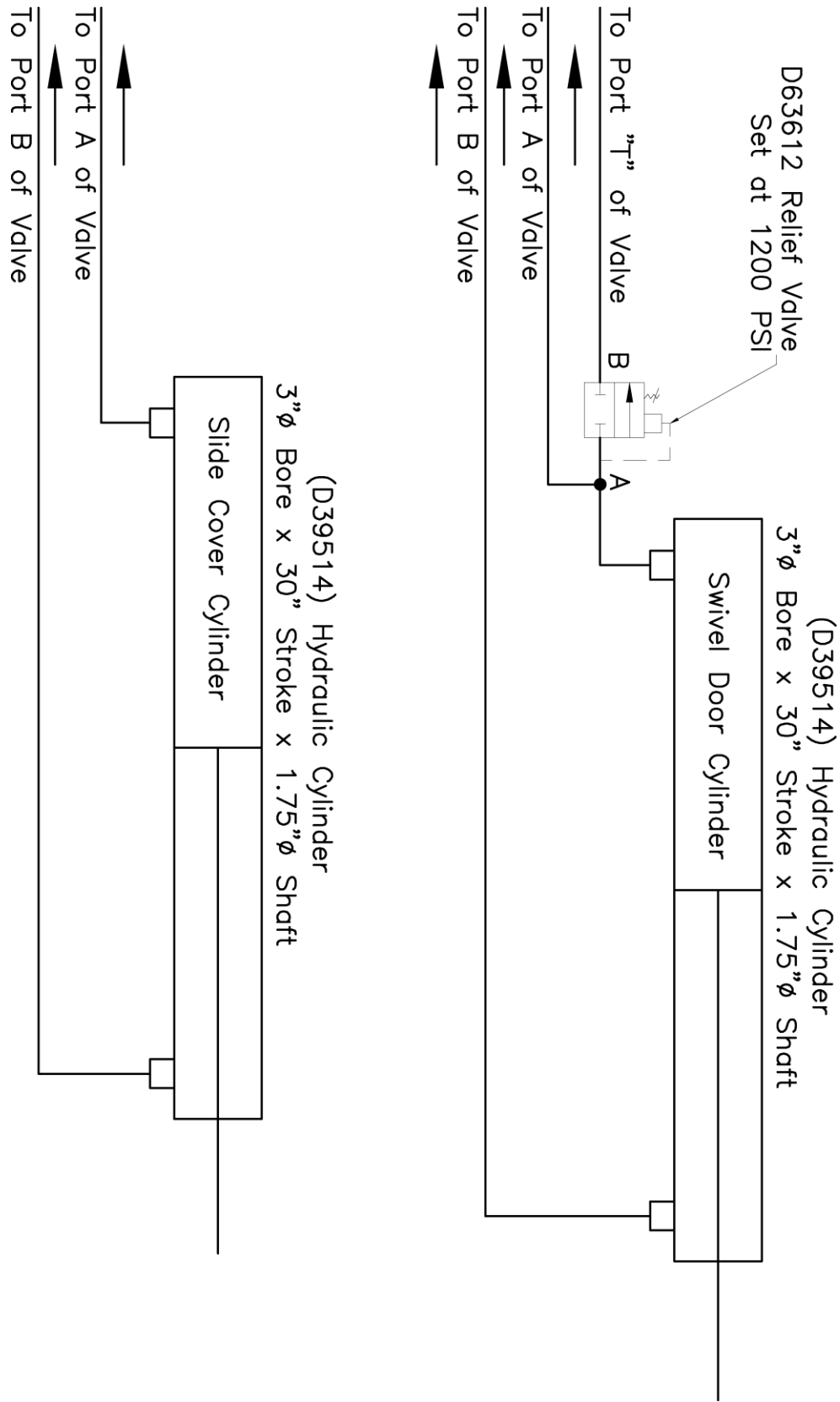

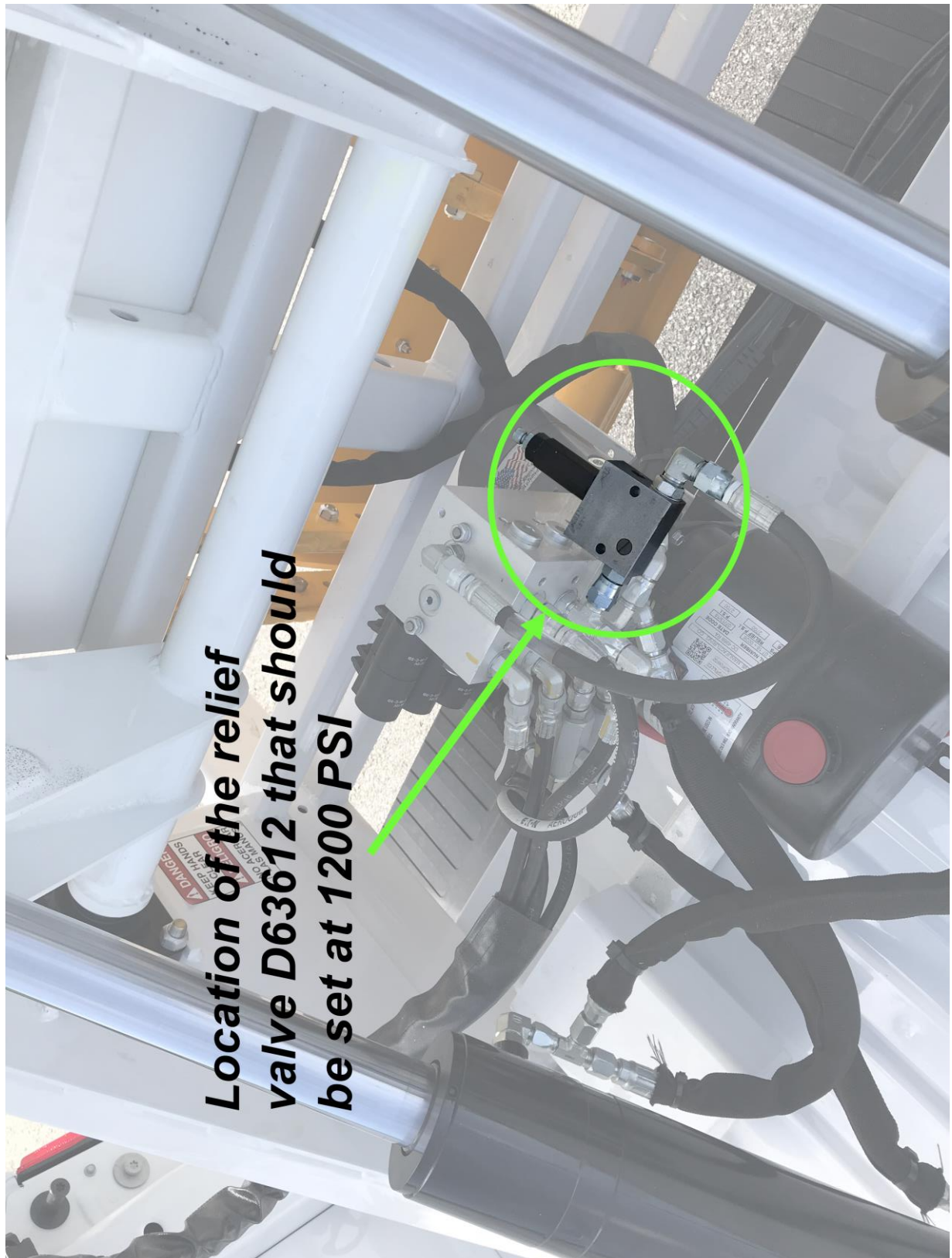

Quick Reference Guide covers the most common problems.
(if we have missed a step please let us know)



Exploded View Full Body 6 & 8 yards

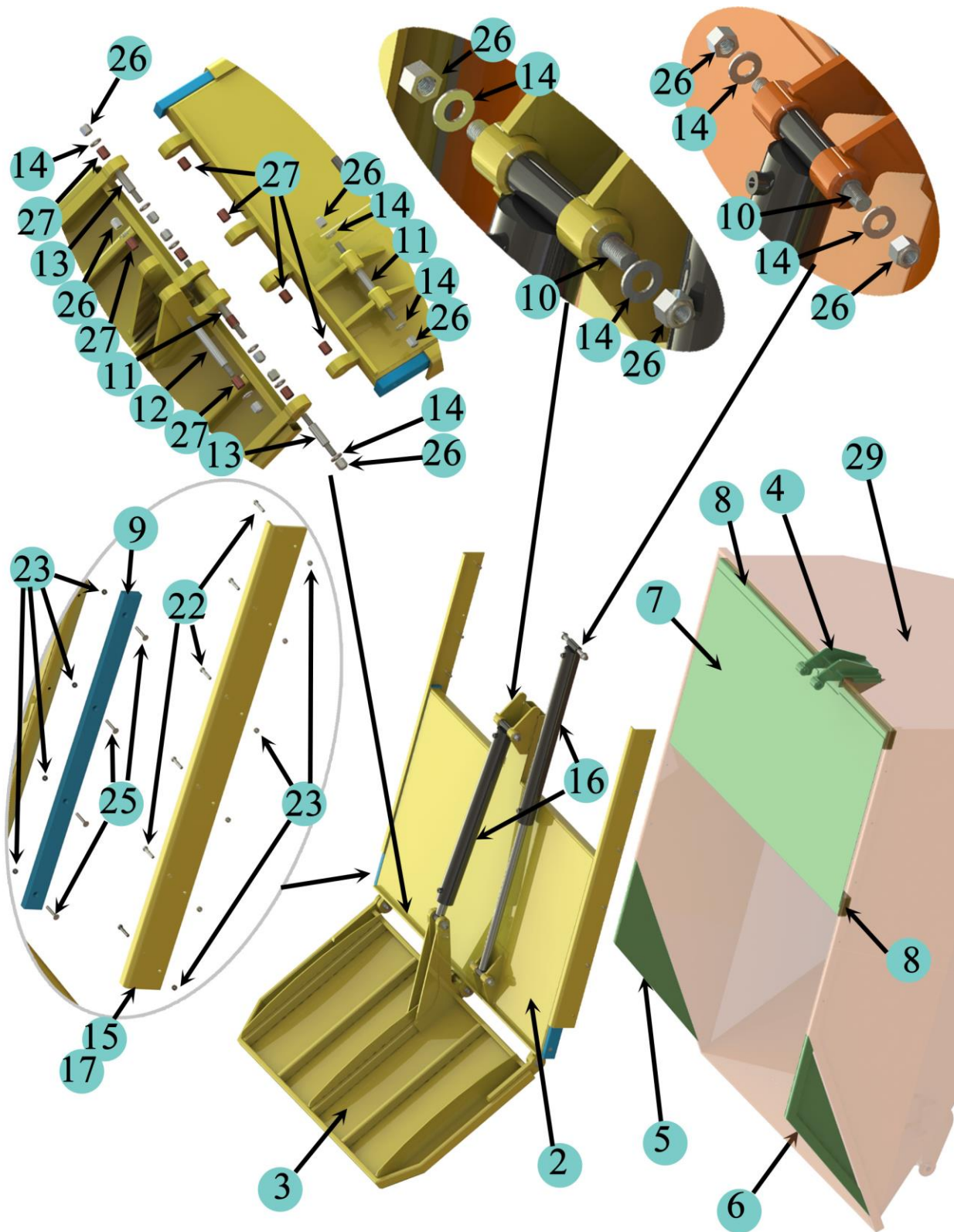

Perkins Manufacturing Company
 Creators of the TuckAway® Cart Lifter
www.perkinsmfg.com

800-882-5292

Revise: 4/26/22
 Page 28 of 44

Exploded View 50/50 Split Body 6 & 8 yards

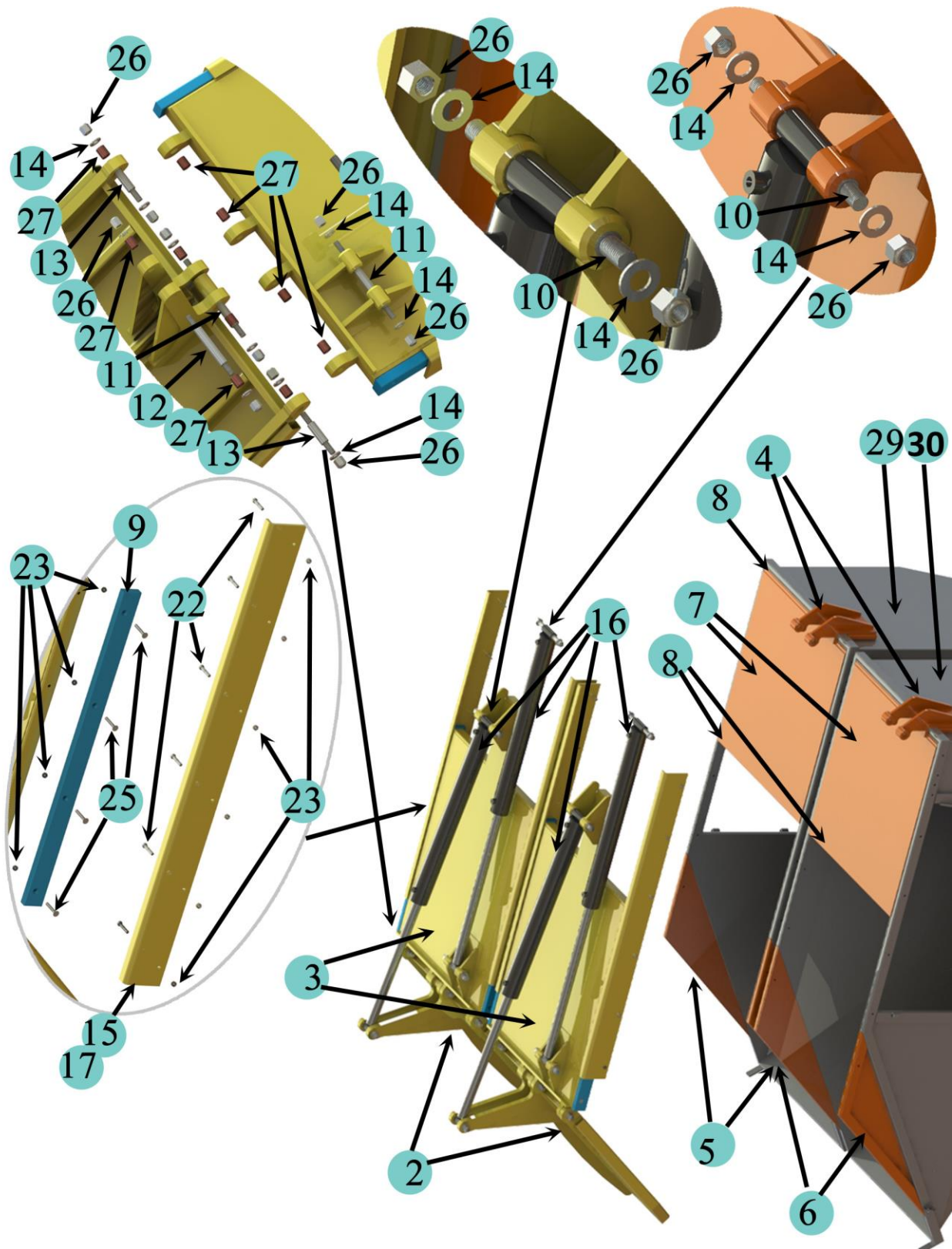

Perkins Manufacturing Company
 Creators of the TuckAway® Cart Lifter
www.perkinsmfg.com

800-882-5292

Revise: 4/26/22
 Page 29 of 44

Exploded View 60/40 Split Body 6 & 8 yards

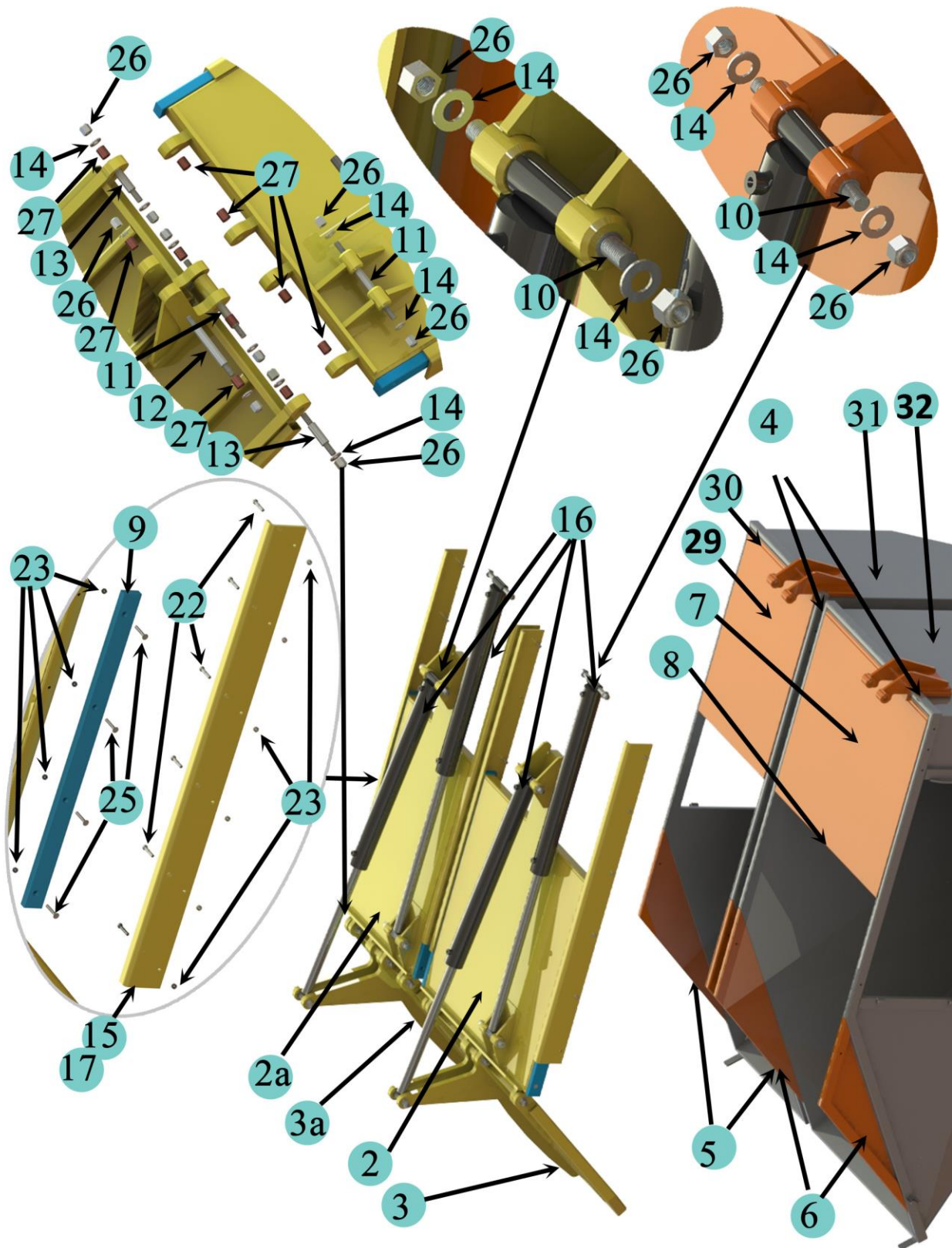

Perkins Manufacturing Company
 Creators of the TuckAway® Cart Lifter
www.perkinsmfg.com

800-882-5292

Revise: 4/26/22
 Page 30 of 44

Parts List 6 Yards full Body (D34000)

Item#	Part#	Description	Qty.
1	A90720*	Sidewinder hose wrap	10
2	D34001	Sliding lid 6 yd. sweep lid	1
3	D34002	Cover 6 yd. Sweep Lid	1
4	D39725**	Rear Gusset Weldment	1
5	D34006_L**	Triangle assembly Left	1
6	D34006_R**	Triangle assembly Right	1
7	D34007**	Top panel	1
8	D34008**	Top Tube	2
9	D34015	Plastic Slider	2
10	D34031	Double Thread Stud 7 5/8"	2
11	D34032	Double Thread Stud 6 7/16"	2
12	D34033	Double Thread Stud 4 5/16"	1
13	D34034	Double Thread Stud 2 7/32"	2
14	D34035	Flat washer 3/4"	14
15	D34045	RH Side Rail Weldment	1
16	D39514	Hydraulic Cylinder	2
17	D39701	Sled Guide Rail	1
18	D61053*	HOSE #4 W/ #6 ENDS X 240"	1
19	D61053-186*	#4 Hose Assembly With #6 Ends X 186 Length	1
20	D61053-203*	#4 Hose Assembly With #6 Ends X 203 Length	1
21	D61053-226*	#4 Hose Assembly with #6 Ends x 226 Length	1
22	D62042	BOLT HHCS 3/8-16 X 2	12
23	D62080	LOCKNUT 3/8-16	20
24	D63105*	ELBOW 90 #6MT-#8MO	4
25	D72101	BOLT FHCS 3/8-16 X 2 1/2	8
26	D72132	LOCKNUT 3/4-10	14
27	D72147*	Hose Clamp #4	12
28	D72240	Oilite Brass Bushing	10
29		6 Yards Complete Body Bucket	1

* Not Shown in Exploded View

** Parts 4,5,6,7 & 8 are components of 29
when satellite is ordered with Sweep Lid already.



Perkins Manufacturing Company
Creators of the TuckAway® Cart Lifter
www.perkinsmfg.com

800-882-5292

Revise: 4/26/22
Page 31 of 44

Parts List 6 Yards 50/50 Split Body (D34065)

Item#	Part#	Description	Qty.
1	A90720*	Sidewinder hose wrap	10
2	D34055	Sliding lid 6 yd. sweep lid	2
3	D34052	Cover 8 yd. Sweep Lid	2
4	D39725**	Rear Gusset Weldment	2
5	D34006_L**	LH Triangle assembly Left	2
6	D34006_R**	RH Triangle assembly Right	2
7	D34053**	Top panel	2
8	D34054**	Top Tube	4
9	D34015	Plastic Slider	4
10	D34031	Double Thread Stud 7 5/8"	4
11	D34032	Double Thread Stud 6 7/16"	4
12	D34033	Double Thread Stud 4 5/16"	2
13	D34034	Double Thread Stud 2 7/32"	4
14	D34035	Flat washer 3/4"	28
15	D34045	RH Side Rail Weldment	2
16	D39514	Hydraulic Cylinder	4
17	D39701	Sled Guide Rail	2
18	D61053*	HOSE #4 W/ #6 ENDS X 240"	2
19	D61053-186*	#4 Hose Assembly With #6 Ends X 186 Length	2
20	D61053-203*	#4 Hose Assembly With #6 Ends X 203 Length	2
21	D61053-226*	#4 Hose Assembly with #6 Ends x 226 Length	2
22	D62042	BOLT HHCS 3/8-16 X 2	24
23	D62080	LOCKNUT 3/8-16	40
24	D63105*	ELBOW 90 #6MT-#8MO	8
25	D72101	BOLT FHCS 3/8-16 X 2 1/2	16
26	D72132	LOCKNUT 3/4-10	28
27	D72147*	Hose Clamp #4	24
28	D72240	Oilite Brass Bushing	20
29		6 Yards 50/50 LH Body Bucket	1
30		6 Yards 50/50 RH Body Bucket	1

* Not Shown in Exploded View

** Parts 4,5,6,7 & 8 are components of the 29 & 30
when satellite is ordered with Sweep Lid already.



Perkins Manufacturing Company
Creators of the TuckAway® Cart Lifter
www.perkinsmfg.com

800-882-5292

Revise: 4/26/22
Page **32** of **44**

Parts List 8 Yards Full Body (D39715)

Item#	Part#	Description	Qty.
1	A90720*	Sidewinder hose wrap	10
2	D39705	Sliding lid 8 yd. sweep lid	1
3	D39710	Cover 8 yd. Sweep Lid	1
4	D39725**	Rear Gusset Weldment	1
5	D39778**	LH Triangle assembly Left	1
6	D39776**	RH Triangle assembly Right	1
7	D39709**	Top panel	1
8	D39706**	Top Tube	2
9	D34015	Plastic Slider	2
10	D34031	Double Thread Stud 7 5/8"	2
11	D34032	Double Thread Stud 6 7/16"	2
12	D34033	Double Thread Stud 4 5/16"	1
13	D34034	Double Thread Stud 2 7/32"	2
14	D34035	Flat washer 3/4"	14
15	D34045	RH Side Rail Weldment	1
16	D39514	Hydraulic Cylinder	2
17	D39701	Sled Guide Rail	1
18	D61053*	HOSE #4 W/ #6 ENDS X 240"	1
19	D61053-186*	#4 Hose Assembly With #6 Ends X 186 Length	1
20	D61053-203*	#4 Hose Assembly With #6 Ends X 203 Length	1
21	D61053-226*	#4 Hose Assembly with #6 Ends x 226 Length	1
22	D62042	BOLT HHCS 3/8-16 X 2	12
23	D62080	LOCKNUT 3/8-16	20
24	D63105*	ELBOW 90 #6MT-#8MO	4
25	D72101	BOLT FHCS 3/8-16 X 2 1/2	8
26	D72132	LOCKNUT 3/4-10	14
27	D72147*	Hose Clamp #4	12
28	D72240	Oilite Brass Bushing	10
29		8 Yards Complete Body Bucket	1

* Not Shown in Exploded View

** Parts 4,5,6,7 & 8 are components of 29
when satellite is ordered with Sweep Lid already.



Perkins Manufacturing Company
Creators of the TuckAway® Cart Lifter
www.perkinsmfg.com

800-882-5292

Revise: 4/26/22
Page 34 of 44

Parts List 8 Yards 50/50 Split Body (D39730)

Item#	Part#	Description	Qty.
1	A90720*	Sidewinder hose wrap	10
2	D39752	Sliding lid 8 yd. sweep lid	2
3	D39748	Cover 8 yd. Sweep Lid	2
4	D39725**	Rear Gusset Weldment	2
5	D39778**	LH Triangle assembly Left	2
6	D39776**	RH Triangle assembly Right	2
7	D39747**	Top panel	2
8	D39745**	Top Tube	4
9	D34015	Plastic Slider	4
10	D34031	Double Thread Stud 7 5/8"	4
11	D34032	Double Thread Stud 6 7/16"	4
12	D34033	Double Thread Stud 4 5/16"	2
13	D34034	Double Thread Stud 2 7/32"	4
14	D34035	Flat washer 3/4"	28
15	D34045	RH Side Rail Weldment	2
16	D39514	Hydraulic Cylinder	4
17	D39701	Sled Guide Rail	2
18	D61053*	HOSE #4 W/ #6 ENDS X 240"	2
19	D61053-186*	#4 Hose Assembly With #6 Ends X 186 Length	2
20	D61053-203*	#4 Hose Assembly With #6 Ends X 203 Length	2
21	D61053-226*	#4 Hose Assembly with #6 Ends x 226 Length	2
22	D62042	BOLT HHCS 3/8-16 X 2	24
23	D62080	LOCKNUT 3/8-16	40
24	D63105*	ELBOW 90 #6MT-#8MO	8
25	D72101	BOLT FHCS 3/8-16 X 2 1/2	16
26	D72132	LOCKNUT 3/4-10	28
27	D72147*	Hose Clamp #4	24
28	D72240	Oilite Brass Bushing	20
29		8 Yards 50/50 LH Body Bucket	1
30		8 Yards 50/50 RH Body Bucket	1

* Not Shown in Exploded View

** Parts 4,5,6,7 & 8 are components of the 29 & 30
when satellite is ordered with Sweep Lid already.



Perkins Manufacturing Company
Creators of the TuckAway® Cart Lifter
www.perkinsmfg.com

800-882-5292

Revise: 4/26/22

Page 35 of 44

Making a Warranty Claim

For complete warranty coverage details, please see the warranty page at the end of this manual.

If you suspect that failure of the lifter to operate is due to a defect, please take a moment to locate the serial number of your lifter.

Warranty cannot be honored on lifters or individual pieces unless a serial number is provided. Since the tag is frequently lost, damaged, or painted over, it is a good idea to note the serial number in this manual at the time of installation.

At right is an example of the serial number plate. It will be stamped with a model number and serial number.

Once you have the number, please call Perkins Manufacturing at 800-882-5292 for additional instructions.



Perkins Manufacturing Company
Creators of the TuckAway® Cart Lifter
www.perkinsmfg.com

800-882-5292

Revise: 4/26/22
Page 37 of 44



WARNING

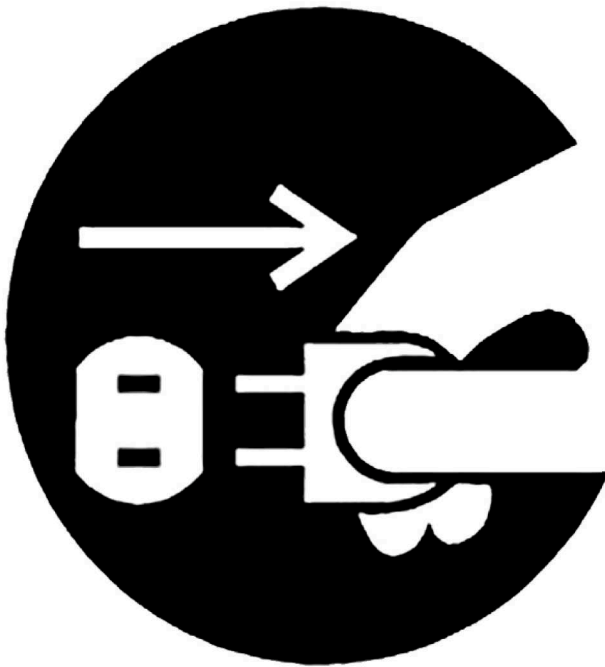

Unplug the
unit when
not in use.

Desconecte
la unidad
cuando no
este en uso.

Do not paint over this label. Replace if damage

D72724

Make sure to unplug pump assembly at D48584 to prevent battery drain when the vehicle is off.



© Perkins Mfg Co. 800-882-5292

Label # D72545

DO NOT CLIMB ON
THE SAT OR THE LIFTER.



Perkins Manufacturing Company
Creators of the TuckAway® Cart Lifter
www.perkinsmfg.com

800-882-5292

Revised:05/07/22

Page 72 of 77

<p>⚠ ATENCIÓN</p> <p>Punta Peligrosa. Mantenga las manos alejadas.</p>		<p>⚠ CAUTION</p> <p>Pinch point hazard. Keep hands clear.</p>
--	---	---

© Perkins Manufacturing Company 800-882-5292 Label # D72496

<p>⚠ PELIGRO</p> <p>Manténgase alejado del levantador. Un golpe causaría lesiones o la muerte.</p>		<p>⚠ DANGER</p> <p>Stand clear of lift. Contact will cause injury or death.</p>
--	---	---

Reorder No. D72497

<p>⚠ ATENCIÓN</p> <p>Peligro puede ser aplastado. No se coloque debajo del contenedor cuando esté elevado.</p>		<p>⚠ CAUTION</p> <p>Crush hazard. Do not stand below container when it is elevated.</p>
--	---	---

Reorder No. D72523

<p>⚠ ATENCIÓN</p> <p>¡Peligro de colisión! No permita el cóntácto entré la cubeta de carga y el alza conténedor. ¡Se producirán daños!</p>		<p>⚠ CAUTION</p> <p>Collision hazard! Do not allow bucket and cart lifter to collide. Damage will occur!</p>
--	---	--

© Perkins Manufacturing Company 800-882-5292 Label # D73124



Protective Safety Labeling

Perkins provides each finished cart lifter with ANSI-specified caution labels. They are clearly placed directly on the machine for easy viewing by the operators.

Should the cart lifter ever be re-painted, or if the labels are damaged beyond recognition, it is advised to replace the labels immediately to help keep your crew safe.

OHSA always requires these labels to be in clear sight on the machine.

Responsibility to maintain proper caution and warning labels is the responsibility of the end-user.



You should make sure that all pressure is bled/released from the hydraulic or pneumatic system; for some systems it may be possible to work on a part of the system by using line-breaking or blanking procedures. Never loosen or tighten a hydraulic connection when the system is under pressure. The connection could fail catastrophically and cause an injection injury and/or damage to property. Inspect hoses regularly for wear then replace hoses before leaks can develop. Hydraulics systems should look clean and dry. You can typically see leaks where the machine is collecting dirt and debris that is sticking to the oil. Look for wet-looking areas that are collecting dirt. Check for abraded/scuffed hoses, loose or damaged fittings, or worn out seals, or other physical damage that may have led to creating the leak.



Perkins Manufacturing Company
Creators of the TuckAway® Cart Lifter
www.perkinsmfg.com

800-882-5292

Revised: 11/13/20

Page 48 of 50

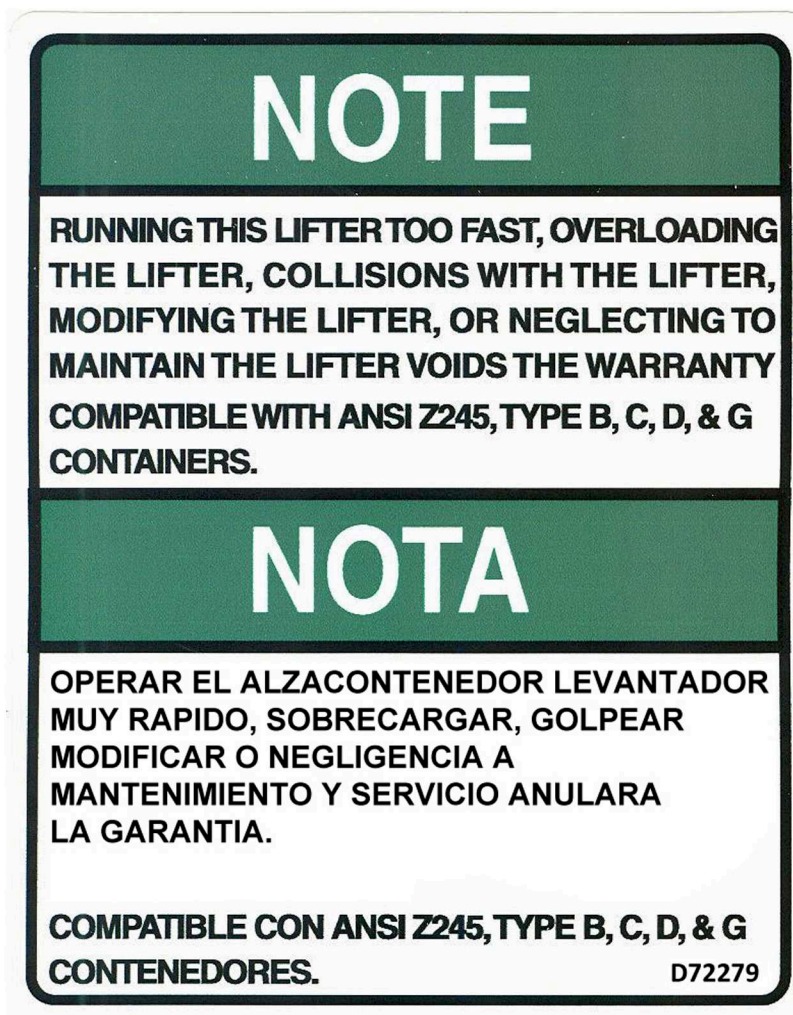

Dress appropriately for work with pants and sleeves that are not too long or too loose. Shirts should be fitted or tucked in. Avoid wearing loose and dangling jewelry. Tie back long hair and tuck braids and ponytails behind you or into your clothing. Wear the appropriate, well-fitting gloves for your job.



Look for possible pinch points before you start a task. Take the time to plan out your actions and decide on the necessary steps to work safely. Read and follow warning signs posted on equipment.

Machinery can pose a hazard with moving parts, conveyors, rollers, and rotating shafts. NEVER reach into a moving machine. Turn equipment off and use lockout/tagout procedures before adjusting, clearing a jam, repairing, or servicing a machine.



<p>! PELIGRO</p> <p>Peligro puede ser electrocutado.</p> <p>Cerciorese de la ausencia de lineas electricas antes de vaciar.</p>		<p>! DANGER</p> <p>Overhead electrocution hazard.</p> <p>Check for overhead power lines before dumping.</p>
<p>©Perkins Manufacturing Company</p>		<p>Label # D72494</p>

Use caution when using the Satellite unit for overhead or low hanging power lines. When driving be mindful of overhead or low hanging power lines for danger of electrocution. When dumping look out for powerlines as to not damage power lines. Injury or damage may occur truck and/or operator if hazards are closely monitored.

<h1>NOTICE</h1>	
<h2>Maintenance Requirements</h2>	
	<p>Read and understand manual prior to operating this equipment.</p> <p>Follow maintenance guidelines per the manual.</p> <p>Inspect machine daily prior to use and report any problems to service immediately.</p> <p>Failure to operate and maintain the unit within guidelines will void the warranty.</p>
	<p>Perkins Manufacturing Company 800-882-5292 www.perkinsmfg.com</p>

©Clarion Safety Systems, LLC clarionsafety.com 17039

Reorder No. D72499



Perkins Manufacturing Company
Creators of the TuckAway® Cart Lifter
www.perkinsmfg.com



800-882-5292

Revised:05/07/22

Page 75 of 77

	NOTICE
	Grease all zerks on a weekly basis to maintain warranty.
	Re-grease after power washing.
	Visit www.perkinsmfg.com for important updates.
Please read the manual prior to operating or adjusting this machine for important information.	
Perkins Manufacturing, Company 708 482 9500	
Label # D72163	

Maintaining the lifter is vital to ensure proper operation of the equipment and for warranty to be valid. Inspection of the lifter is also important to make sure there are no loose parts and that the lifter is properly greased. Not inspecting or maintaining the machine regularly can pose a hazard of parts coming loose, parts not moving properly or wear items to become too worn to not move properly. If any issues occur, please contact service immediately.

⚠ CAUTION	
	Pinch point hazard. Keep hands clear. Worker can be injured by moving parts.
	Skin injection hazard. Protect your hands & body from high pressure fluids. Relieve pressure before servicing. Do not check for leaks with your bare hands.
Compatible with ANSI Z245.60 type containers only.	
Cycle time must be 3-4 seconds up / 3-4 seconds down. Faster operation can cause damage and injury.	
Perkins Manufacturing, Company 708 482 9500	
Label # D72589	

⚠ ATENCIÓN	
	Punta Peligrosa. Mantenga las manos alejadas. El trabajador puede lesionarse moviendo partes.
	Riesgo de inyección cutánea. Proteja las manos y el cuerpo de líquidos en alta presión. Purgue la presión antes de realizar cualquier servicio. No busque fugas usando sus manos.
Compatible con ANSI Z245.60 solo contenedores de tipo.	
El tiempo del ciclo debe ser 3-4 segundos arriba / 3-4 segundos abajo. Una operación más rápida puede causar daños y lesiones.	
Perkins Manufacturing, Company 708 482 9500	
Label # D72590	



Safety Labeling and Training Requirements

Perkins provides safety labeling on all outgoing product per ANSI regulations, seen below.

19-01 Warning, Label and Safety Instructions.

Include standard safety instructions as one of the first items in a manual. This helps emphasize safe use of the product and can help the user understand the hazards, the consequences of the hazards and how to avoid the hazards. Priority placement also increases the likelihood that the information will be read. Any symbols or pictograms physically on the product should be included in the appropriate section of the manual to reinforce the association between the nature and severity of the hazard and the correct behavior.

The American National Standards Institute (ANSI) standard Z535.6, *Product Safety Information in Product Manuals, Instructions, and Other Collateral Materials*, should also be applied.

To help ensure the product user sees and understands warnings and safety instructions, you should make them conspicuous. It is critical that you make proper use of the signal words "*danger*", "*warning*", "*caution*" and "*notice*" and their corresponding signal colors *red*, *orange*, *yellow*, and *blue*.

Choosing the appropriate signal words and colors are based on an estimate of the likelihood of exposure to the hazardous situation and what could happen as a result of exposure to the hazard. The American National Standards Institute (ANSI) standard Z535.4, *Product Safety Signs and Labels*, defines the hazard signal words as follows:

DANGER: Indicates an imminently hazardous situation which, if not avoided, "will" result in death or serious injury. This signal word is to be limited to the most extreme situations.

WARNING: Indicates a potentially hazardous situation which, if not avoided, "could" result in death or serious injury.

CAUTION: Indicates a potentially hazardous situation, which, if not avoided, "may" result in minor or moderate injury. It may also be used to alert against unsafe practices.

NOTICE: Indicates information considered important, but not hazard related (e.g., messages relating to property damage).

It is the responsibility of owner of this product to maintain the safety labels, keep them clear & visible to all users, and replace the safety labels when they become worn or missing.

All users must read and understand this manual and the safety precautions before using this product.



Perkins Manufacturing Company
Creators of the TuckAway® Cart Lifter
www.perkinsmfg.com

800-882-5292

Revised: 08/08/23
Addendum

Manufacturing Company

Perkins Warranty Procedure

This procedure for claiming warranty must be followed or warranty will not be approved, credit will not be issued, and replacement parts will not be shipped. This document is not a replacement for the warranty policy. Please refer to the last page of your manual, which describes the warranty policy in detail.

If you believe your Perkins lifter has suffered from a failure that could be covered by warranty, immediately lock out any equipment that has failed per OSHA guidelines.

Take photographs of the lifter, including overall views of the unit and some close-ups, as necessary to properly record the failure in a way our engineering staff can examine. While taking photos of the lifter, record the serial number of the lifter.

Call Perkins at (800) 882-5292 and ask to speak to the service department. Requests for warranty can also be emailed to svaldez@perkinsmfg.com. Attach any photos to the email, as necessary. The service department will use the photos to determine if the return of parts for inspection is necessary or not. If the return of parts is required, the service department will issue you an RGA number.

Your replacement parts will be shipped at the time of your warranty request, but they will require a purchase order number/payment in order to ship. (Credit will be issued later, after warranty status is determined.) Your replacement parts will feature RGA numbers on the documentation referencing your warranty request. Replacements are sent UPS ground. For faster shipping, the customer will be charged.

Clearly mark the box of any returns with the provided RGA number in a prominent place. This helps our shippers identify your items. When your returned parts arrive, our service and engineering teams will inspect your shipment and determine if the failure is a defect covered by the warranty or not. If the item(s) are covered by warranty, credit will be issued. If the item(s) were not covered by warranty, a report will be generated that fully describes the reasoning behind the decision.

Common Warranty Mistakes:

Please do not ship lifters/parts to Perkins without first obtaining an RGA number. Parts received without prior authorization or without RGA markings will be discarded and credit will not be issued.

Orders that are placed without discussing warranty status will be treated as a typical order and will be billed accordingly. Credit will not be issued for warranty requests after the order is placed.

No warranty is allowed on lifters/parts not having a serial number.



Manufacturing Company

Perkins Return Policy:

If, within 30 days of receipt of the item(s), a customer would like to return an unused item(s), the customer may contact Perkins for a return authorization (RGA#). The item must be shipped within 2 weeks of the return authorization. The customer will pay the return freight and a 15% restocking fee on the return(s). The item must be in new / unused condition, and any damage or clean up required to restore the product to resalable condition will be charged to the customer.

Packages received without an RGA# on the packaging identifying who the product is from may be discarded or refused and credit may not be issued. Always make sure the RGA# is displayed on the box and on any included paperwork.

If Perkins shipped the wrong item(s), the incorrect item(s) may be returned within 30 days of receipt of the item by contacting Perkins for a return authorization (RGA#). The item(s) must be shipped within 2 weeks of the return authorization. Perkins will pay the return freight and waive the restocking fee.

If the return results in a net debit, the customer will be invoiced. If the return results in a net credit, the credit can be used against the replacement item(s) or a future purchase.

Special Notes:

Perkins does offer customized solutions and due to the customization of these items, Perkins cannot accept returns or refunds on anything custom ordered. This includes industrial units, cane lifters, and other items which have been specially fabricated to the customer's specifications. Unfortunately returns on these products cannot be accepted.

Perkins Manufacturing One-Year Limited Warranty

PERKINS MANUFACTURING COMPANY warrants its products to be free from defects in material and workmanship under normal use for a period of **one (1) year** from the date of delivery to the first purchaser.

Any claim under this warranty must be handled in accordance with PERKINS' warranty procedure.

This warranty is expressly limited to the repair or replacement in PERKINS' discretion of any component or part of any PERKINS product unit manufactured by PERKINS which is brought to PERKINS attention promptly after discovery and is proven to PERKINS' satisfaction to have been defective in material or workmanship.

This warranty shall not obligate PERKINS to bear the cost of labor or transportation charges in connection with the repair or replacement of defective parts, and it shall not apply to a product upon which repairs, or alterations have been made unless authorized in writing by PERKINS.

Any damage, wear & tear or improper use, substitution of parts not approved by PERKINS, modifications other than those done by PERKINS or as authorized in writing by PERKINS, or any alteration or repair by others in such a manner which, in PERKINS' judgment, materially and adversely affects the product shall void this warranty. Operation at an actuator cycle time of less than six seconds shall void this warranty. Wear items used for anti-friction purposes are not covered by this warranty.

Periodic maintenance is required in order to maintain warranty but is not covered by warranty. Please refer to the maintenance section of the service manual for instructions.

PERKINS makes no warranty of products manufactured by others and supplied by PERKINS, the same being subject to warranties, if any, of their respective manufacturers.

PERKINS shall not assume any liability for any incidental, consequential, direct, or indirect damage, loss or delay of any kind, including, but not limited to, the loss of profits, product or downtime.

PERKINS warrants any service parts it may sell for a period of ninety (90) day from the date of delivery for replacement only. The item being replaced must be returned to PERKINS for evaluation upon its request. The cost of labor to replace such part shall be the responsibility of the owner. PERKINS does not warrant any used parts.

PERKINS, whose policy is one of continuous improvement, reserves the right to improve its products through changes in design or materials as it may deem desirable without obligation to incorporate such changes in products of prior manufacture.

THE ABOVE WARRANTY SUPERCEDES AND IS IN LIEU OF ALL OTHER EXPRESS OR IMPLIED WARRANTIES INCLUDING, WITHOUT LIMITING, ANY IMPLIED WARRANTIES OF MERCHANTABILITY OR FITNESS FOR A PARTICULAR PURPOSE. NO EMPLOYEE OR ANY OTHER REPRESENTATIVE OF PERKINS IS AUTHORIZED TO CHANGE THIS WARRANTY IN ANY WAY OR TO GRANT ANY OTHER WARRANTY. THESE TERMS WILL BE CONSTRUED ACCORDING TO THE LAWS OF THE STATE OF ILLINOIS WITHOUT REGARD TO ITS CONFLICTS OF LAWS PROVISIONS. ALL ACTIONS OR PROCEEDINGS IN ANY WAY, MANNER OR RESPECT ARISING OUT OF OR RELATED TO THE GOODS WILL BE LITIGATED ONLY IN STATE OR FEDERAL COURTS, AS APPROPRIATE, LOCATED IN WILL COUNTY, ILLINOIS. BUYER CONSENTS AND SUBMITS TO JURISDICTION IN THE STATE OF ILLINOIS AND WAIVES ANY RIGHT TO TRANSFER THE VENUE OF ANY SUCH ACTION OR PROCEEDING.